

GEARBOX "JL" SERIES

Part No.	Description	Plate No.	No. per Unit	Remarks
C.7384	GEARBOX COMPLETE (STANDARD RATIO GEARS)		1	Fitted up to and including Gearbox No. JL.
C.10056	GEARBOX COMPLETE (CLOSE RATIO GEARS)		1	Fitted to Gearbox No. JL. and subs.
C.2071	GEARBOX CASE	P.1	1	
C.799	Plug, Oil Drain, at bottom of Case	P.2	1	
C.785	Washer (Fibre) on Drain Plug	P.3	1	
C.857	Plate, at rear end of Case, locking Counter and Reverse Shafts	P.4	1	
FS.205/7D	Screw, Set, securing Locking Plate	P.5	1	
FG.105/X	Washer, Spring, on Setscrews	P.6	1	
C.1845	Bearing, Ball, for Mainshaft (Hoff. MS. 12½K)	P.7	1	
C.1855	Circlip around Mainshaft Bearing	P.8	1	
C.1838	Bearing, Ball, for Constant Pinion Shaft (Hoff. 340K)	P.9	1	
C.1841	Collar, between Case and Circlip	P.10	1	
C.1840	Circlip, on Bearing, behind Collar	P.11	1	
C.920	Washer (Fibre) in Casing, at front end of Countershaft	P.12	1	
C.1833	FRONT END COVER	P.13	1	
C.1834	Gasket, between Front End Cover and Case	P.14	1	
C.6738	Seal, Oil, in Front End Cover	P.15	1	
C.359	Screw, Set, securing Front End Cover to Case	P.16	4	
FW.105/E	Washer (Copper) on Setscrews	P.17	4	
C.837	Wire, locking Setscrews (9" long)		2	
C.7671	REAR END COVER	P.18	1	
C.1866	Gasket, between Rear End Cover and Casing	P.19	1	
FS.105/9D	Screw, Set, securing Rear End Cover to Casing	P.20	7	
FG.105/X	Washer, Spring, on Setscrews	P.21	7	
C.859	Seal, Oil, in Rear End Cover	P.22	1	

GEARBOX "JL" SERIES

Part No.	Description	Plate No.	No. per Unit	Remarks
C.843	SPEEDOMETER DRIVEN GEAR IN REAR END COVER	P.23	1	
C.858	Bearing for Speedometer Driven Gear	P.24	1	
C.846	Screw, locking Bearing In Rear End Cover	P.25	1	
FG.105/X	Washer, Spring, on Screw	P.26	1	
SD.1030	GEARBOX REMOTE CONTROL ASSEMBLY (COMPRISING TOP COVER, CHANGE-SPEED LEVER, CHANGE-SPEED FORKS, SELECTORS, ETC.)		1	
C.6878	TOP COVER	P.27	1	
C.860	Gasket, between Top Cover and Gearbox Case	P.27A	1	
FB.105/15D	Bolt, securing Top Cover	P.28	2	
FB.105/14D	Bolt, securing Top Cover	P.29	2	
FB.105/12D	Bolt, securing Top Cover	P.30	6	
FG.105/X	Washer, Spring, on Bolts	P.31	10	
OD.105/6H	Dowel, positioning Top Cover to Case	P.32	2	
C.848	Plunger, engaging Striking Rods	P.33	3	
C.845	Spring, at top of Plungers	P.34	3	
C.849	Screw, Grub, applying tension to Plungers for 1st/2nd and 3rd/Top Striking Rods	P.35	2	
C.884	Screw, Grub, applying tension to Plunger for Reverse Striking Rod	P.36	1	
C.837	Wire, locking Grub Screws		As req'd	
C.873	Plug, in front end of Cover, sealing apertures for Insertion of Striking Rods	P.37	3	
C.929	Seal (Felt) in rear end of Cover, for Striking Rods	P.38	3	
C.880	Plate, covering Felt Seals	P.39	1	
FS.104/3D	Screw, Set, securing Cover Plate	P.40	2	
FG.104/X	Washer, Spring, on Setscrews	P.41	2	
C.315	Plug, Core, on top of Cover	P.42	1	
C.841	Breather on top of Cover	P.43	1	
C.930	Washer (Fibre) for Breather	P.44	1	
C.927	Screw, Grub, in side of Cover, for insertion of Interlock Balls and Roller	P.45	1	
C.2675	DIPSTICK ASSEMBLY	P.46	1	

GEARBOX "JL" SERIES

Part No.	Description	Plate No.	No. per Unit	Remarks
STRIKING GEAR				
C.907	Rod, Striking (1st/2nd Gears)	P.47	1	
C.877	Rod, Striking (3rd/Top Gears)	P.48	1	
C.7358	Rod, Striking (Reverse Gear)	P.49	1	
C.7726	Fork, Change-Speed (1st/2nd Gears)	P.50	1	
C.7725	Fork, Change-Speed (3rd/Top Gears)	P.51	1	
C.7724	Fork, Change-Speed (Reverse Gear)	P.52	1	
C.905	Selector (3rd/Top Gears)	P.53	1	
C.1910	Selector (Reverse Gear)	P.54	1	
C.1909	Plunger in Reverse Selector	P.55	1	
C.2022	Spring on Plunger	P.56	1	
L.103/7U	Pin, Split, securing Plunger in Reverse Selector	P.57	1	
C.922	Ball, locking Plunger in Reverse Selector	P.58	1	
C.900	Spring, under Ball	P.59	1	
C.914	Shim under Spring	P.60	1	
AS.102/4D	Screw, Set, under Reverse Selector, adjusting tension on Spring	P.61	1	
AN.102/L	Nut, locking Setscrew when adjusted	P.62	1	
C.882	Stop Pin on 1st/2nd and 3rd/Top Striking Rods	P.63	2	
C.874	Roller, for Interlock, in 1st/2nd Striking Rod	P.64	1	
C.923	Ball, for Interlock, in 3rd/Top and Reverse Striking Rod	P.65	2	
C.844	Screw, Set (Taper) securing Forks and Selector	P.66	5	
C.837	Wire, locking Taper Screws and Lock Pins		As req'd	
C.2462	CHANGE-SPEED LEVER	P.67	1	FITTED TO OPEN AND FIXED HEAD COUPE ONLY. NOT REQUIRED WHEN RADIO IS FITTED.
C.4054	CHANGE-SPEED LEVER		1	FITTED TO DROP HEAD COUPE. ALSO REQUIRED FOR OPEN AND FIXED HEAD COUPE WHEN RADIO IS FITTED.
C.2291	Knob for Change-Speed Lever	P.68	1	
C.1928	Nut, locking Knob to Change-Speed Lever	P.69	1	
C.1915	Bearing, Flexible, housing Change-Speed Lever in Selector Lever	P.70	2 halves	
C.1919	Washer at top of Flexible Bearing	P.71	1	
C.1904	Washer at bottom of Flexible Bearing	P.72	1	
C.1918	Lever, Selector, housing Change-Speed Lever	P.73	1	
FN.405/L	Nut, Slotted, securing Change-Speed Lever, in Selector Lever	P.74	1	
L.103/8U	Pin, Split, securing Slotted Nut	P.75	1	
C.1913	Jaw, Pivot, for Selector Lever	P.76	1	
C.1907	Bush for Pivot Jaw	P.77	1	
C.1894	Washer, Thrust, on Pivot Jaw	P.78	2	
C.1914	Washer, Locking on Pivot Jaw	P.79	1	
C.1905	Washer, Spring, on Pivot Jaw	P.80	1	
FN.407/L	Nut, Slotted, securing Pivot Jaw to Top Cover	P.81	1	
L.103/8U	Pin, Split, securing Slotted Nut	P.82	1	
C.1912	Pin, Pivot, securing Selector Lever in Pivot Jaw	P.83	1	
C.1906	Bush, In Selector Lever, for Pivot Pin	P.84	1	
C.1908	Washer, Thrust, at each side of boss on Selector Lever	P.85	2	
C.1929	Washer, Spring, between Thrust Washer and Pivot Jaw	P.86	1	
FN.407/L	Nut, Slotted, securing Pivot Pin	P.87	1	
L.103/8U	Pin, Split, securing Slotted Nut	P.88	1	

GEARBOX "JL" SERIES

Part No.	Description	Plate No.	No. per Unit	Remarks
C.885	FLANGE, ON MAINSHAFT, FOR UNIVERSAL JOINT	Q.1	1	
C.840	Nut, Slotted, securing Flange to Mainshaft	Q.2	1	
C.925	Washer, Plain, under Slotted Nut	Q.3	1	
L.104/12U	Pin, Split, securing Slotted Nut	Q.4	1	
C.4994	MAINSHAFT	Q.5	1	
C.910	Gear, Speedometer Driving	Q.6	1	
C.909	Distance Piece behind Speedometer Driving Gear	Q.7	1	
C.7480	Sleeve, Synchronising, 2nd Speed	Q.8	1	
C.900	Spring, in 2nd and 3rd/Top Synchro Sleeves	Q.9	12	
C.901	Plunger in 2nd and 3rd/Top Synchro Sleeves (.490" long)	Q.10	3	} SELECTIVE SIZES. Choose the Plunger of the desired length.
C.901/1	Plunger in 2nd and 3rd/Top Synchro Sleeves (.495" long)	Q.10	3	
C.901/2	Plunger in 2nd and 3rd/Top Synchro Sleeves (.500" long)	Q.10	3	
C.922	Ball, in 2nd and 3rd/Top Synchro Sleeves at top of Springs and Plungers	Q.11	15	
C.2040	Gear, 1st Speed	Q.12	1	
C.4125	Gear, 2nd Speed	Q.13	1	
C.4123	Gear, 3rd Speed	Q.14	1	
C.1850	Roller, Needle, in 2nd and 3rd Speed Gears	Q.15	82	
C.1849	Plunger in Mainshaft, locking 2nd and 3rd Speed Gears	Q.16	2	
C.1324	Spring, under Plungers	Q.17	2	
C.2678/1	Washer, Thrust, front and rear of 2nd and 3rd Speed Gears (.471"/.472" thick)	Q.18	2	} SELECTIVE SIZES. Choose the Washer of the desired thickness.
C.2678/2	Washer, Thrust, front and rear of 2nd and 3rd Speed Gears (.473"/.474" thick)	Q.18	2	
C.2678/3	Washer, Thrust, front and rear of 2nd and 3rd Speed Gears (.475"/.476" thick)	Q.18	2	
C.4122	Sleeve, Synchronising, 3rd/Top Speeds	Q.19	1	
C.4049	Sleeve, Operating, 3rd/Top Speeds	Q.20	1	
C.903	Shim for Synchro Sleeve (.006" thick)	Q.21	As req'd	
C.914	Shim for Synchro Sleeve (.028" thick)	Q.21	As req'd	
C.6751	CONSTANT PINION ASSEMBLY (STANDARD RATIO GEARS)	Q.22	1	
C.9252	CONSTANT PINION ASSEMBLY (CLOSE RATIO GEARS)		1	
C.1843	Bearing, Roller, inside Shaft	Q.23	1	
C.2121	Thrower, Oil	Q.24	1	
C.1838/1	Circlip, retaining Ball Bearing on Constant Pinion Shaft	Q.25	1	
C.2109	Washer for Constant Pinion	Q.26	1	
C.2110	Shim for Constant Pinion	Q.27	As req'd	
C.2111	Shim for Constant Pinion	Q.28	As req'd	

Part No.	Description	Plate No.	No. per Unit	Remarks
C.2044/2	REVERSE GEAR ASSEMBLY	Q.29	1	
C.2070	Spindle for Reverse Gear	Q.30	1	
C.1893	Lever, operating Reverse Gear	Q.31	1	
C.1899	Pin, Fulcrum, for Operating Lever	Q.32	1	
C.777	Nut, Slotted, securing Fulcrum Pin	Q.33	1	
FW.106/T	Washer, Plain, under Slotted Nut	Q.34	1	
L.103/8U	Pin, Split, securing Slotted Nut and Reverse Slipper	Q.35	2	
C.866	Slipper, Reverse	Q.36	1	
C.4284	Ring, Sealing, on Reverse Spindle	Q.37	1	
C.1856	COUNTERSHAFT	Q.38	1	
C.2041	Gear, 1st Speed (on Counter)	Q.39	1	
C.1864	Ring, Retaining, at rear of Needle Rollers	Q.40	2	
C.918	Roller, Needle, inside each end of Countershaft	Q.41	58	
C.1861	Washer, Thrust, Inner, at rear end of Counter, adjacent to Needle Rollers	Q.42	1	
C.1862	Washer, Thrust, Outer, at rear of Counter (.156" thick)	Q.43	1	} SELECTIVE SIZES. Choose Washer of desired thickness
C.1862/1	Washer, Thrust, Outer, at rear of Counter (.159" thick)	Q.43	1	
C.1862/2	Washer, Thrust, Outer, at rear of Counter (.162" thick)	Q.43	1	
C.1862/3	Washer, Thrust, Outer, at rear of Counter (.152" thick)	Q.43	1	
C.1862/4	Washer, Thrust, Outer, at rear of Counter (.164" thick)	Q.43	1	
C.2043	Ring, Retaining, at outer end of Front Needle Rollers	Q.44	1	
C.2042	Washer, Thrust, Inner, at front end of Counter	Q.45	1	Fitted up to and including Gearbox No. JL.28701.
C.8835	Washer, Thrust, Inner, at front end of Counter	Q.45	1	Fitted to Gearbox No. JL.28702 and subs.
C.1859	Washer, Thrust, Outer, at front end of Counter	Q.46	1	
C.2045	Constant Wheel (Standard Ratio)	Q.47	1	Fitted up to and including Gearbox No. JL.
C.5826	Constant Wheel (Close Ratio)		1	Fitted to Gearbox No. JL. and subs.
C.2046	Gear, 3rd Speed, on Countershaft	Q.48	1	
C.2047	Gear, 2nd Speed, on Countershaft	Q.49	1	
C.2048	Ring, Split, locating Constant Wheel	Q.50	2 halves	
C.2072	Circlip, positioning 3rd Speed Gear and Constant Wheel	Q.51	2	
C.4285	Ring, Sealing, on Countershaft	Q.52	1	

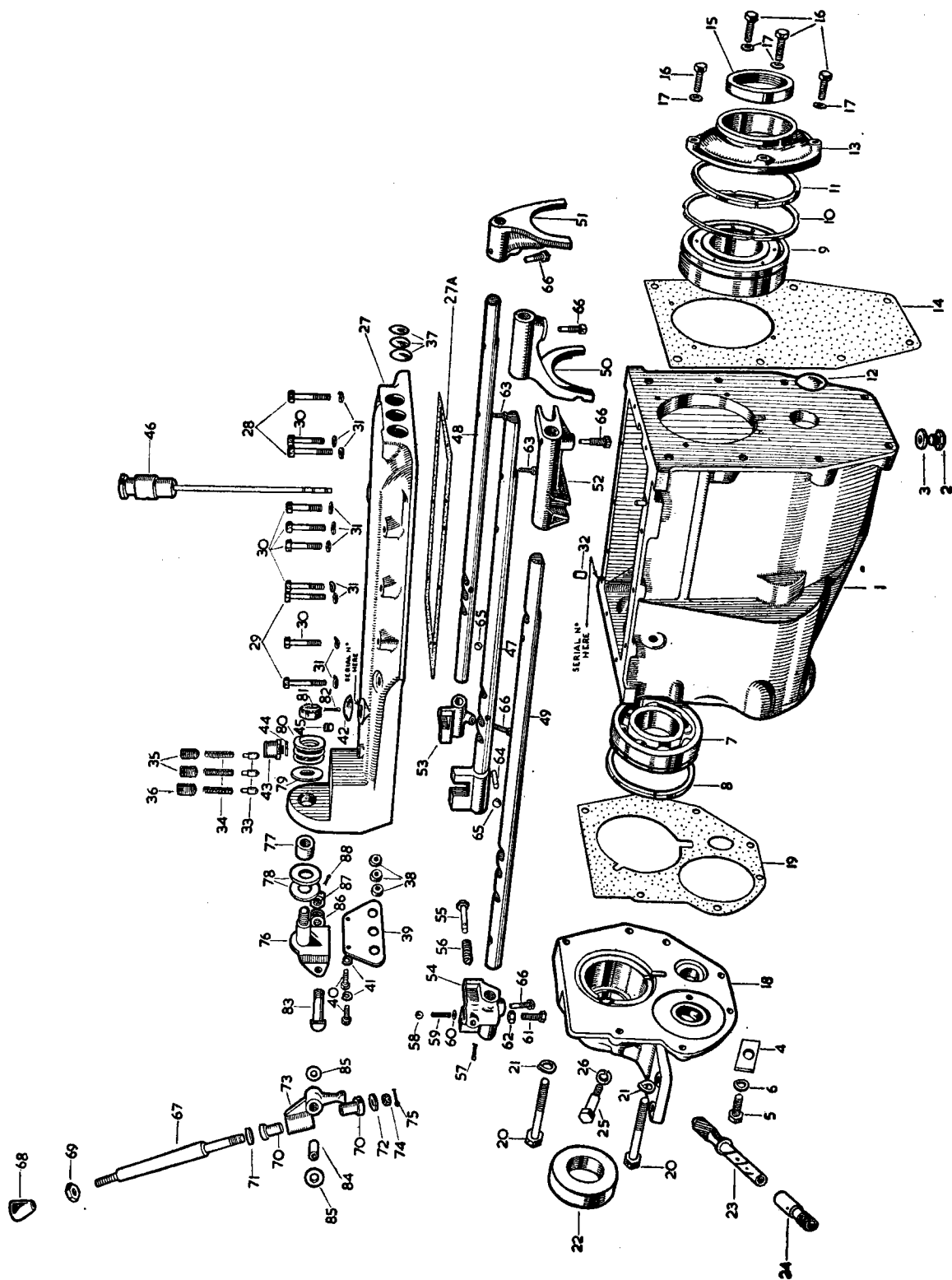

PLATE P

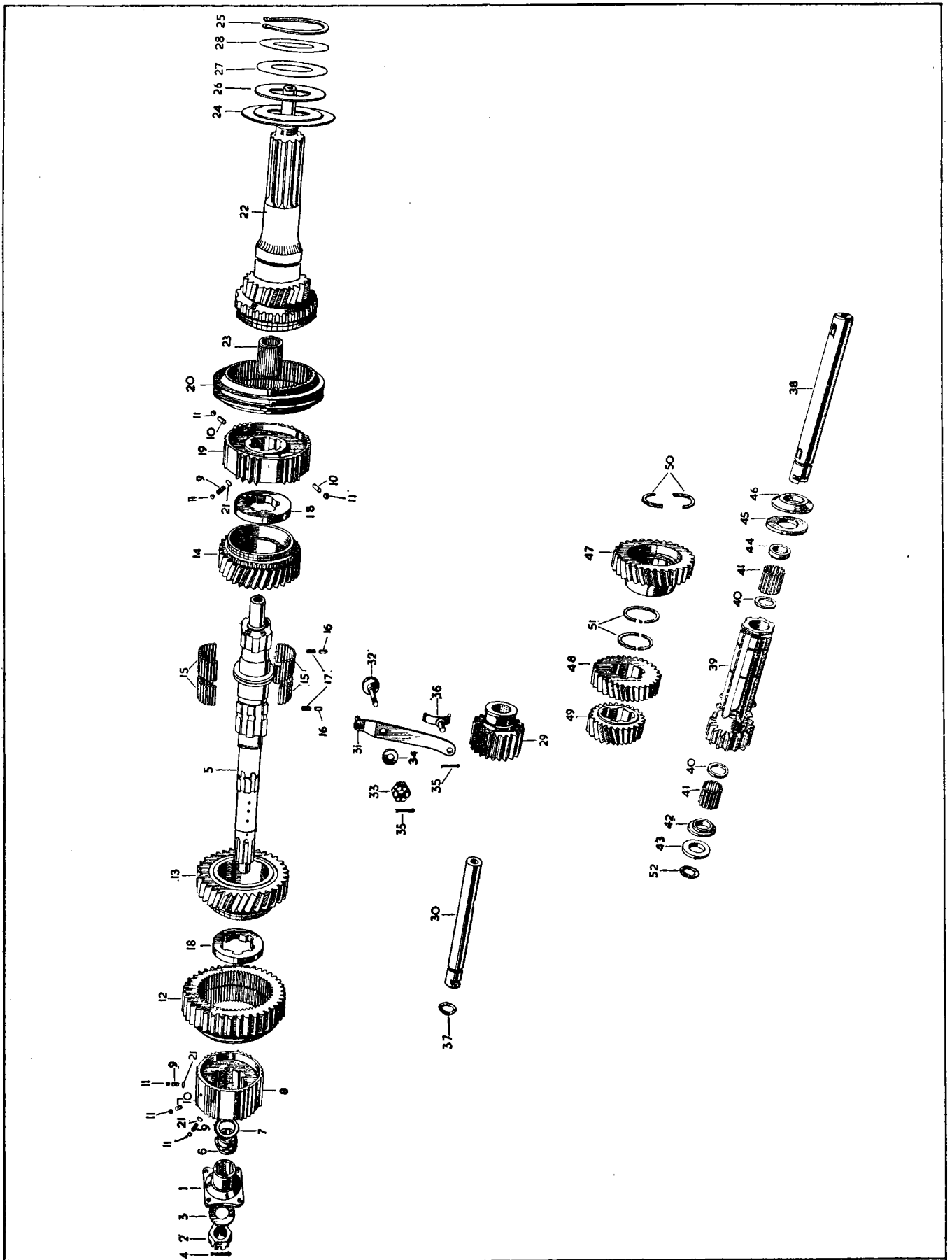

PLATE Q

GEARBOX "SL" SERIES

Part No.	Description	Plate No.	No. per Unit	Remarks
C.9250	GEARBOX COMPLETE (STANDARD RATIO GEARS)		1	Fitted up to and including Gearbox No SL.
C.10846	GEARBOX COMPLETE (CLOSE RATIO GEARS)		1	Fitted to Gearbox No. SL. and subs.
C.2071	GEARBOX CASE	PP.1	1	
C.799	Plug , Oil Drain, at bottom of Case	PP.2	1	
C.785	Washer (Fibre) on Drain Plug	PP.3	1	
C.857	Plate , at rear end of Case, locking Counter and Reverse Shafts	PP.4	1	
FS.205/7D	Screw , Set, securing Locking Plate	PP.5	1	
FG.105/X	Washer , Spring, on Setscrew	PP.6	1	
C.1845	Bearing , Ball, for Mainshaft (Hoff. MS. 12½K)	PP.7	1	
C.1855	Circlip , around Mainshaft Bearing	PP.8	1	
C.1838	Bearing , Ball, for Constant Pinion Shaft (Hoff. 340K)	PP.9	1	
C.1841	Collar , between Case and Circlip	PP.10	1	
C.1840	Circlip , on Bearing, behind Collar	PP.11	1	
C.920	Washer (Fibre) in Casing, at front end of Countershaft	PP.12	1	
C.1833	FRONT END COVER	PP.13	1	
C.1834	Gasket , between Front End Cover and case	PP.14	1	
C.6738	Seal , Oil, in Front End Cover	PP.15	1	
C.1835	Screw , Set, securing Front End Cover to Case	PP.16	4	
FW.105/E	Washer (Copper) on Setscrews	PP.17	4	
C.837	Wire , locking Setscrews (9" long)		2	
C.7671	REAR END COVER	PP.18	1	
C.1866	Gasket , between Rear End Cover and Casing	PP.19	1	
FS.105/9D	Screw , Set, securing Rear End Cover to Casing	PP.20	7	
FG.105/X	Washer , Spring, on Setscrews	PP.21	7	
C.859	Seal , Oil, in Rear End Cover	PP.22	1	

GEARBOX "SL" SERIES

Part No.	Description	Plate No.	No. per Unit	Remarks
C.843	SPEEDOMETER DRIVEN GEAR IN REAR END COVER	PP.23	1	
C.858	Bearing, for Speedometer Driven Gear	PP.24	1	
C.846	Screw, locking Bearing in Rear End Cover	PP.25	1	
FG.105/X	Washer, Spring, on Screw	PP.26	1	
SD.1030	GEARBOX REMOTE CONTROL ASSEMBLY (COMPRISING TOP COVER, CHANGE-SPEED LEVER, CHANGE-SPEED FORKS, SELECTORS, ETC.)		1	
C.6878	TOP COVER	PP.27	1	
C.860	Gasket, between Top Cover and Gearbox Case	PP.27A	1	
FB.105/15D	Bolt, securing Top Cover	PP.28	2	
FB.105/14D	Bolt, securing Top Cover	PP.29	2	
FB.105/12D	Bolt, securing Top Cover	PP.30	6	
FG.105/X	Washer, Spring, on Bolts	PP.31	10	
OD.105/6H	Dowel, positioning Top Cover to Case	PP.32	2	
C.848	Plunger, engaging Striking Rods	PP.33	3	
C.845	Spring, at top of Plungers	PP.34	3	
C.849	Screw, Grub, applying tension to Plungers for 1st/2nd and 3rd/Top Striking Rods	PP.35	2	
C.884	Screw, Grub, applying tension to Plunger for Reverse Striking Rod	PP.36	1	
C.837	Wire, locking Grub Screws		As req'd	
C.873	Plug, in front end of Cover, sealing apertures for insertion of Striking Rods	PP.37	3	
C.929	Seal (Felt) in rear end of Cover for Striking Rods	PP.38	3	
C.880	Plate, covering Felt Seals	PP.39	1	
FS.104/3D	Screw, Set, securing Cover Plate	PP.40	2	
FG.104/X	Washer, Spring, on Setscrews	PP.41	2	
C.315	Plug, Core, on top of Cover	PP.42	1	
C.841	Breather on top of Cover	PP.43	1	
C.930	Washer (Fibre) for Breather	PP.44	1	
C.927	Screw, Grub, in side of Cover, for insertion of Interlock Balls and Roller	PP.45	1	
C.2675	DIPSTICK ASSEMBLY	PP.46	1	

Part No.	Description	Plate No.	No. per Unit	Remarks
STRIKING GEAR				
C.907	Rod, Striking (1st/2nd Gears)	PP.47	1	
C.877	Rod, Striking (3rd/Top Gears)	PP.48	1	
C.7358	Rod, Striking (Reverse Gear)	PP.49	1	
C.7726	Fork, Change-Speed (1st/2nd Gears)	PP.50	1	
C.7725	Fork, Change-Speed (3rd/Top Gears)	PP.51	1	
C.7724	Fork, Change-Speed (Reverse Gear)	PP.52	1	
C.905	Selector (3rd/Top Gears)	PP.53	1	
C.1910	Selector (Reverse Gear)	PP.54	1	
C.1909	Plunger in Reverse Selector	PP.55	1	
C.2022	Spring, on Plunger	PP.56	1	
L.103/7U	Pin, Split, securing Plunger in Reverse Selector	PP.57	1	
C.922	Ball, locking Plunger in Reverse Selector	PP.58	1	
C.900	Spring under Ball	PP.59	1	
C.914	Shim under Spring	PP.60	1	
AS.102/4D	Screw, Set, under Reverse Selector, adjusting tension on Spring	PP.61	1	
AN.102/L	Nut, locking Setscrew when adjusted	PP.62	1	
C.882	Stop-Pin, on 1st/2nd and 3rd/Top Striking Rods	PP.63	2	
C.874	Roller, for Interlock, in 1st/2nd Striking Rod	PP.64	1	
C.923	Ball, for Interlock, in 3rd/Top and Reverse Striking Rod	PP.65	2	
C.844	Screw, Set (Taper) securing Forks and Selectors	PP.66	5	
C.837	Wire, locking Taper Screws and Lock Pins			As req'd
C.2462	CHANGE-SPEED LEVER	PP.67	1	FITTED TO OPEN AND FIXED HEAD COUPE ONLY. NOT REQUIRED WHEN RADIO IS FITTED.
C.4054	CHANGE-SPEED LEVER		1	FITTED TO DROP HEAD COUPE. ALSO REQUIRED FOR OPEN AND FIXED HEAD COUPE WHEN RADIO IS FITTED.
C.2291	Knob for Change-Speed Lever	PP.68	1	
C.1928	Nut, locking Knob to Change-Speed Lever	PP.69	1	
C.1915	Bearing, Flexible, housing Change-Speed Lever in Selector Lever	PP.70	2 halves	
C.1919	Washer at top of Flexible Bearing	PP.71	1	
C.1904	Washer at bottom of Flexible Bearing	PP.72	1	
C.1918	Lever, Selector, housing Change-Speed Lever	PP.73	1	
FN.405/L	Nut, Slotted, securing Change-Speed Lever in Selector Lever	PP.74	1	
L.103/8U	Pin, Split, securing Slotted Nut	PP.75	1	
C.1913	Jaw, Pivot, for Selector Lever	PP.76	1	
C.1907	Bush for Pivot Jaw	PP.77	1	
C.1894	Washer, Thrust, on Pivot Jaw	PP.78	2	
C.1914	Washer, Locking, on Pivot Jaw	PP.79	1	
C.1905	Washer, Spring, on Pivot Jaw	PP.80	1	
FN.407/L	Nut, Slotted, securing Pivot Jaw to Top Cover	PP.81	1	
L.103/8U	Pin, Split, securing Slotted Nut	PP.82	1	
C.1912	Pin, Pivot, securing Selector Lever in Pivot Jaw	PP.83	1	
C.1906	Bush, in Selector Lever, for Pivot Pin	PP.84	1	
C.1908	Washer, Thrust, at each side of boss on Selector Lever	PP.85	2	
C.1929	Washer, Spring, between Thrust Washer and Pivot Jaw	PP.86	1	
FN.407/L	Nut, Slotted, securing Pivot Pin	PP.87	1	
L.103/8U	Pin, Split, securing Slotted Nut	PP.88	1	

GEARBOX "SL" SERIES

Part No.	Description	Plate No.	No. per Unit	Remarks
C.885	FLANGE, ON MAINSHAFT, FOR UNIVERSAL JOINT	QQ.1	1	
C.840	Nut, Slotted, securing Flange to Mainshaft	QQ.2	1	
C.925	Washer, Plain, under Slotted Nut	QQ.3	1	
L.104/12U	Pin, Split, securing Slotted Nut	QQ.4	1	
C.4993	MAINSHAFT	QQ.5	1	
C.910	Gear, Speedometer Driving	QQ.6	1	
C.909	Distance Piece behind Speedometer Driving Gear	QQ.7	1	
C.7479	Sleeve, Synchronising, 2nd Speed	QQ.8	1	
C.900	Spring, in 2nd and 3rd/Top Synchro Sleeves	QQ.9	12	
C.901	Plunger in 2nd and 3rd/Top Synchro Sleeves (.490" long)	QQ.10	3	} SELECTIVE SIZES. Choose the Plunger of the desired thickness.
C.901/1	Plunger in 2nd and 3rd/Top Synchro Sleeves (.495" long)	QQ.10	3	
C.901/2	Plunger in 2nd and 3rd/Top Synchro Sleeves (.500" long)	QQ.10	3	
C.922	Ball, in 2nd and 3rd/Top Synchro at top of Springs and Plungers	QQ.11	15	
C.1897	Gear, 1st Speed	QQ.12	1	
C.4118	Gear, 2nd Speed	QQ.13	1	
C.4117	Gear, 3rd Speed	QQ.14	1	
C.1850	Roller, Needle, in 2nd and 3rd Speed Gears	QQ.15	82	
C.1849	Plunger, in Mainshaft, locking 2nd and 3rd Speed Gears	QQ.16	2	
C.1324	Spring under Plungers	QQ.17	2	
C.1847/1	Washer, Thrust, front and rear of 2nd and 3rd Speed Gears (.471"/.472" thick)	QQ.18	2	} SELECTIVE SIZES. Choose the Washer of the desired thickness.
C.1847/2	Washer, Thrust, front and rear of 2nd and 3rd Speed Gears (.473"/.474" thick)	QQ.18	2	
C.1847/3	Washer, Thrust, front and rear of 2nd and 3rd Speed Gears (.475"/.476" thick)	QQ.18	2	
C.4116	Sleeve, Synchronising, 3rd/Top Speeds	QQ.19	1	
C.4049	Sleeve, Operating 3rd/Top Speeds	QQ.20	1	
C.903	Shim, for Synchro Sleeve (.006" thick)	QQ.21	As req'd	
C.914	Shim, for Synchro Sleeve (.028" thick)	QQ.21	As req'd	
C.4114	CONSTANT PINION SHAFT ASSEMBLY	QQ.22	1	
C.1843	Bearing, Roller, inside Shaft	QQ.23	1	
C.1836	Constant Pinion (STANDARD RATIO)	QQ.24	1	Fitted up to and including Gearbox No. SL.
C.8912	Constant Pinion (CLOSE RATIO)		1	Fitted to Gearbox No. SL. and subs.
C.1842	Thrower, Oil	QQ.25	1	
C.1838/1	Circlip, retaining Ball Bearing on Constant Pinion Shaft	QQ.26	1	
C.2109	Washer for Constant Pinion	QQ.27	1	
C.2110	Shim for Constant Pinion	QQ.28	As req'd	
C.2111	Shim for Constant Pinion	QQ.29	As req'd	

GEARBOX "SL" SERIES

Part No.	Description	Plate No.	No. per Unit	Remarks
C.2068/2	REVERSE GEAR ASSEMBLY	QQ.30	1	
C.2070	Spindle for Reverse Gear	QQ.31	1	
C.1893	Lever , operating Reverse Gear	QQ.32	1	
C.1899	Pin , Fulcrum, for Operating Lever	QQ.33	1	
C.777	Nut , Slotted, securing Fulcrum Pin	QQ.34	1	
FW.106/T	Washer , Plain, under Slotted Nut	QQ.35	1	
L.103/8U	Pin , Split, securing Slotted Nut and Reverse Slipper	QQ.36	2	
C.866	Slipper , Reverse	QQ.37	1	
C.4284	Ring , Sealing, on Reverse Spindle	QQ.38	1	
C.1856	COUNTERSHAFT	QQ.39	1	
C.1857	Gear-Unit (Cluster) (STANDARD RATIO)	QQ.40	1	Fitted up to and including Gearbox No. SL.
C.8913	Gear-Unit (Cluster) (CLOSE RATIO)		1	Fitted to Gearbox No. SL. and subs.
C.918	Roller , Needle, inside Gear Unit	QQ.41	58	
C.1864	Ring , retaining Needle Rollers	QQ.42	3	
C.1858	Washer , Thrust, Inner, at front of Countershaft	QQ.43	1	
C.1859	Washer , Thrust, Outer, at front of Countershaft	QQ.44	1	
C.1861	Washer , Thrust, Inner, at rear end of Counter, adjacent to Needle Rollers	QQ.45	1	
C.1862	Washer , Thrust, Outer, at rear of Counter (.156" thick)	QQ.46	1	} To eliminate end float on Countershaft, select Washer which has the desired thickness.
C.1862/1	Washer , Thrust, Outer, at rear of Counter (.159" thick)	QQ.46	1	
C.1862/2	Washer , Thrust, Outer, at rear of Counter (.162" thick)	QQ.46	1	
C.1862/3	Washer , Thrust, Outer, at rear of Counter (.152" thick)	QQ.46	1	
C.1862/4	Washer , Thrust, Outer, at rear of Counter (.164" thick)	QQ.46	1	
C.4285	Ring , Sealing (Cord) on Countershaft	QQ.47	1	

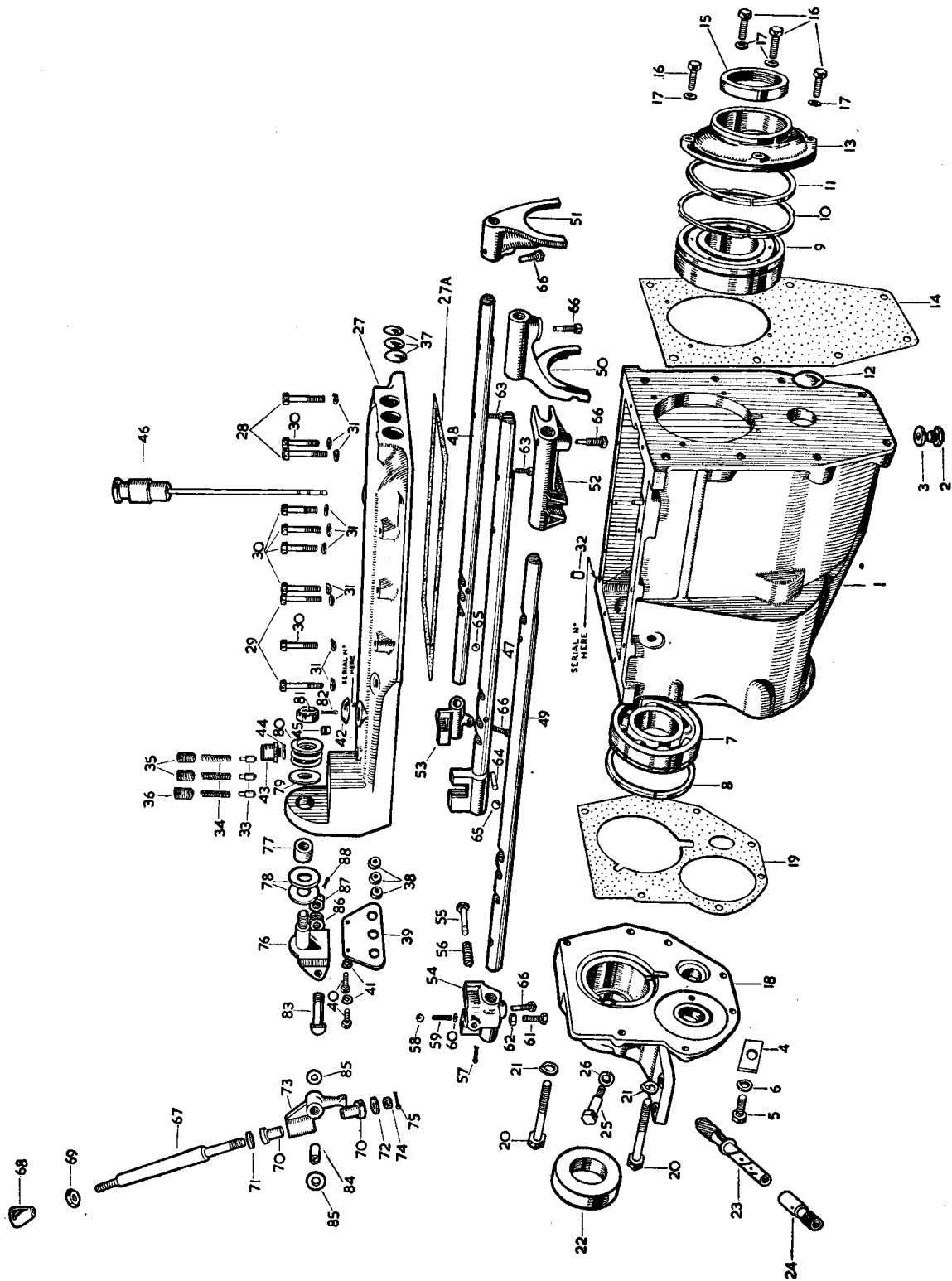

PLATE PP

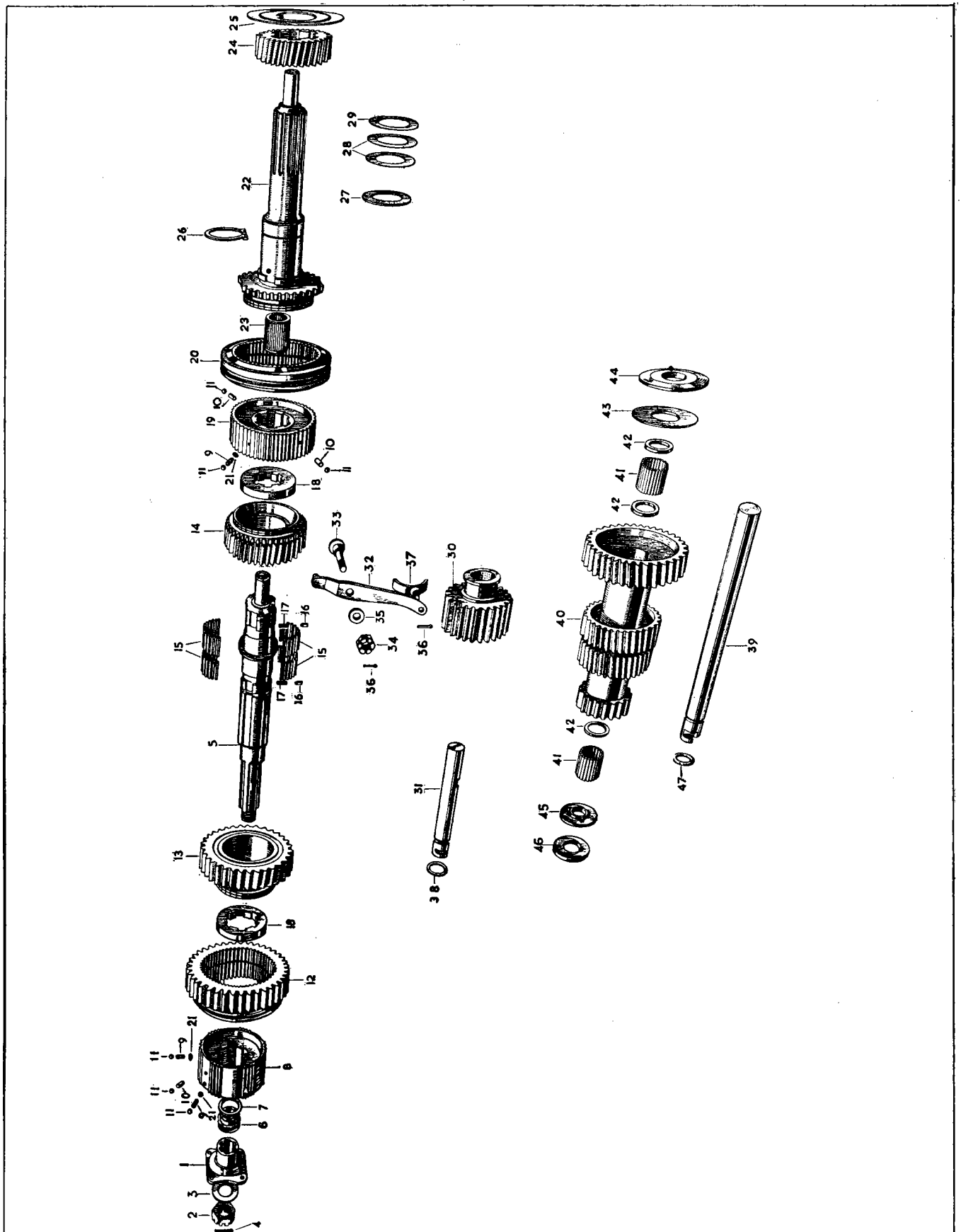

PLATE QQ

GEARBOX "JLE" SERIES FOR USE WITH OVERDRIVE UNIT

Part No.	Description	Plate No.	No. per Unit	Remarks
C.7361	GEARBOX COMPLETE ("JLE" SERIES)		1	
C.2071	GEARBOX CASE	R.1	1	
C.799	Plug, Oil Drain, at bottom of Casing	R.2	1	
C.785	Washer (Fibre) on Drain Plug	R.3	1	
C.857	Plate, locking Counter and Reverse Shafts	R.4	1	
FS.205/5D	Screw, Set, securing Locking Plate	R.5	1	
FG.105/X	Washer, Spring, on Setscrews	R.6	1	
C.1845	Bearing, Ball, for Mainshaft (MS. 12½K)	R.7	1	
C.1855	Circlip, securing Mainshaft Bearing	R.8	1	
C.8458/1	Shim, for Mainshaft Bearing (.002" thick)	R.8A	As req'd	} SELECTIVE SIZES. CHOOSE SHIM OF DESIRED THICKNESS.
C.8458/2	Shim, for Mainshaft Bearing (.003" thick)	R.8A	As req'd	
C.8458/3	Shim, for Mainshaft Bearing (.004" thick)	R.8A	As req'd	
C.1838	Bearing, Ball, for Constant Pinion Shaft (Hoff. 340K)	R.9	1	
C.1841	Collar between Casing and Circlip	R.10	1	
C.1840	Circlip, on Bearing, behind Collar	R.11	1	
C.920	Washer (Fibre) in Casing, at front end of Countershaft	R.12	1	
C.1833	FRONT END COVER	R.13	1	
C.1834	Gasket, between Front Cover and Case	R.14	1	
C.6738	Seal, Oil, in Front End Cover	R.15	1	
C.359	Screw, Set, securing Cover to Case	R.16	4	
FW.105/E	Washer (Copper) on Setscrews	R.17	4	
C.837	Wire, locking Setscrews (18 s.w.g. x 9" long)		1	
C.1866	Gasket, between Gearbox Case and Overdrive Extension	R.18	1	
FS.105/8D	Screw, Set, securing Overdrive Unit to Gearbox	R.19	7	
FG.105/X	Washer, Spring, on Setscrews	R.20	7	
STRIKING GEAR				
C.907	Rod, Striking, 1st/2nd Gears	R.21	1	
C.6879	Rod, Striking, 3rd/Top Gears	R.22	1	
C.7358	Rod, Striking, Reverse Gear	R.23	1	
C.6849	Fork, Change-Speed, 1st/2nd Gears	R.24	1	
C.6848	Fork, Change-Speed, 3rd/Top Gears	R.25	1	
C.6850	Fork, Change-Speed, Reverse Gear	R.26	1	
C.7639	Selector, 3rd/Top Gears	R.27	1	
C.1910	Selector, Reverse Gear	R.28	1	
C.1909	Plunger, in Reverse Selector	R.29	1	
C.2022	Spring, for Plunger	R.30	1	
AS.102/4D	Screw, Set, in Reverse Selector, adjusting Tension on Spring	R.31	1	
AN.102/L	Nut, locking, Setscrew in position	R.32	1	
L.103/7U	Pin, Split, securing Plunger in Reverse Selector	R.33	1	
C.922	Ball, locking Plunger	R.34	1	

GEARBOX "JLE" SERIES FOR USE WITH OVERDRIVE UNIT

Part No.	Description	Plate No.	No. per Unit	Remarks
STRICKING GEAR (continued)				
C.900	Spring under Ball	R.35	1	
C.914	Shim under Spring	R.36	As req'd	
C.882	Pin, Stop, on 1st/2nd and 3rd/Top Striking Rods	R.37	2	
C.874	Roller for Interlock (in 1st/2nd Striking Rod)	R.38	1	
C.923	Ball for Interlock (in 3rd/Top and Reverse Striking Rods)	R.39	2	
C.844	Screw, Set (Taper) securing Forks and Selectors	R.40	5	
C.837	Wire, locking Taper Screws and Stop Pins		As req'd	
SD.1031	REMOTE CONTROL COMPLETE		1	
	(COMPRISING TOP COVER, STRICKING RODS, FORKS, SELECTORS, CHANGE-SPEED LEVERS, ETC.)			
C.6878	TOP COVER	R.41	1	
C.1083	Switch, for Top Cover, operating Reversing Light and Top Gear for Overdrive Unit	R.41A	2	
C.4531	Gasket for Switches	R.41B	2	
C.6851	Packing between Top Cover and Gearbox Case	R.42	1	
C.860	Gasket at each side of Packing	R.43	2	
FB.105/24D	Bolt, securing Cover	R.44	2	
FB.105/23D	Bolt, securing Cover	R.45	2	
FB.105/21D	Bolt, securing Cover	R.46	6	
FG.105/X	Washer, Spring, on Bolts	R.47	10	
OD.105/14H	Dowel, positioning Top Cover to Casing	R.48	2	
C.848	Plunger, engaging Striking Rods	R.49	3	
C.845	Spring at top of Plungers	R.50	3	
C.849	Screw, Grub, applying tension to Plungers for 1st/2nd and 3rd/Top Striking Rods	R.51	2	
C.884	Screw, Grub, applying tension to Plunger for Reverse Striking Rod	R.52	1	
C.837	Wire, locking Grub Screws		As req'd	
C.873	Plug in front end of Top Cover	R.53	3	
C.929	Washer (Felt) in rear end of Top Cover	R.54	3	
C.880	Plate, retaining Felt Washers	R.55	1	
FS.104/3D	Screw, Set, securing Retaining Plate	R.56	2	
FG.104/X	Washer, Spring, on Setscrews	R.57	2	
C.315	Plug, Core, on top of Cover	R.58	1	
C.6853	Dipstick Assembly	R.59	1	
C.841	Breather, at top of Cover	R.60	1	
C.930	Washer (Fibre) for Breather	R.61	1	
C.927	Screw, Grub, in side of Cover, for insertion of Interlock Balls and Roller	R.62	1	
C.2462	CHANGE-SPEED LEVER		1	FITTED TO OPEN AND FIXED HEAD COUPE ONLY. NOT REQUIRED WHEN RADIO IS FITTED.

GEARBOX "JLE" SERIES FOR USE WITH OVERDRIVE UNIT

Part No.	Description	Plate No.	No. per Unit	Remarks
C.4054	CHANGE-SPEED LEVER			FITTED TO DROP HEAD COUPE ALSO REQUIRED FOR OPEN AND FIXED HEAD COUPE WHEN RADIO IS FITTED.
C.2291	Knob for Lever	R.64	1	
C.1928	Nut, locking Knob to Lever	R.65	1	
C.1915	Bearing, Flexible, housing Change-Speed Lever in Selector Lever	R.66	2 halves	
C.1919	Washer at top of Flexible Bearing	R.67	1	
C.1904	Washer at bottom of Flexible Bearing	R.68	1	
C.1918	Lever, Selector, housing Change-Speed Lever	R.69	1	
FN.405/L	Nut, Slotted, securing Change-Speed Lever in Selector Lever	R.70	1	
L.103/8U	Pin, Split, securing Slotted Nut	R.71	1	
C.1913	Jaw, Pivot, for Selector Lever	R.72	1	
C.1907	Bush for Pivot Jaw	R.73	1	
C.1894	Washer, Thrust, on Pivot Jaw	R.74	2	
C.1914	Washer, Locking, on Pivot Jaw	R.75	1	
C.1905	Washer, Spring, on Pivot Jaw	R.76	1	
FN.407/L	Nut, Slotted, securing Pivot Jaw	R.77	1	
L.103/8U	Pin, Split, securing Slotted Nut	R.78	1	
C.1912	Pin, Pivot, mounting Selector Lever in Pivot Jaw	R.79	1	
C.1906	Bush, in Selector Lever, for Pivot Jaw	R.80	1	
C.1908	Washer, Thrust, at each side of Selector Lever	R.81	2	
C.1929	Washer, Spring, between Thrust Washer and Pivot Jaw	R.82	1	
FN.407/L	Nut, Slotted, securing Pivot Pin	R.83	1	
L.103/8U	Pin, Split, securing Slotted Nut	R.84	1	
C.6830	MAINSHAFT	S.1	1	
C.7480	Sleeve, Synchronising, 2nd Speed	S.2	1	
C.900	Spring, in 2nd and 3rd/Top Synchro Sleeves	S.3	12	
C.922	Ball, at top of Springs and Plunger in 2nd and 3rd/Top Synchro Sleeves	S.4	13	
C.901	Plunger in 2nd Speed Synchro Sleeve (.490" long)	S.5	1	} SELECTIVE SIZES. CHOOSE PLUNGER OF DESIRED LENGTH.
C.901/1	Plunger in 2nd Speed Synchro Sleeve (.495" long)	S.5	1	
C.901/2	Plunger in 2nd Speed Synchro Sleeve (.500" long)	S.5	1	
C.2040	Gear, 1st Speed Mainshaft	S.6	1	
C.4125	Gear, 2nd Speed Mainshaft	S.7	1	
C.4123	Gear, 3rd Speed Mainshaft	S.8	1	
C.1850	Roller, Needle, in 2nd and 3rd Speed Gears	S.9	82	
C.1849	Plunger, in Mainshaft, locking 2nd and 3rd Speed Gears	S.10	2	
C.1324	Spring under Plungers	S.11	2	
C.2678/1	Washer, Thrust, front and rear of 2nd and 3rd Speed Gears (.471"/.472" thick)	S.12	2	} SELECTIVE SIZES. CHOOSE WASHER OF DESIRED THICKNESS.
C.2678/2	Washer, Thrust, front and rear of 2nd and 3rd Speed Gears (.473"/.474" thick)	S.12	2	
C.2678/3	Washer, Thrust, front and rear of 2nd and 3rd Speed Gears (.475"/.476" thick)	S.12	2	
C.4122	Sleeve, Synchronising, 3rd/Top Speeds	S.13	1	
C.901	Plunger in 3rd/Top Synchro Sleeve (.490" long)	S.14	2	} SELECTIVE SIZES. CHOOSE PLUNGER OF DESIRED LENGTH.
C.901/1	Plunger in 3rd/Top Synchro Sleeve (.495" long)	S.14	2	
C.901/2	Plunger in 3rd/Top Synchro Sleeve (.500" long)	S.14	2	
C.922	Ball at top of Plungers in 3rd/Top Synchro Sleeve	S.15	2	
C.4049	Sleeve, Operating, 3rd/Top Speeds	S.16	1	
C.903	Shim under Springs in Synchro Sleeves (.006" thick)	S.17	As req'd	} OPTIONAL THICKNESSES.
C.914	Shim under Springs in Synchro Sleeves (.028" thick)	S.17	As req'd	

GEARBOX "JLE" SERIES FOR USE WITH OVERDRIVE UNIT

Part No.	Description	Plate No.	No. per Unit	Remarks
C.6751	CONSTANT PINION SHAFT ASSEMBLY	S.18	1	
C.1843	Bearing, Roller, inside Constant Pinion Shaft	S.19	1	
C.2121	Thrower, Oil, on Constant Pinion Shaft	S.20	1	
C.1838/1	Circlip, for Constant Pinion	S.21	1	
C.2109	Washer for Constant Pinion	S.22	1	
C.2110	Shim for Constant Pinion	S.23	As req'd	
C.2111	Shim for Constant Pinion	S.24	As req'd	
C.2070	REVERSE SPINDLE	S.25	1	
C.2044/2	Gear, Reverse (complete with Bush)	S.26	1	
C.1893	Lever, operating Reverse Gear	S.27	1	
C.1899	Pin, Fulcrum, for Operating Lever	S.28	1	
C.777	Nut, Slotted, securing Fulcrum Pin	S.29	1	
FW.106/T	Washer, Plain, under Slotted Nut	S.30	1	
L.103/8U	Pin, Split, retaining Slotted Nut and Reverse Slipper	S.31	2	
C.866	Slipper, Reverse	S.32	1	
C.4284	Ring, Sealing, on Reverse Spindle	S.33	1	
C.1856	COUNTERSHAFT	S.34	1	
C.2041	Gear, 1st Speed (on Counter)	S.35	1	
C.1864	Ring, Retaining, at rear of Needle Rollers	S.36	2	
C.918	Roller, Needle	S.37	58	
C.1861	Washer, Thrust, Inner, at rear of Counter adjacent to Needle Rollers	S.38	1	
C.1862	Washer, Thrust, Outer, at rear of Counter (.156" thick)	S.39	1	} To eliminate end float on the Countershaft, select the Washer which has the desired thickness.
C.1862/1	Washer, Thrust, Outer, at rear of Counter (.159" thick)	S.39	1	
C.1862/2	Washer, Thrust, Outer, at rear of Counter (.162" thick)	S.39	1	
C.1862/3	Washer, Thrust, Outer, at rear of Counter (.162" thick)	S.39	1	
C.1862/4	Washer, Thrust, Outer, at rear of Counter (.164" thick)	S.39	1	
C.2043	Ring, Retaining, on outer end of Front Needle Rollers	S.40	1	
C.2042	Washer, Thrust, Inner, at front end of Counter	S.41	1	
C.1859	Washer, Thrust, Outer, at front end of Counter	S.42	1	
C.2045	Wheel, Constant	S.43	1	
C.2046	Gear, 3rd Speed Countershaft	S.44	1	
C.2047	Gear, 2nd Speed Countershaft	S.45	1	
C.2048	Ring, Split, locating Constant Wheel	S.46	2 halves	
C.2072	Circlip, positioning 3rd Speed Gear and Constant Wheel	S.47	2	
C.4285	Ring, Sealing, on Countershaft	S.48	1	

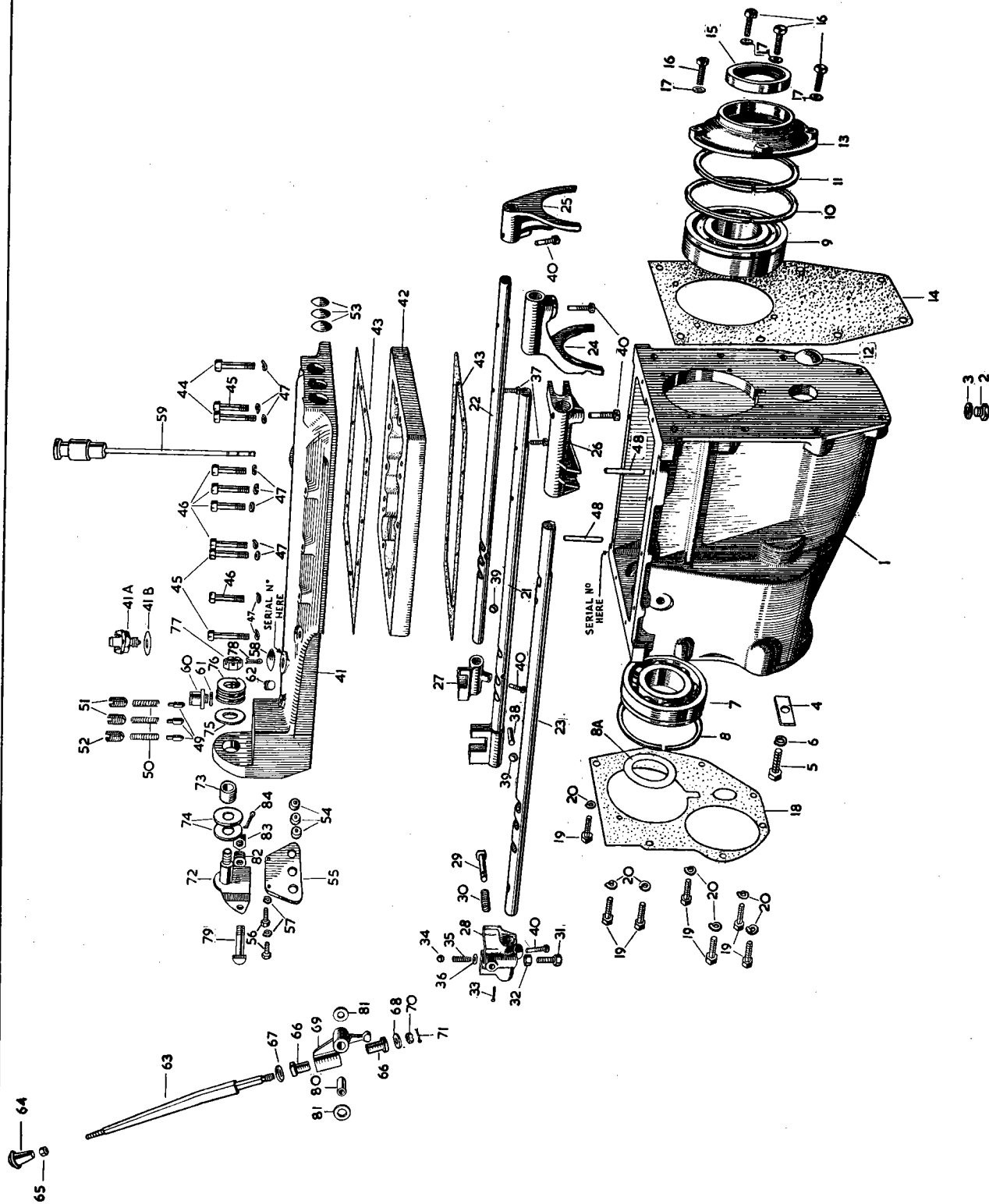

3-2

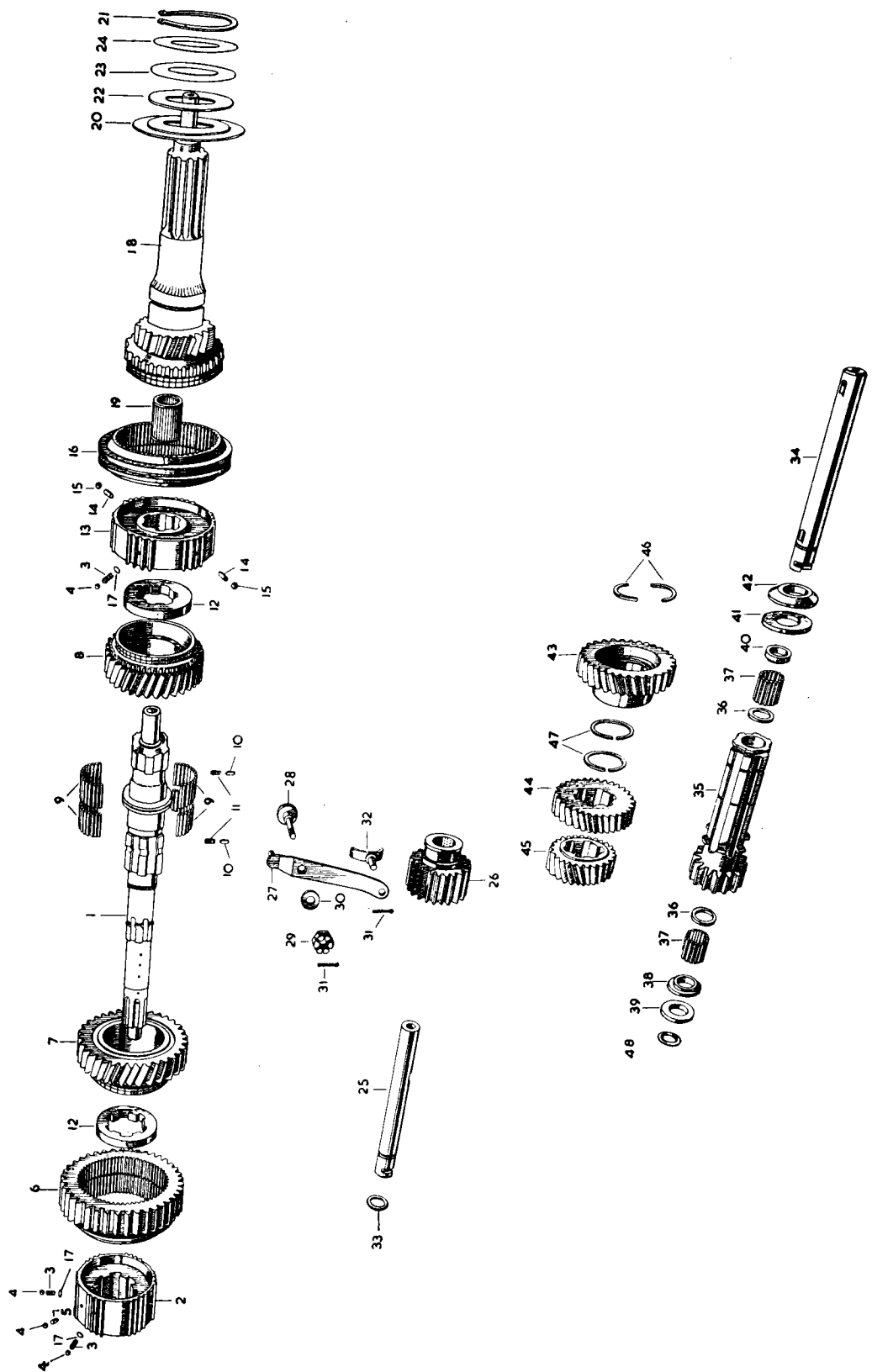

PLATE S