

# CLUTCH AND CLUTCH CONTROL

Part No.	Description.	Plate No.	No. per Unit.	Remarks.
C.7460	<b>CLUTCH UNIT (BORG &amp; BECK BB.10/98A)</b> (INTERCHANGEABLE WITH C.8456)		1	<b>COMPRISING COVER ASSY. RELEASE BEARING AND CUP ASSY, DRIVEN PLATE ASSY.</b>
C.8456	<b>CLUTCH UNIT (BB.10/98C)</b> (INTERCHANGEABLE WITH C.7460)		1	Fitted to Eng. No. F.2726 and subs.
6610	<b>CLUTCH COVER ASSEMBLY (BB.45696/14)</b>		1	
2546	Cover only (BB.45616)	F.1	1	
2544	Spring, Thrust (Yellow) (BB.44780)	F.2	12	
2547	Plate, Pressure (BB.45764)	F.3	1	<b>SEE BB.48992</b>
2583	Lever, Release (BB.47908)	F.4	3	
6839	Lever, Release (BB.48992)		3	<b>INTERCHANGEABLE WITH BB.47908 ONLY IN SETS</b>
5087	Plate, Release Lever (BB.40968)	F.5	1	
2395	Retainer, Release Lever (BB.40015)	F.6	3	
2527	Strut, Release Lever (BB.42606)	F.7	3	
2526	Eyebolt, Release Lever (BB.42605)	F.8	3	
2523	Pin through Eyebolt (BB.42604)	F.9	3	
2398	Nut, on Eyebolt (BB.40020)	F.10	3	
2545	Spring, Anti-Rattle (BB.45577)	F.11	3	
6840	<b>RELEASE BEARING ASSEMBLY (BB.48444)</b>		1	<b>INTERCHANGEABLE WITH BB.40062 OR BB.46896</b>
2590	Release Bearing and Cup Assembly (BB.48443)	F.12	1	
4163	Retainer for Release Bearing (BB.41628)	F.13	1	
2581	<b>DRIVEN PLATE ASSEMBLY (BB.47627/22)</b>	F.14	1	<b>INTERCHANGEABLE</b>
C.8401	<b>DRIVEN PLATE ASSEMBLY (BB.47627/46)</b>	F.14	1	
2561	<b>Facings Package</b> (consisting of BB.46558—Clutch Linings and BB.44055—Rivets) (BB.46663)		1	<b>FOR RENEWAL OF DRIVEN PLATE LININGS</b>
NB.137/6.5D FG.106/X	<b>Screw, Set, securing Clutch Unit to Flywheel</b>	F.15	6	
	<b>Washer, Spring, on Setscrews</b>	F.16	6	
C.2412	<b>CLUTCH HOUSING</b>	F.17	1	Fitted from Engine No. W.1001 to W.1022
	Also to W.1024 to 1308, 1310 to 1338, 1340 to 1344, 1346 to 1348, 1350 to 1353, 1355, 1357-1359 to 1363, 1369 to 1374, 1376, 1378 to 1383, 1385 to 1388, 1391 to 1395, 1397 to 1399-1401 to 1414, 1416, 1418 to 1433, 1435 to 1449, 1451, 1454 to 1484, 1486 to 1491, 1493 to 1495, 1497 to 1537, 1539 to 1542, 1544 to 1547, 1549 to 1561, 1563, 1564, 1567 to 1569, 1572, 1573, 1575 to 1578, 1581, 1583, 1587, 1591, 1593 to 1598, 1600 to 1603, 1606 to 1617, 1619 to 1631, 1633 to 1647, 1649, 1651, 1653 to 1663, 1665 to 1692, 1694 to 1697, 1699 to 1712, 1714, 1716, 1717, 1719 to 1737, 1739 to 1751, 1753 to 1759, 1761 to 1774, 1776 to 1783, 1785, 1787 to 1790, 1793, 1794, 1799, 1800, 1802, 1804, 1806 to 1838, 1840 to 1850, 1852 to 1892, 1894 to 1903, 1905, 1909, 1910, 1912, 1913, 1914, 1916, 1918 to 1923, 1925, 1928 to 1930, 1933 to 1935, 1937, 1939 to 1941, 1943 to 1946, 1949 to 1951, 1953, 1955, 1960, 1962, 1964, 1965, 1967, 1969, 1972, 1973, 1979, 1988, 1991, 1992, 1995, 1996, 1997.			

# CLUTCH AND CLUTCH CONTROL

Part No.	Description.	Plate No.	No. per Unit.	Remarks.
C.6720	<b>CLUTCH UNIT (BORG &amp; BECK BB.10/89A)</b>		1	<b>SPECIAL EQUIPMENT FOR COMPETITION WORK</b>
6615	<b>CLUTCH COVER ASSEMBLY (BB.45696/55)</b>		1	
2546	Cover only (BB.45616)		1	
2544	Spring, Thrust (Yellow) (BB.44780)		3	
4325	Spring, Thrust (Black) (BB.44633)		9	
2584	Plate, Pressure, (comprising 47988 Plate, 47266 Reinforcing Ring) (BB.47989)		1	
2583	Lever, Release (BB.47908)		3	
5087	Plate, Release Lever (BB.40968)		1	
2395	Retainer, Release Lever (BB.40015)		3	
2527	Strut, Release Lever (BB.42606)		3	
2526	Eyebolt, Release Lever (BB.42605)		3	
2523	Pin through Eyebolt (BB.42604)		3	
2398	Nut on Eyebolt (BB.40020)		3	
2582	Spring, Anti-Rattle (BB.47688)		3	
6840	<b>RELEASE BEARING ASSEMBLY (BB.48444)</b>		1	
2590	Release Bearing and Cup, Assy. (BB.48443)		1	
4163	Retainer (BB.41628)		1	
C.5723	<b>DRIVEN PLATE ASSEMBLY (BB.46093/34)</b>		1	

# CLUTCH AND CLUTCH CONTROL

Part No.	Description.	Plate No.	No. per Unit.	Remarks.
C.2412/1	<b>CLUTCH HOUSING</b>		1	Fitted to the following Engines : W.1023, 1309, 1339, 1345, 1349, 1354, 1356, 1358, 1364, 1365, 1367, 1368, 1375, 1377, 1384, 1389, 1390, 1396, 1400, 1415, 1417, 1434, 1450, 1452, 1453, 1485, 1492, 1496, 1538, 1543, 1548, 1562, 1565, 1566, 1570, 1571, 1574, 1579, 1580, 1582, 1584, 1585, 1586, 1588, 1589, 1592, 1599, 1604, 1605, 1618, 1632, 1648, 1650, 1652, 1664, 1693, 1698, 1713, 1715, 1718, 1738, 1752, 1760, 1775, 1784, 1786, 1791, 1792, 1795, 1796, 1797, 1798, 1801, 1803, 1805, 1839, 1851, 1881, 1893, 1904, 1906, 1907, 1908, 1911, 1915, 1917, 1924, 1926, 1927, 1931, 1932, 1936, 1938, 1942, 1947, 1948, 1952, 1954, 1956, 1957, 1958, 1959, 1961, 1963, 1966, 1968, 1970, 1971, 1974, 1975, 1976, 1977, 1978, 1980, 1981, 1982, 1983, 1984, 1985, 1986, 1987, 1989, 1990, 1993, 1994, 1998 to 2607
C.4829	<b>CLUTCH HOUSING</b>		1	Fitted from Eng. No. W.2608 to W.4400
FS.107/6D	Screw, Set, securing Clutch Housing to Gearbox	F.18	2	Fitted to same Engines as enumerated for C.2412/1 and C.4829
FS.107/8D	Screw, Set, securing Clutch Housing to Gearbox	F.19	6	
C.586	Plate, locking Setscrews inside Clutch Housing	F.20	2	
C.587	Plate, locking Setscrews inside Clutch Housing	F.21	2	
NB.137/23D	Bolt, securing Clutch Housing to Cylinder Block	F.22	9	
C.726	Washer, Shakeproof on Bolts	F.23	9	
C.584	Bush, in Clutch Housing, for Operating Shaft	F.24	2	
C.5068	<b>CLUTCH HOUSING</b>		1	Fitted to Eng. No. W.4401 and subs.
FS.107/11D	Screw, Set, securing Clutch Housing to Gearbox		2	
FS.107/13D	Screw, Set, securing Clutch Housing to Gearbox		6	
C.5073	Plate, locking Setscrews		2	
NB.137/23D	Bolt, securing Clutch Housing to Cylinder Block		9	
C.726	Washer, Shakeproof, on Bolts		9	
C.584	Bush, in Clutch Housing, for Operating Shaft		2	
C.2415	<b>COVER PLATE FOR CLUTCH HOUSING</b>	F.25	1	Fitted from Eng. No. W.1001 to W.4400
CS.125/3D	Screw Set, securing Cover Plate	F.26	7	
FG.104/X	Washer, Spring, on Setscrews	F.27	7	
C.5072	<b>COVER PLATE FOR CLUTCH HOUSING</b>		1	Fitted to Eng. No. W.4401 and subs.
CS.125/4D	Screw, Set, securing Cover Plate		4	
C.724	Washer, Shakeproof, on Setscrews		4	
C.2413	<b>SUPPORT BRACKET, R.H.</b>	F.28	1	<b>FITTED TO R.H. DRIVE CARS ONLY</b> from Eng. No. W.1001 to W.2607
C.2414	<b>SUPPORT BRACKET, L.H.</b>		1	<b>FITTED TO L.H. DRIVE CARS ONLY</b> from Eng. No. W.1001 to W.2607
C.4795	<b>SUPPORT BRACKET, R.H.</b>		1	<b>FITTED TO R.H. DRIVE CARS ONLY</b> for Eng. No. W.2608 and subs.
C.4796	<b>SUPPORT BRACKET, L.H.</b>		1	<b>FITTED TO L.H. DRIVE CARS ONLY</b> for Eng. No. W.2608 and subs.
NB.131/9D	Bolt, securing Support Bracket to Cylinder Block	F.29	4	4 required from Eng. No. W.1001 to W.2607
NN.131/L	Nut on Bolts	F.30	4	
FG.105/X	Washer, Spring, under Nuts	F.31	4	
NB.137/23D	Bolt, securing Support Bracket to Cylinder Block	F.32	6	
NN.137/L	Nut on Bolts	F.33	6	
FG.106/X	Washer, Spring, under Nuts	F.34	6	

# CLUTCH AND CLUTCH CONTROL

Part No.	Description.	Plate No.	No. per Unit.	Remarks.
C.2429	<b>CLUTCH OPERATING SHAFT</b>	F.35	1	<b>SUPERSEDED BY C.13157</b>
C.13157	<b>CLUTCH OPERATING SHAFT ASSEMBLY</b>		1	<b>SUPERSEDES C.2429</b>
CB.131/16D FG.105/X	Bolt for Clutch Shaft Location Washer, Spring, on Bolt	F.36 F.37	1 1	
C.2483	<b>LEVER ON CLUTCH SHAFT</b>	F.38	1	
C.568 C.3262 C.3265	Pin (Tapered) locating Lever on Shaft Wire, locking Pin to Shaft Trunnion, in Fork of Lever	F.39 F.40	1 1 1	
C.582	<b>CLUTCH OPERATING FORK</b>	F.41	1	
C.568 C.3262	Pin (Tapered) locating Fork on Operating Shaft Wire, locking Tapered Pin in position	F.42	1 1	
C.2416	<b>CLUTCH PEDAL (SUPERSEDED BY C.3822)</b>	F.43	1	<b>FITTED TO R.H. DRIVE CARS ONLY.</b>
C.3822	<b>CLUTCH PEDAL (SUPERSEDES C.2416)</b>		1	<b>FITTED TO R.H. DRIVE CARS ONLY.</b>
C.2417	<b>CLUTCH PEDAL</b>		1	<b>FITTED TO L.H. DRIVE CARS ONLY.</b>
NB.131/16D NN.131/L C.725	Bolt, securing Clutch Pedal to Shaft Nut on Bolt Washer, Shakeproof, under Nut	F.44 F.45 F.46	1 1 1	
C.2418	<b>SHAFT SUPPORTING CLUTCH PEDAL</b>	F.47	1	<b>FITTED TO R.H. DRIVE CARS ONLY.</b> from Chassis No. 660001 to 660058
C.2419	<b>SHAFT SUPPORTING CLUTCH PEDAL</b>		1	<b>FITTED TO L.H. DRIVE CARS ONLY.</b> from Chassis No. 670001 to 670184
C.4034	<b>SHAFT SUPPORTING CLUTCH PEDAL</b>		1	<b>FITTED TO R.H. DRIVE CARS ONLY.</b> for Chassis No. 660059 and subs. 669001 and subs. 667001 and subs.
C.4035	<b>SHAFT SUPPORTING CLUTCH PEDAL</b>		1	<b>FITTED TO L.H. DRIVE CARS ONLY.</b> for Chassis No. 670185 and subs. 679001 and subs. 677001 and subs.
C.757 C.3256 C.3295 C.3257 C.3255 C.3258 C.2420 L.104/11U	Key (Woodruff 90) locating Pedal on Shaft Spring (Outer) on Shaft Washer, on Shaft, at end of Outer Spring Ring, Sealing (Small) adjacent to Outer Spring Bearing (Spherical) on Shaft, adjacent to Sealing Ring Ring, Sealing (Large) adjacent to Spherical Bearing Washer, at end of Shaft Pin, Split, holding Outer Spring under compression	F.48 F.49 F.50 F.51 F.52 F.53 F.54	1 1 1 1 1 1 1	<b>FITTED TO L.H. DRIVE CARS ONLY.</b>   <b>FITTED TO R.H. DRIVE CARS ONLY.</b>
C.3260	<b>LEVER ON CLUTCH PEDAL SHAFT</b>	F.55	1	
C.757 NB.131/11.D NN.131/L FG.105/X	Key (Woodruff 90) locating Lever on Shaft Bolt, securing Lever to Shaft Nut on Bolt Washer, Spring, under Nut	F.56 F.57 F.58 F.59	1 1 1 1	

# CLUTCH AND CLUTCH CONTROL

Part No.	Description.	Plate No.	No. per Unit.	Remarks.
C.2423	<b>ADJUSTING ROD, BETWEEN LEVER ON PEDAL SHAFT AND LEVER ON CLUTCH SHAFT</b>	F.60	1	
J.105/12S	Pin, Clevis, securing Adjusting Rod to Lever on Pedal Shaft	F.61	1	
FW.105/T	Washer (Plain) on Clevis Pin	F.62	1	
L.103/7U	Pin, Split, retaining Clevis Pin in Lever	F.63	1	
C.2482	Nut, Barrel, on Adjusting Rod	F.64	1	
C.2424	Spring, on Adjusting Rod	F.65	1	Fitted from Chassis No. 660001 to 660058 670001 to 670184
C.4165	Spring on Adjusting Rod		1	Fitted to Chassis No. 660059 and subs. 669001 and subs. 670185 and subs. 679001 and subs. 667001 and subs. 677001 and subs.
FW.105/T	Washer (Plain) on Adjusting Rod, at end of Spring	F.66	1	
L.103/7U	Pin, Split, retaining Spring on Adjusting Rod	F.67	1	
C.3267	<b>BEARING HOUSING ON CLUTCH HOUSING</b>	F.68	1	
CS.131/5D	Screw, Set, securing Bearing Housing	F.69	2	
C.725	Washer, Shakeproof, on Setscrews	F.70	2	
C.3323	Gaiter, on Pedal Shaft, over Bearing Housing	F.71	1	
C.3255	Bearing (Spherical) inside Housing	F.72	1	
C.3321	Spring (Inner) adjacent to Spherical Bearing	F.73	1	
C.3602	<b>PEDAL STEM AND PLATE ASSEMBLY</b>	F.74	1	Fitted from Chassis No. 660001 to 660979 670001 to 672048 669001 to 669002 679001 to 679621
C.6913	<b>PEDAL STEM AND PLATE ASSEMBLY</b>		1	Fitted to Chassis No. 660980 and subs. 672049 and subs. 669003 and subs. 679622 and subs. 667001 and subs. 677001 and subs.
NB.131/10D	Bolt, securing Stem to Pedal Shaft	F.75	1	
NN.131/L	Nut on Bolt	F.76	1	
C.740	Washer, Shakeproof, under Nut	F.77	1	
792	Pad (Rubber) on Stem Plate	F.78	1	
C.3673	Draught Excluder on Pedal Stem	F.79	1	Fitted from Chassis No. 660001 to 660058 670001 to 670184
C.4036	Draught Excluder on Pedal Stem		1	Fitted to Chassis No. 660059 and subs. 669001 and subs. 670185 and subs. 679001 and subs. 667001 and subs. 677001 and subs.
C.3318	Spring, Return, for Clutch Pedal	F.80	1	

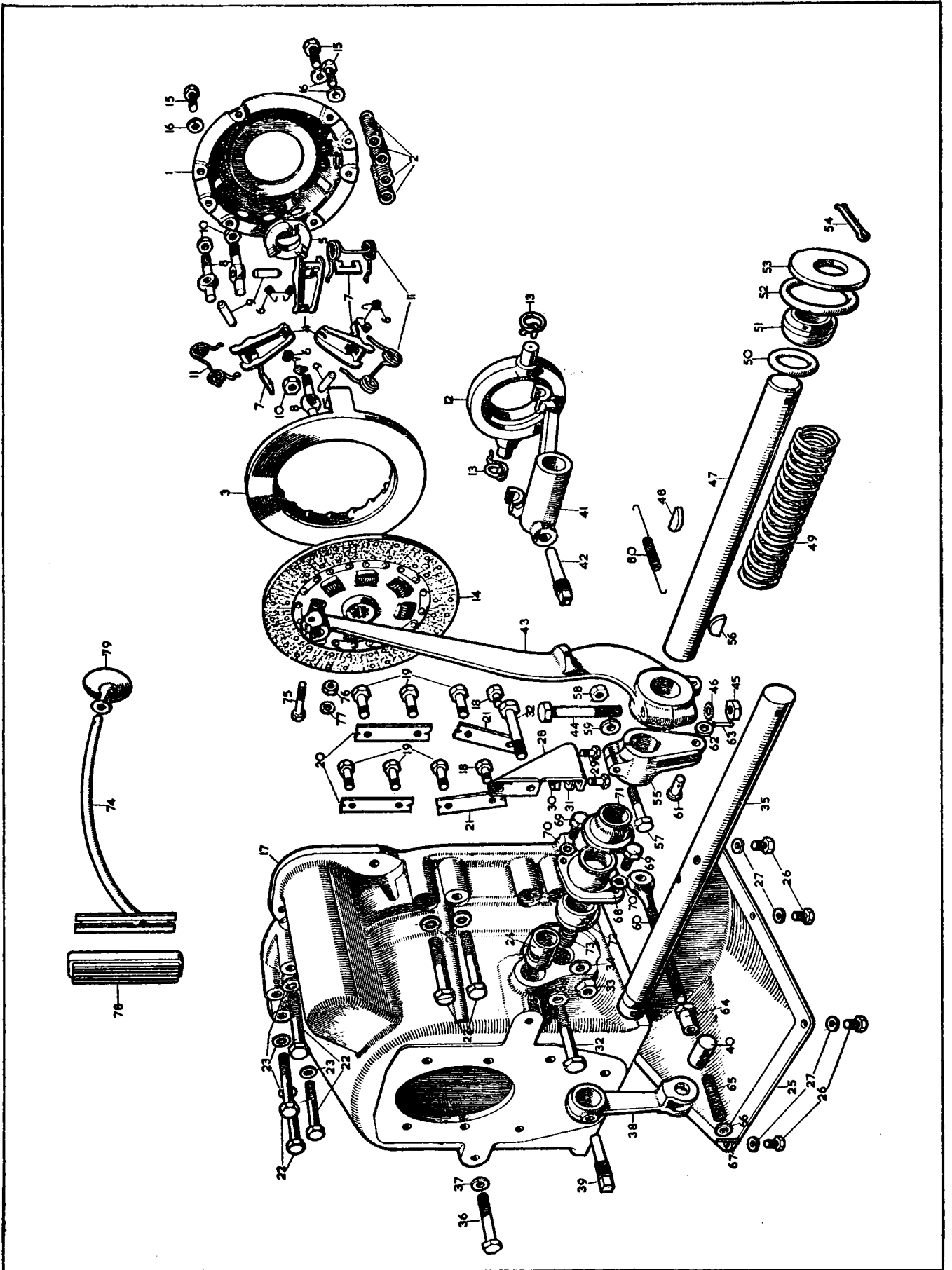

PLATE F.