

CYLINDER BLOCK

Part No.	Description	Plate No.	No. per Unit	Remarks
C.4820	CYLINDER BLOCK		1	Fitted from Eng. No. G.1001 to G.1907
C.8610	CYLINDER BLOCK	A.1	1	Fitted to Eng. No. G.1908 and subs.
C.317	Plug, Core (Welch Washer) at R.H. side of Block		1	
C.315	Plug, core (Welch Washer) at each side and rear end of Block	A.2	7	
C.2238/1	Cover, Timing, Front		1	Fitted from Eng. No. G.1001 to G.1907.
C.8614	Cover, Timing, Front	A.3	1	Fitted to Eng. No. G.1908 and subs.
C.5022	Plug (1" Briggs) on L.H. side of Block, sealing aperture for Heater element	A.4	1	
C.2305	Plug ($\frac{7}{8}$" A.N.F.) in front end of Oil Gallery	A.5	1	
C.2365	Dowel ($\frac{5}{16}$" in front of Block, locating Timing Cover, and between Bearing Caps and Block	A.6	16	
C.2352	Plug ($\frac{1}{2}$" A.N.F.) in side of Oil Gallery	A.7	6	
C.2296/3	Washer (Copper) on Plugs	A.8	6	
C.2269	Stud (Plain) for fixing of Cylinder Head to Block	A.9	13	
C.2270	Stud (Dowel) for fixing of Cylinder Head to Block	A.10	1	
C.2157	Plug ($\frac{7}{8}$" A.N.F.) in rear end of Oil Gallery	A.11	1	
C.2296/2	Washer (Copper) on Plug	A.12	1	
OD.106/4J	Dowel ($\frac{3}{8}$" in rear face of Block, locating Clutch Housing		2	
C.2258	Cover on rear face of Block	A.13	1	
C.2373	Ring-Dowel, between Rear Cover and Block	A.14	2	
NB.131/7D	Bolt, Centre, securing Rear Cover to Block	A.15	1	
NB.131/8.5D	Bolt, Outer, securing Rear Cover to Block	A.16	2	
FG.105/X	Washer, Spring, on Bolts	A.17	3	
C.2332	Ring, Sealing, on Rear Cover	A.18	1	
C.2394	Dowel-Ring, between Sealing Ring and Rear Cover	A.19	2	
C.2470	Cap-Screw, securing Sealing Ring to Rear Cover	A.20	2	
C.2354	Tap, Water, Drain, in L.H. side of Block	A.21	1	
C.2296/3	Washer (Copper) on Drain Tap	A.22	1	
C.316	Washer (Fibre) on Drain Tap	A.23	As req'd	
C.2262	Bolt, securing Bearing Caps		14	
C.2425	Washer, locking Bolts on Centre, Intermediate, and Rear Bearing Caps		12	
C.2427	Washer, locking Bolts on Front Bearing Cap		2	
C.2430	Ring, Sealing, in Distributor aperture on Block		1	
NS.125/4D	Screw, Set, securing Distributor in Block		1	
C.724	Washer, Shakeproof, on Setscrew		1	
C.5846	Union, connecting Oil Feed Pipe to Block		1	
C.4146	Washer (Copper) at each side of Union		1	
C.2192	Bracket, on Block, for attachment of Dynamo		1	Fitted from Eng. No. G.1001 to G.1907.
C.8620	Bracket, on Block, for attachment of Dynamo		1	MAY BE USED TO REPLACE C.2192 up to Eng. No. G.1907.
C.8619	Bracket, on Block, for attachment of Dynamo	A.24	1	Fitted to Eng. No. G.1908 and subs.
NS.137/6D	Screw, Set, securing Bracket to Block		3	
FG.106/X	Washer, Spring, on Setscrews		3	
NB.131/8D	Bolt, securing Dynamo to Bracket		2	
NN.131/L	Nut, on Bolts		2	
FG.105/X	Washer, Spring, under Nuts		2	
NS.119/2D	Plug, in aperture for Distributor Drive lubrication		1	
AW.102/E	Washer (Copper) on Plug		1	
C.4808	CRANKSHAFT	A.25	1	
C.4283	Plug, Screwed, in Crankshaft Journals	A.26	6	
C.8241	Damper Assembly, for Crankshaft	A.27	1	USED WHEN STANDARD CYLINDER HEAD IS FITTED
C.8129	Damper Assembly, for Crankshaft		1	USED WHEN SPECIAL EQUIPMENT CYLINDER HEAD IS FITTED
C.2466	Cone for centre of Damper	A.28	1	
C.7275	Pulley, on Crankshaft for Fan Belt	A.29	1	

CYLINDER BLOCK

Part No.	Description	Plate No.	No. per Unit	Remarks
CRANKSHAFT (continued)				
NB.131/11F	Bolt , securing Pulley to Damper Assembly	A.30	4	
C.725	Washer , Shakeproof, on Bolts	A.31	2	
C.2173	Piece , Distance, on Crankshaft	A.32	1	
C.2283	Oil Throwing , behind Distance Piece	A.33	1	
C.2170	Gear for Timing Chain	A.34	1	
C.2134	Gear for Oil Pump Drive	A.35	1	
C.757	Key , locking Cone to Damper and Crankshaft, Distributor Gear and Oil Pump Gear to Crankshaft	A.36	4	
C.5896	Bolt , securing Damper to Crankshaft	A.37	1	
C.2468	Washer , behind Bolt	A.38	1	
C.2467	Washer , locking Bolt	A.39	1	
C.2315	Bearing , Main, on Front, Centre and Rear Journals of Crankshaft (Standard size)	A.40	6 halves	
C.2317	Bearing , Main, on Intermediate Journals of Crankshaft (Standard size)	A.41	8 halves	
C.2316	Washer , Thrust, at bottom of Centre Bearing Cap	A.42	As req'd	
C.2316/1	Washer , Thrust, at bottom of Centre Bearing Cap	A.42	As req'd	
C.2226	Bush , in rear end of Crankshaft, for Gearbox Primary Shaft	A.42	1	
<p>MAIN BEARINGS are obtainable in the following undersizes :— —.020" —.030" —.040"</p> <p>When ordering, please quote Part No. and under-size required (e.g. C.2315/20 for .020" undersize)</p>				
CONNECTING ROD (LESS BEARINGS)				
C.7917		A.44	6	
C.2439 ✓	Bearing , Small End		6	
C.3944	Bolt , securing Caps to Connecting Rods		12	
C.2361	Nut on Bolts		12	
L.103.5/8U	Pin , Split, locking Nuts		12	
C.1132	Bearing , Big End (Standard size)	A.45	12 halves	
<p>BIG END BEARINGS are obtainable in the following undersizes :— —.020" —.030" —.040"</p> <p>When ordering, please quote Part No. and under-size required (e.g. C.1132/20 for .020" undersize)</p>				
FLYWHEEL				
C.4809		A.46	1	FOR USE ON ALL MODELS EXCEPT THOSE FITTED WITH OVERDRIVE UNIT
C.5808		A.46	1	FOR USE ONLY ON CARS FITTED WITH OVERDRIVE UNIT
C.2313	Dowel in centre of Flywheel	A.47	2	
C.1782	Dowel on outer face of Flywheel	A.48	2	
C.4855	Screw , Set, securing Flywheel to Crankshaft	A.49	10	
C.4810	Plate , locking Setscrews	A.50	1	

CYLINDER BLOCK

Part No.	Description	Plate No.	No. per Unit	Remarks
C.3086	PISTON, COMPLETE	A.51	6	7 : 1 COMPRESSION RATIO
C.3087	PISTON, COMPLETE	A.51	6	8 : 1 COMPRESSION RATIO
C.5830	Ring, Pressure, Upper (Chromium Plated)	A.52	6	
C.5831	Ring, Pressure, Lower	A.53	6	
C.5832	Ring, Scraper	A.54	6	
C.3104	Pin, Gudgeon, retaining Piston on Connecting Rods	A.55	6	
C.3964	Circlip, securing Gudgeon Pins in Pistons	A.56	12	

PISTONS AND RINGS are obtainable in the following oversizes :—
 +.005" +.010" +.015" +.020" +.030"

When ordering, please state Part No. and oversize required (e.g. C.3087/15 for .015" oversize).

C.7313	OIL SUMP (COMPLETE WITH TRAYS)		1	} Fitted from Eng. No. G.1001 to G.1907.
C.2306	Seal (Asbestos) at front end of Sump		1	
C.2302	Seal (Cork/Rubber) at rear end of Sump		1	
C.2205	Gasket, between Sump and Cylinder Block		2 halves	

C.8592	OIL SUMP (COMPLETE WITH TRAYS)	A.57	1	} Fitted to Eng. No. G.1908 and subs.
C.8593	Seal at front end of Sump	A.58	1	
C.2302	Seal (Cork/Rubber) at rear end of Sump	A.59	1	
C.8595	Gasket, between Sump and Cylinder Block	A.60	2 halves	
C.2364	Drain Plug for Oil Sump	A.61	1	
C.2296/1	Washer (Copper) on Drain Plug	A.62	1	

C.8441	DEFLECTOR ASSEMBLY FOR OIL SUMP		1	} FITTED TO ALL EXPORT CARS OR SUPPLIED TO SPECIAL ORDER FOR THE HOME MARKET
NS.131/4D	Screw, Set, securing Deflector		9	
FW.105/T	Washer, Plain, on Setscrews		9	
FG.105/X	Washer, Spring, on Setscrews		9	

CYLINDER BLOCK

Part No.	Description	Plate No.	No. per Unit	Remarks
C.7437	OIL FILTER ASSEMBLY INSIDE OIL SUMP	A.63	1	
NS.125/4D C.724	Screw, Set, securing Oil Filter Washer, Shakeproof, on Setscrews		6 6	
NS.131/5D NS.131/6D FG.105/X	Screw, Set, securing Oil Sump to Cylinder Block Screw, Set, securing Oil Sump to Cylinder Block Washer, Spring, on Setscrews		1 25 26	
C.7486	DIPSTICK ASSEMBLY FOR OIL SUMP		1	Fitted from Eng. No. G.1001 to G.1907
C.8781	DIPSTICK ASSEMBLY FOR OIL SUMP	A.64	1	Fitted to Eng. No. G.1908 and subs.
C.8240	IGNITION TIMING POINTER ON OIL SUMP	A.65	1	
NS.125/3D NN.125/L C.724	Screw, Set, securing Pointer to Sump Nut, on Setscrews Washer, Shakeproof, under Nuts		2 2 2	
C.8068	FLEXIBLE OIL PIPE FROM TOP OF OIL CLEANER TO PRESSURE GAUGE PIPE	A.66	1	
1425	OIL PIPE FROM FLEXIBLE PIPE TO PRESSURE GAUGE ON INSTRUMENT PANEL	A.67	1	

CYLINDER BLOCK

Part No.	Description	Plate No.	No. per Unit	Remarks
C.7589	BRACKET, R.H., FOR FRONT ENGINE MOUNTING		1	} Fitted from Eng. No. G.1001 to G.1907.
C.7590	BRACKET, L.H., FOR FRONT ENGINE MOUNTING		1	
C.8783	BRACKET, R.H., FOR FRONT ENGINE MOUNTING	A.68	1	} Fitted to Eng. No. G.1908 and subs.
C.8784	BRACKET, L.H., FOR FRONT ENGINE MOUNTING	A.69	1	
NS.143/6D C.727	Screw, Set, securing Brackets Washer, Shakeproof, on Setscrews		6 6	
C.4794	FRONT ENGINE MOUNTINGS	A.70	2	
NS.131/6D	Screw, Set, securing Front Mountings to Bracket on Chassis Frame		4	
FW.105/T	Washer, Plain, on Setscrews		4	
NN.131/L	Nut on Setscrews		4	
C.725	Washer, Shakeproof, under Nuts		4	
NS.150/7D	Screw, Set, securing Engine to Rubber Mounting		2	
FW.108/T	Washer, Plain, on Setscrews		2	
FG.108/X	Washer, Spring, on Setscrews		2	
C.4467	BRACKET, R.H., FOR REAR ENGINE MOUNTING	A.71	1	
C.4468	BRACKET, L.H., FOR REAR ENGINE MOUNTING	A.72	1	
NB.137/25D	Bolt, securing Brackets		4	
NB.137/27D	Bolt, securing Brackets		2	
NN.137/L	Nut, on Bolts		6	
FG.106/X	Washer, Spring, under Nuts		6	

CYLINDER BLOCK

Part No.	Description	Plate No.	No. per Unit	Remarks
C.4794	REAR ENGINE MOUNTINGS	A.73	2	
C.4302	Plate, Packing, under Rear Engine Mountings	A.74	As req'd	
NB.131/7D	Bolt, securing Mountings to Bracket on Chassis Frame		4	
FW.105/T	Washer, Plain, on Bolts		4	
NN.131/L	Nut, on Bolts		4	
C.725	Washer, Shakeproof, under Nuts		4	
NS.150/7D	Screw, Set, securing Engine to Rubber Mounting		2	
FW.108/T	Washer, Plain, on Setscrews		2	
FG.108/X	Washer, Spring, on Setscrews		2	
Assembly 215	GASKETS PACKAGE FOR COMPLETE ENGINE OVERHAUL		1	

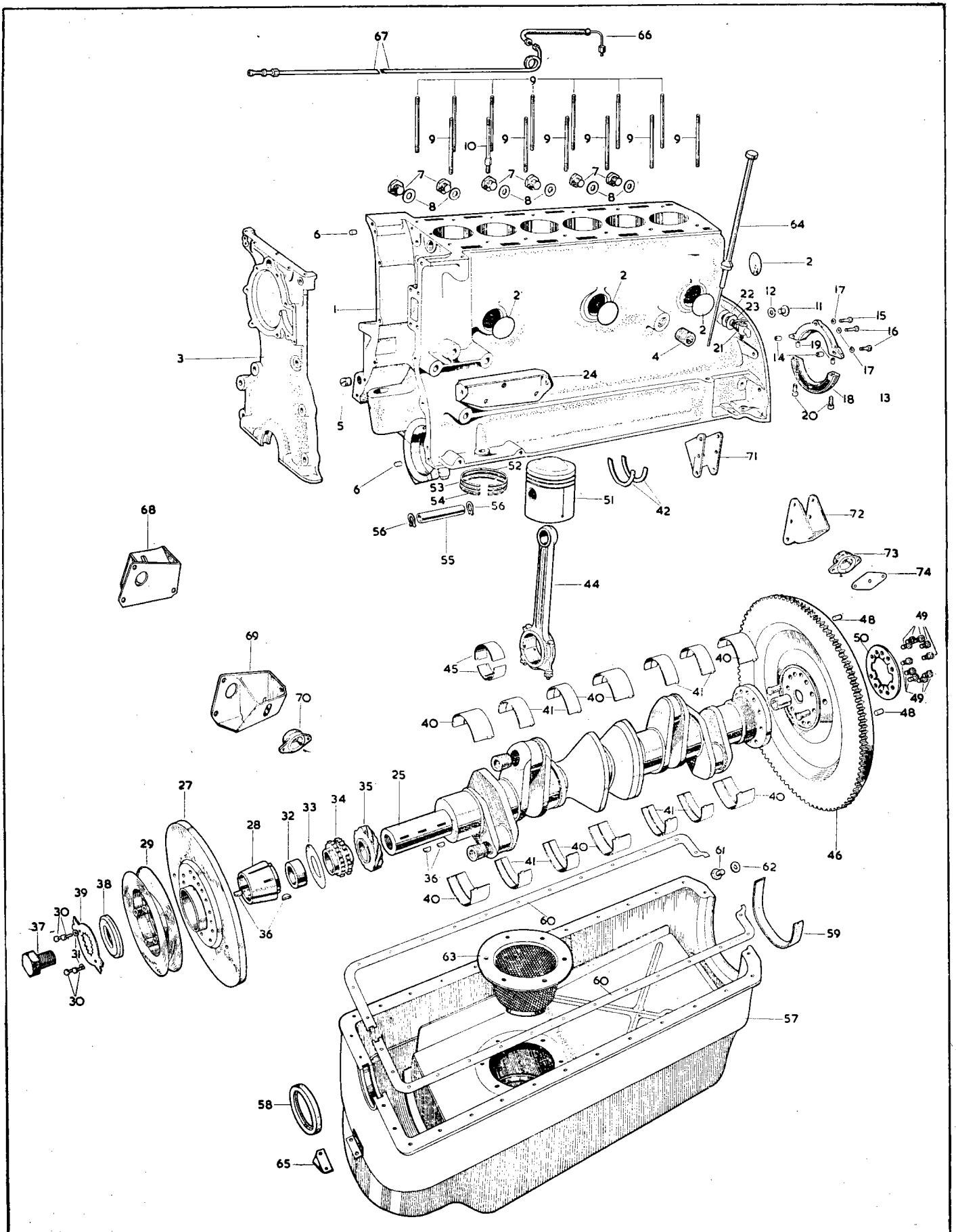

PLATE A

CYLINDER BLOCK

Part No.	Description	Plate No.	No. per Unit	Remarks	
C.7484	OIL PUMP COMPLETE		1	Fitted from Eng. No. G.1001 to G.1907.	
C.7716	Body only	B.1	1		
C.6548	Gear, Driving	B.2	1		
C.6549	Spindle for Driving Gear	B.3	1		
C.752	Key, locking Driving Gear on Spindle	B.4	1		
C.6546	Gear, Driven	B.5	1		
C.6547	Spindle for Driven Gear	B.6	1		
C.7717	Cover at bottom of Pump Body	B.7	1		
C.6282	Stop Assembly at bottom of Cover	B.8	1		
C.6283	Valve, Relief, in Pump Body	B.9	1		
C.8482	Spring, between Stop and Relief Valve	B.10	1		
C.7718	Gasket, between Cover and Pump Body	B.11	1		
NB.131/6D	Bolt, securing Cover to Pump Body	B.12	2		
NB.131/9D	Bolt, securing Cover to Pump Body	B.13	1		
NB.131/14D	Bolt, securing Cover to Pump Body	B.14	1		
NB.131/20D	Bolt, securing Cover to Pump Body	B.15	1		
C.740	Washer, Shakeproof, on Bolts	B.16	5		
C.2352	Plug, in Cover and Pump Body	B.17	2		
C.2427	Washer, locking Plugs	B.18	2		
C.6602	Stud, in Oil Pump Cover, for fixing of Suction Pipe	B.19	2	} Fitted from Eng. No. G.1001 to G.1907.	
C.2150	Shaft, Drive, between Distributor and Coupling Shaft	B.20	1		
C.2174	Bush on Drive Shaft	B.21	1		
C.2393	Washer, on Drive Shaft (at bottom of Bush)	B.22	1		
C.2152	Gear, Helical, driving Oil Pump and Distributor	B.23	1		
C.753	Key, locking Helical Gear on Drive Shaft	B.24	1		
NN.256/L	Nut at bottom of Drive Shaft	B.25	1		
C.2151	Washer, Special, locking Nut	B.26	1		
C.2263	Shaft, coupling Driving Gear in Pump and Drive Shaft for Distributor	B.27	1		
C.2311	Bolt, Dowel, securing Oil Pump to Bearing Cap		2		
NB.137/14D	Bolt, securing Oil Pump to Bearing Cap		1		
C.741	Washer, Shakeproof, on Bolts		3		
C.5874	OIL DELIVERY PIPE FROM PUMP TO BLOCK	B.28	1		} Fitted from Eng. No. G.1001 to G.1907.
C.2220	Gasket, under each flange of Delivery Pipe	B.29	2		
NB.131/6D C.7263	Bolt, securing Delivery Pipe to Pump and Block Washer, Tab, locking Bolts		4 4		
C.7441	OIL SUCTION PIPE FROM OIL SUMP TO PUMP	B.30	1	} Fitted from Eng. No. G.1001 to G.1907.	
C.2220	Gasket, between Suction Pipe flange and Pump Cover	B.31	1		
NN.131/L	Nut, securing Suction Pipe to Pump Cover		2		
C.7263	Washer, Tab, locking Nuts		2		
C.6824	Clip, securing Suction Pipe to Strut	B.32	1		
C.8049	Strut, on Bearing Cap, stiffening Suction Pipe	B.33	1		
NS.125/5D	Screw, Set, securing Clip to Strut		1		
FW.104/T	Washer, Plain, on Setscrews		1		
C.3968/1	Nut, Self-Locking, on Setscrews		1		
C.6829	Plate, Sealing, at bottom of Suction Pipe	B.34	1		
C.6828	Spring, compressing Sealing Plate	B.35	1		
L.103/10U	Pin, Split, retaining Sealing Plate and Spring on Suction Pipe	B.36	1		

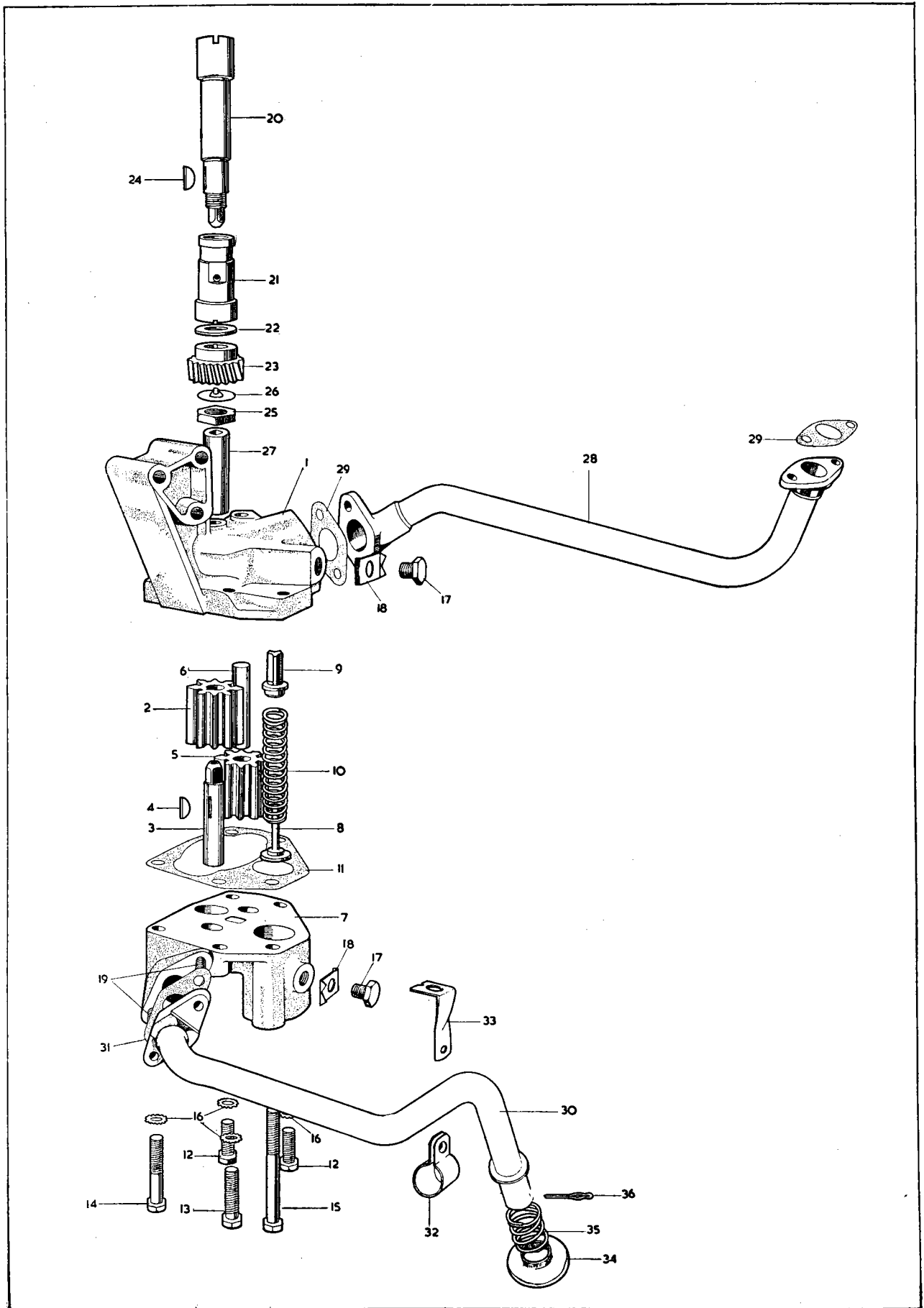

PLATE B

CYLINDER BLOCK

Part No.	Description	Plate No.	No. per Unit	Remarks
C.8612	OIL PUMP COMPLETE (HE.1359)		1	Fitted to Eng. No. G.1908 and subs.
C.8823	Body only (HE.1360)	C.1	1	SUPPLIED ONLY AS A COMPLETE ASSEMBLY
C.9794	Rotor Assembly (HE.1493) (comprising Inner Rotor, Outer Rotor, Driving Shaft and Locking Pin)	C.2	1	
C.8824	Cover at bottom of Pump	C.3	1	
UCS.131/8R	Screw, Set, securing Cover	C.4	2	
UCS.131/14R	Screw, Set, securing Cover	C.5	2	
FG.105/X	Washer, Spring, on Setscrews	C.6	4	
C.8649	" O " Ring in Oil Pump Body and Cover	C.7	2	
C.8646	Shaft, Drive, between Distributor and Coupling Shaft	C.8	1	
C.8647	Bush on Drive Shaft	C.9	1	
C.2393	Washer on Drive Shaft (at bottom of Bush)	C.10	1	
C.2152	Gear, Helical, driving Oil Pump and Distributor	C.11	1	
C.753	Key, locking Helical Gear on Drive Shaft	C.12	1	
NN.256/L	Nut at bottom of Drive Shaft	C.13	1	
C.2151	Washer, Special, locking Nut	C.14	1	
C.8648	Shaft, coupling Driving Gear in Pump and Drive Shaft for Distributor	C.15	1	
C.9294	Bolt, Dowel, securing Oil Pump to Bearing Cap	C.16	3	
C.7263	Washer, Tab, on Bolts	C.17	3	
C.8608	OIL DELIVERY PIPE FROM PUMP TO BLOCK	C.18	1	Fitted to Eng. No. G.1908 and subs.
C.2220	Gasket, between flange of Delivery Pipe and Block	C.19	1	
NB.131/6D	Bolt, securing Delivery Pipe to Block		2	
C.7263	Washer, Tab, locking Bolts		2	
C.8606	OIL SUCTION PIPE FROM OIL SUMP TO PUMP	C.20	1	Fitted to Eng. No. G.1908 and subs.
C.6824	Clip, securing Suction Pipe to Struts	C.21	2	
C.8665	Strut, on Pump, supporting Suction Pipe	C.22	1	
C.8779	Strut, on Bearing Cap, supporting Suction Pipe	C.23	1	
NS.125/5D	Screw, Set, securing Clips to Struts		2	
FW.104/T	Washer, Plain, on Setscrews		2	
C.3968/I	Nut, Self-Locking, on Setscrews		2	
C.6829	Plate, Sealing, at bottom of Suction Pipe	C.24	1	
C.6828	Spring, compressing Sealing Plate	C.25	1	
L.103/10U	Pin, Split, retaining Sealing Plate and Spring on Suction Pipe	C.26	1	

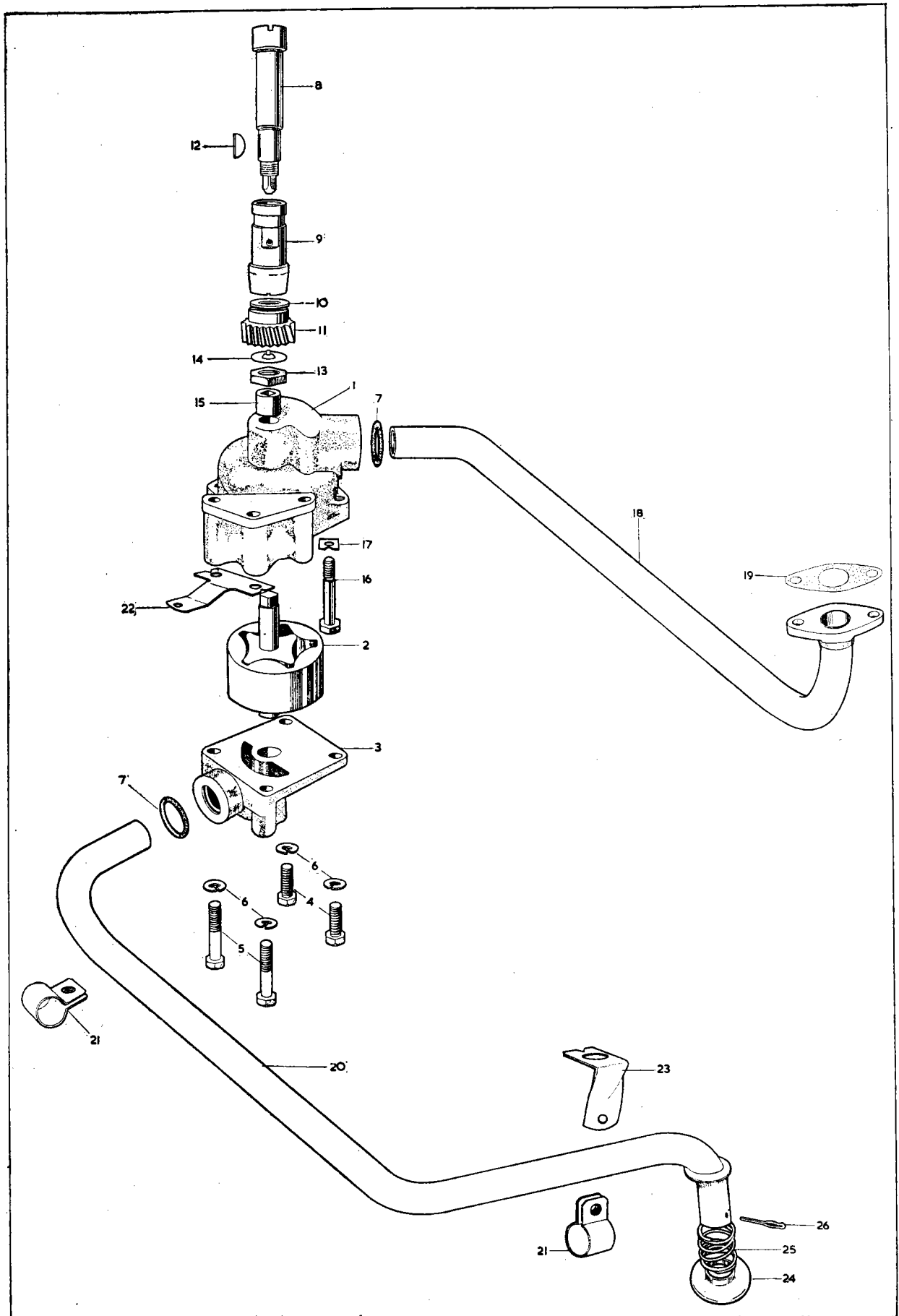

PLATE C

CYLINDER BLOCK

Part No.	Description	Plate No.	No. per Unit	Remarks
C.7438	OIL CLEANER COMPLETE (TECALEMIT FA.2690)			Fitted from Engine No. G.1001 to G.1907.
FG.2421	Element			
46160	Canister			
160065	Spring, at bottom of Canister, for bottom Pressure Plate			
120732	Washer at top of Spring			
141130	Washer (Felt) under bottom Pressure Plate			
120731	Plate, Pressure, at bottom of Canister			
163149	Circlip, retaining bottom Pressure Plate			
114317	Filter Head			
102256	Screw, Union, at top of Filter Head, for attachment of Flexible Oil Pipe			
150395	Washer, under Union Screw			
SK.100485	Seal (Rubber) in Filter Head			
141092	Washer (Felt) under top Pressure Plate			
134295	Plate, Pressure, on Filter Head			
160259	Circlip, retaining top Pressure Plate			
50002	Valve, Balance, Assembly, in Filter Head			
102298	Bolt, securing Filter Head to Canister			
WWA.1010	Washer (Steel) under head of Bolt			
137015	Washer (Rubber) on Bolt			
C.9936	OIL CLEANER COMPLETE (TECALEMIT FA.2690/101)			Fitted to Eng. No. G.1908 and subs.
FG.2421	Element	D.1		
46160	Canister	D.2		
160065	Spring, at bottom of Canister, for Pressure Plate	D.3		
120732	Washer (Dished) at top of Spring, holding Felt Washer	D.4		
141130	Washer (Felt) under bottom Pressure Plate	D.5		
120731	Plate, Pressure, at bottom of Canister	D.6		
163149	Circlip, retaining bottom Pressure Plate	D.7		
114317	Filter Head	D.8		
102256	Screw, Union, at top of Filter Head, for attachment of Flexible Oil Pipe	D.9		
4323	Washer, under Union Screw	D.10		
C.4014	Valve, Relief, Assembly			
137365	Seal (Rubber) on Filter Head	D.11		
141092	Washer (Felt) under top Pressure Plate	D.12		
134295	Plate, Pressure on Filter Head	D.13		
160259	Circlip, retaining top Pressure Plate	D.14		
50002	Valve, Balance, Assembly, in Filter Head	D.15		
102298	Bolt, securing Filter Head to Canister	D.16		
137333	Washer (Rubber) under head of Bolt	D.17		
C.4014	RELIEF VALVE ASSEMBLY (TECALEMIT 49010)			Fitted to Eng. No. G.1908 and subs.
100197	Body for Relief Valve	D.18		
140034	Washer (Fibre) between Valve Body and Filter Head	D.19		
118076	Valve only	D.20		
160371	Spring for Relief Valve	D.21		
100195	Housing for Relief Valve Spring	D.22		

CYLINDER BLOCK

Part No.	Description	Plate No.	No. per Unit	Remarks
RELIEF VALVE ASSEMBLY (continued)				
100194	Nut, Dome, on Housing	D.23	1	
150202	Nut, Lock	D.24	1	
150318	Washer (Copper) at each side of Locknut	D.25	2	
C.2248	Gasket, between Oil Cleaner and Cylinder Block	D.26	1	
NB.131/9D	Bolt, securing Oil Cleaner to Block (top fixing)		2	
NB.131/36D	Bolt, securing Oil Cleaner to Block (bottom fixing)		2	
FW.105/E	Washer (Copper) on Bolts, adjacent to Cylinder Block		4	
FW.105/T	Washer (Steel) under head of Bolts		4	

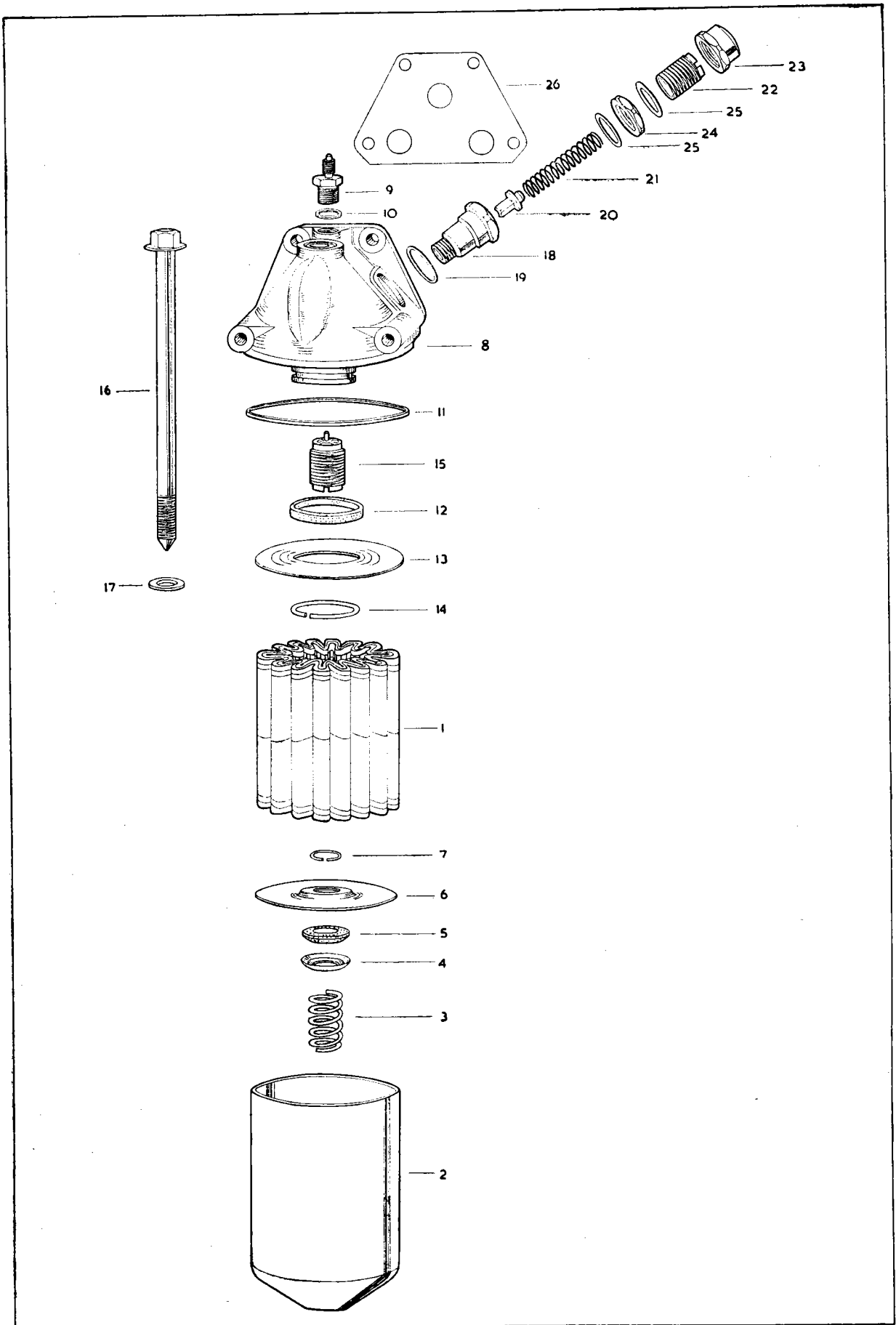

PLATE D

CYLINDER BLOCK

Part No.	Description	Plate No.	No. per Unit	Remarks
C.7618	WATER PUMP COMPLETE		1	
C.7452	Body only	E.1	1	
C.8167	Spindle , complete with Bearing	E.2	1	
C.8011	Screw (Allen Head) retaining Bearing in Pump Body	E.3	1	
NN.225/L	Nut , locking Screw	E.4	1	
C.8256	Thrower , on long end of Spindle, adjacent to Bearing	E.5	1	
C.6773	Seal , on long end of Spindle, adjacent to Bearing	E.6	1	
C.7675	Impeller	E.7	1	
C.7645	Carrier , for Pulley, on short end of Spindle	E.8	1	
C.7644	Pulley	E.9	1	
NS.131/6D	Screw , Set, securing Pulley to Carrier	E.10	4	
C.740	Washer , Shakeproof, on Setscrews	E.11	4	
C.7631	Elbow , on Water Pump, for Heater Pipe Connection	E.12	1	
C.7733	Gasket , between Elbow and Pump	E.13	1	
NB.125/9D	Screw , Set, securing Elbow to Pump	E.14	2	
C.724	Washer , Shakeproof, on Setscrews	E.15	2	
C.2303	Gasket , between Water Pump and Cylinder Block	E.16	1	
C.7615	FAN FOR WATER PUMP	E.17	1	FITTED TO ALL MODELS EXCEPT THE FOLLOWING FIXED HEAD COUPE CARS 804001 to 804019 814001 to 814034
C.10128	FAN FOR WATER PUMP	E.17	1	FITTED ONLY TO THE FOLLOWING FIXED HEAD COUPE CARS 804001 to 804019 814001 to 814034
C.5121	Balance-Piece for Fan	E.18	As req'd	
C.7898	BELT, DRIVING FAN	E.19	1	
C.7548	BY-PASS WATER HOSE	E.20	1	
C.2905/4	Clip , securing By-Pass Hose	E.21	2	

CYLINDER BLOCK

Part No.	Description	Plate No.	No. per Unit	Remarks
HEATER CONNECTIONS BELOW				
BD.215/1	HOSE, FROM ELBOW ON WATER PUMP TO FRONT RETURN (HEATER) PIPE	E.22	1	
C.2905/1	Clip, securing Hose	E.23	1	
C.2905/2	Clip, securing Hose	E.24	1	
C.4836	FRONT HEATER RETURN PIPE ALONG SIDE OF CYLINDER BLOCK	E.25	1	
C.4837	Clip, securing Front Return Pipe at front	E.26	1	
C.4402	Clip, securing Front Return Pipe at rear	E.27	1	
NS.119/4D	Screw, Set, securing Clips to Front Return Pipe		2	
NN.119/L	Nut on Setscrews		2	
C.723/A	Washer, Shakeproof, under Nuts		2	
NS.125/3D	Screw, Set, securing front Clip to Block		1	
C.724	Washer, Shakeproof, on Setscrew		1	
C.290	Adaptor, in Inlet Manifold, for Heater connection		1	
C.2296/1	Washer (Copper) on Adaptor		1	
C.9552	Bracket on Manifold, mounting Heater Tap		1	} REQUIRED ONLY FOR FIXED HEAD COUPE
FW.105/T	Washer for Bracket		2	

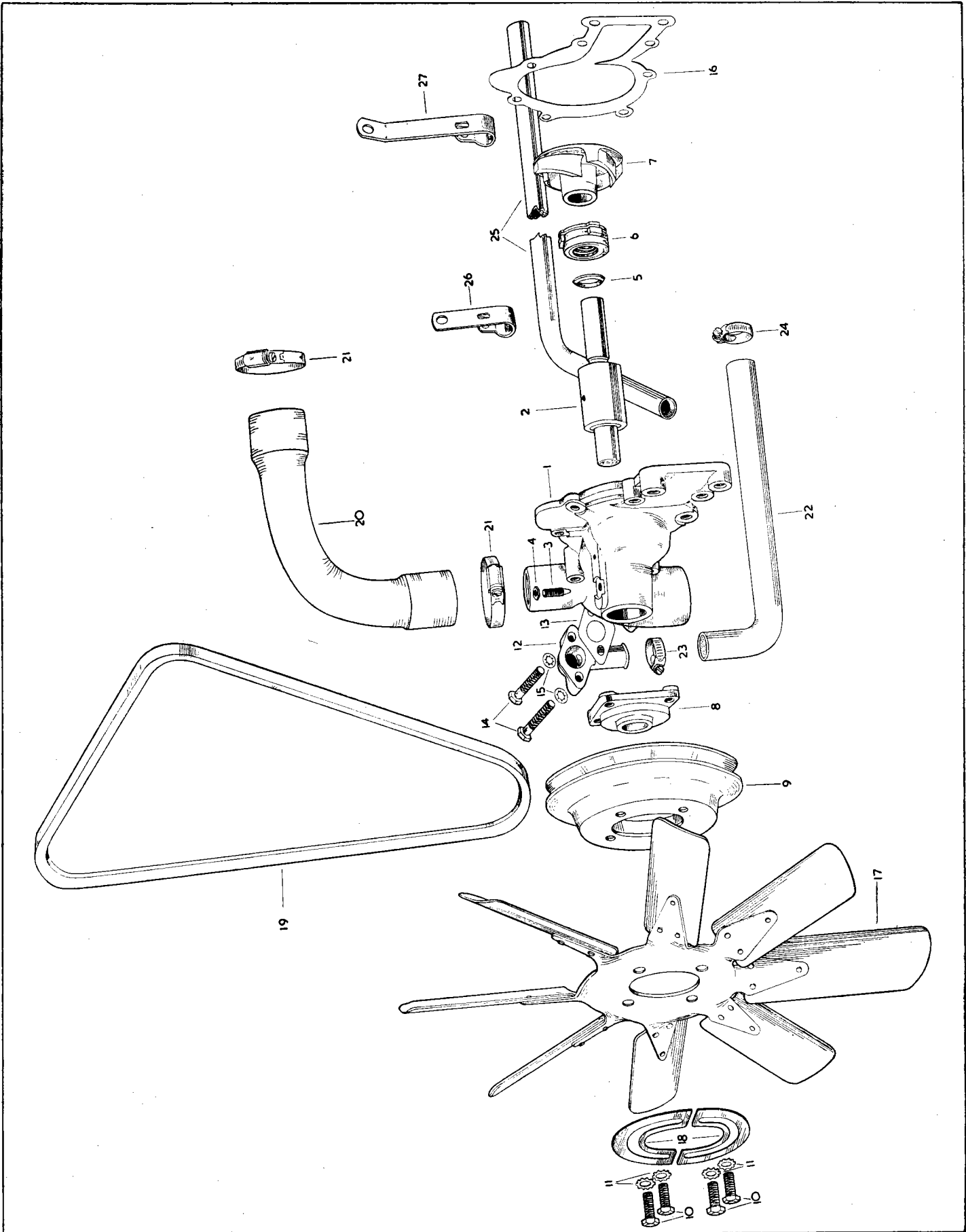

PLATE E

CYLINDER HEAD

Part No.	Description	Plate No.	No. per Unit	Remarks
SD.1032	CYLINDER HEAD, COMPLETE (Comprising Cylinder Head, Valves, Valve Inserts, Guides, Springs, Tappets, Tappet Guides, Adjusting Pads, Camshafts, Camshaft Cover, Filler Cap, Rev. Counter Adaptor, Breather Cover, Etc.)		1	STANDARD ONLY
SD.1025	CYLINDER HEAD, COMPLETE (Comprising Cylinder Head, Valves, Valve Inserts, Guides, Springs, Tappets, Tappet Guides, Adjusting Pads, Camshafts, Camshaft Covers, Filler Cap, Rev. Counter Adaptor, Breather Cover, Etc.)		1	SPECIAL EQUIPMENT
C.6733	CYLINDER HEAD	F.1	1	STANDARD ONLY
C.2326	Stud , in Cylinder Head, for fixing of Camshaft Bearing Caps and Covers	F.2	16	
C.2373	Ring-Dowel on Studs	F.3	16	
C.2323	" D " Washer on Studs	F.4	16	
NN.131/L	Nut , securing Bearing Caps		16	
FG.105/X	Washer , Spring, under Nuts		16	
C.2157	Core Plug (Headed) on Top of Cylinder Head	F.5	3	
C.2296/2	Washer (Copper) under Headed Core Plugs	F.6	3	
C.7260	Guide for Inlet Valves	F.7	6	
C.8312	Guide for Exhaust Valves		6	
C.7258	Insert for Inlet Valves	F.8	6	
C.7259	Insert for Exhaust Valves		6	
C.7262	Guide for Tappets	F.9	12	
C.7707	" C " TYPE CYLINDER HEAD		1	SPECIAL EQUIPMENT
C.2326	Stud , in Cylinder Head, for fixing of Camshaft Bearing Caps and Covers		16	
C.2373	Ring-Dowel on Studs		16	
C.2323	" D " Washer on Studs		16	
NN.131/L	Nut , securing Bearing Caps		16	
FG.105/X	Washer , Spring, under Nuts		16	
C.2157	Core Plug (Headed) on top of Cylinder Head		3	
C.2296/2	Washer (Copper) under Headed Core Plugs		3	
C.9867	Guide for Inlet Valves		6	
C.9868	Guide for Exhaust Valves		6	
C.9863	Insert for Inlet Valves		6	
C.9865	Insert for Exhaust Valves		6	
C.7262	Guide for Tappets		12	
C.7861	Gasket , between Cylinder Head and Block	F.10	1	
C.2189	Stud on underside front end of Head	F.11	4	
NN.131/L	Nut on Studs		4	
FG.105/X	Washer , Spring, under Nuts		4	
C.2325	Stud , in Head, for fixing of Exhaust Manifolds	F.12	16	
NN.131/Q	Nut (Bronze) securing Exhaust Manifolds		16	
FG.105/X	Washer , Spring, under Nuts		16	

CYLINDER HEAD

Part No.	Description	Plate No.	No. per Unit	Remarks
C.8137	Stud for fixing of Inlet Manifold (No. 1 top)	F.13	1	} NOTE : STUDS ARE NUMBERED FROM FRONT END OF CYLINDER HEAD
C.2375	Stud for fixing of Inlet Manifold (Nos. 5, 8 top and 2, 5 bottom)	F.14	4	
C.7488	Stud for fixing of Inlet Manifold and Carburetters (Nos. 3, 4, 6, 7 top and 3, 4, 6, 7 bottom)	F.15	8	
C.8138	Stud for fixing of Inlet Manifold and Air Cleaner Supports (No. 1 bottom and 2, 9 top)	F.16	3	
C.7624	Stud for fixing of Inlet Manifold (Nos. 8, 9 bottom)	F.17	2	
C.4202/2	Nut on Inlet Manifold Studs		18	
FG.105/X	Washer, Spring, under Nuts		18	
C.6727/1	Stud, in front end of Cylinder Head for fixing of Camshaft Covers	F.18	6	
C.2328	Nut, Dome, securing Cylinder Head to Block	F.19	14	
C.2385	"D" Washer under Cylinder Head Dome Nuts	F.20	10	
FW.207/T	Washer, Plain, under Cylinder Head Dome Nuts		4	
C.317	Plug, Core, for Exhaust face of Cylinder Head	F.21	2	
C.2345/1	Stud, in front face of Cylinder Head, for fixing of Breather Housing	F.22	4	
C.9733	Plug, blanking aperture for Windscreen Washer adaptor		1	
C.2296/4	Washer (Copper) on Plug		1	
Assembly 315	GASKETS PACKAGE FOR DECARBONISING ENGINE		1	
C.8248	INLET VALVE	F.23	6	
C.8313	EXHAUST VALVE	F.24	6	USED ONLY WITH STANDARD HEAD
C.7708	EXHAUST VALVE	F.24	6	USED ONLY WITH SPECIAL EQUIPMENT HEAD
C.7137	VALVE SPRING, INNER	F.25	12	

CYLINDER HEAD

Part No.	Description	Plate No.	No. per Unit	Remarks
C.7136	VALVE SPRING, OUTER	F.26	12	
C.2181	Seat for Valve Springs	F.27	12	
C.2159	Collar at top of Valve Stems	F.28	12	
C.430	Cotter, retaining Collar to Valve Stems	F.29	24	

C.7312	TAPPET	F.30	12	
--------	---------------	------	----	--

VALVE ADJUSTING PADS

C.2243/A	Pad, Adjusting (.085" thick)	F.31	12
C.2243/B	Pad, Adjusting (.086" thick)	F.31	12
C.2243/C	Pad, Adjusting (.087" thick)	F.31	12
C.2243/D	Pad, Adjusting (.088" thick)	F.31	12
C.2243/E	Pad, Adjusting (.089" thick)	F.31	12
C.2243/F	Pad, Adjusting (.090" thick)	F.31	12
C.2243/G	Pad, Adjusting (.091" thick)	F.31	12
C.2243/H	Pad, Adjusting (.092" thick)	F.31	12
C.2243/I	Pad, Adjusting (.093" thick)	F.31	12
C.2243/J	Pad, Adjusting (.094" thick)	F.31	12
C.2243/K	Pad, Adjusting (.095" thick)	F.31	12
C.2243/L	Pad, Adjusting (.096" thick)	F.31	12
C.2243/M	Pad, Adjusting (.097" thick)	F.31	12
C.2243/N	Pad, Adjusting (.098" thick)	F.31	12
C.2243/O	Pad, Adjusting (.099" thick)	F.31	12
C.2243/P	Pad, Adjusting (.100" thick)	F.31	12
C.2243/Q	Pad, Adjusting (.101" thick)	F.31	12
C.2243/R	Pad, Adjusting (.102" thick)	F.31	12
C.2243/S	Pad, Adjusting (.103" thick)	F.31	12
C.2243/T	Pad, Adjusting (.104" thick)	F.31	12
C.2243/U	Pad, Adjusting (.105" thick)	F.31	12
C.2243/V	Pad, Adjusting (.106" thick)	F.31	12
C.2243/W	Pad, Adjusting (.107" thick)	F.31	12
C.2243/X	Pad, Adjusting (.108" thick)	F.31	12
C.2243/Y	Pad, Adjusting (.109" thick)	F.31	12
C.2243/Z	Pad, Adjusting (.110" thick)	F.31	12

SELECTIVE SIZES.
Choose the Pad of the desired thickness.

C.5717	INLET CAMSHAFT	F.32	1	
--------	-----------------------	------	---	--

CYLINDER HEAD

Part No.	Description	Plate No.	No. per Unit	Remarks
C.5718	EXHAUST CAMSHAFT	F.33	1	
C.2288	Bearing for Camshafts	F.34	16 halves	
C.2176	Shaft , in end of Camshaft, for connection of Rev. Counter Cable	F.35	1	
C.2428	Seal , Oil, on Shaft	F.36	1	
C.2324	Oil Thrower at rear end of Camshafts	F.37	2	
NS.137/3D	Screw , Set, securing Oil Thrower to Inlet Camshaft		1	
FW.106/E	Washer (Copper) on Setscrew		1	
C.7185	COVER FOR CAMSHAFT, R.H.	F.38	1	} FITTED ONLY TO STANDARD CYLINDER HEAD.
C.7186	COVER FOR CAMSHAFT, L.H.	F.39	1	
C.9738	COVER FOR CAMSHAFT, R.H.		1	} FITTED ONLY TO SPECIAL EQUIPMENT CYLINDER HEAD
C.9739	COVER FOR CAMSHAFT, L.H.		1	
C.6735	Gasket , between Covers and Cylinder Head	F.40	2	
C.2312	Seal-Ring , at rear end, between Covers and Cylinder Head	F.41	2	
C.2327	Nut , Dome, securing Covers to Cylinder Head	F.42	22	
FW.104/E	Washer (Copper) under Nuts		22	
C.1022	OIL FILLER CAP ON L.H. CAMSHAFT COVER	F.43	1	
C.419	Washer (Fibre) on Filler Cap	F.44	1	
C.9099	BADGE, ON CAMSHAFT COVERS, FOR "C" TYPE CYLINDER HEAD		2	REQUIRED ONLY WHEN SPECIAL EQUIPMENT HEAD IS FITTED.

CYLINDER HEAD

Part No.	Description	Plate No.	No. per Unit	Remarks
C.2153/1	ADAPTOR FOR REV. COUNTER CABLE AT L.H. REAR OF CYLINDER HEAD	F.45	1	
C.2154/1	FLANGED SEALING PLUG AT R.H. REAR OF CYLINDER HEAD	F.46	1	
C.2289	Gasket for Rev. Counter Adaptor and Sealing Plug	F.47	2	
C.7134/2	Screw, Set, securing Adaptor and Sealing Plug to Cylinder Head		4	
FW.104/E	Washer (Copper) on Setscrews		4	
C.5849	PIPE, FROM OIL GALLERY ON CYLINDER BLOCK TO REAR OF CYLINDER HEAD	F.48	1	
C.5846	Bolt, Banjo, securing Oil Pipe to Head and Block	F.49	3	
C.4146	Washer (Copper) at each side of Banjo	F.50	6	
C.2389	FRONT COVER AND BREATHER HOUSING	F.51	1	
C.2391	Pipe in Cover	F.52	1	
C.2390	Baffle behind Cover	F.53	1	
C.2227	Gasket, front and rear of Baffle	F.54	2	
C.2327	Nut, Dome, securing Cover	F.55	4	
FG.104/X	Washer, Spring, under Nuts		4	
C.2485/1	FLEXIBLE PIPE FOR BREATHER ON FRONT COVER	F.56	1	
C.2905/3	Clip (Cheyney 1A) securing Flexible Pipe to Tube in Front Cover	F.57	1	
C.1040/21	Clip (Lucas 900401) securing Flexible Pipe at bottom	F.58	1	
NS.125/4D	Screw, Set, securing bottom Clip		1	
NN.125/L	Nut on Setscrews		1	
C.724	Washer, Shakeproof, under Nut		1	

CYLINDER HEAD

Part No.	Description	Plate No.	No. per Unit	Remarks
C.2213	EXHAUST MANIFOLD, FRONT	F.59	1	
C.2214	EXHAUST MANIFOLD, REAR	F.60	1	
C.2369	Stud in Outlet flanges of Manifolds, for attachment of Exhaust Down Pipes	F.61	8	
NN.137/Q	Nut (Bronze) securing Exhaust Pipes to Manifolds		8	
FG.106/X	Washer , Spring under Nuts		8	
C.2318	Gasket , between Exhaust Manifolds and Cylinder Head	F.62	2	
C.495	Gasket , between Outlet flanges and Exhaust Down Pipes	F.63	2	
C.7462	INLET MANIFOLD	F.64	1	
C.2384	Welch Washer at each end of Inlet Manifold		2	
C.5195	Plug (Chrome) on front face of Inlet Manifold	F.65	2	
C.799	Plug (Brass) underneath Inlet Manifold	F.66	1	
C.2296/1	Washer (Copper) on Plug	F.67	1	
C.7367	Stud , in Inlet Manifold, for attachment of Water Outlet Pipe	F.68	1	
C.4202/2	Nut , securing Water Outlet Pipe		1	
FG.105/X	Washer , Spring, under Nut		1	
C.9621	Adaptor , in Inlet Manifold, for attachment of Thermometer Gauge	F.69	1	
C.7619	Gasket , between Inlet Manifold and Cylinder Head	F.70	1	
C.7463	WATER OUTLET PIPE FOR INLET MANIFOLD	F.71	1	FOR USE WHEN RADIATORS C.10287 OR C.7523 ARE FITTED.
C.9619	WATER OUTLET PIPE FOR INLET MANIFOLD		1	FOR USE WHEN RADIATOR C.9616 IS FITTED.
C.4985	Gasket , between Outlet Pipe and Manifold	F.72	1	
C.3731/1	THERMOSTAT IN WATER OUTLET PIPE (SMITH X.43570/5) (OPENING TEMPERATURE 70° to 75°C.)	F.73	1	STANDARD FITMENT.
C.7105	THERMOSTAT IN WATER OUTLET PIPE (SMITH X.43605/3) (OPENING TEMPERATURE 83° to 87°C.)	F.73	1	ALTERNATIVE TO C.3731/1.

CYLINDER HEAD

Part No.	Description	Plate No.	No. per Unit	Remarks
C.2474	THERMOSTAT, AT TOP OF INLET MANIFOLD, FOR CARBURETTER AUTOMATIC CHOKE	F.74	1	
C.2475	Gasket, between Thermostat and Inlet Manifold	F.75	1	
C.7134/1			3	
C.723/A			3	
C.7440	STARTING PIPE ASSEMBLY BETWEEN INLET MANIFOLD AND CARBURETTER	F.76	1	
C.7469	Gasket, under flange of Starting Pipe	F.77	1	
C.7367			2	
C.4202/2			2	
FG.105/X			2	
C.7469	Stud, in Inlet Manifold, for attachment of Starting Pipe	F.78	2	
C.4202/2			2	
FG.105/X	Nut, securing Starting Pipe		2	
	Washer, Spring, under Nuts		2	
C.4204	ANTI-BLOW-BACK VALVE IN STARTING PIPE	F.79	1	
C.7470	Spring, Tension, for Anti-Blow-Back Valve	F.80	1	
C.8455			Sleeve over Tension Spring	F.81
C.4380	SPARKING PLUG (CHAMPION L.10.S.)	F.82	6	FOR 7:1 COMPRESSION RATIO ENGINES.
C.5634	SPARKING PLUG (CHAMPION N.8.B.)	F.82	6	FOR 8:1 COMPRESSION RATIO ENGINES.
C.2460	SPARKING PLUG (CHAMPION NA.8.)	F.82	6	FOR 8:1 COMPRESSION RATIO ENGINES WHEN "C" TYPE HEAD IS FITTED.

CYLINDER HEAD

Part No.	Description	Plate No.	No. per Unit	Remarks
HIGH TENSION LEADS				
C.4976	Lead, H.T. to No. 1 Plug		1	
C.4977	Lead, H.T. to No. 2 Plug		1	
C.4978	Lead, H.T. to No. 3 Plug		1	
C.4979	Lead, H.T. to No. 4 Plug		1	
C.4980	Lead, H.T. to No. 5 Plug		1	
C.4981	Lead, H.T. to No. 6 Plug		1	
C.2437	Lead, H.T. to Coil		1	
C.5479	TERMINAL FOR HIGH TENSION LEADS	F.83	6	
C.2451	CONDUIT, ALONG CENTRE OF CYLINDER HEAD, ENCLOSING H.T. LEADS	F.84	1	
C.4983	SPACER FOR H.T. LEADS (THICK)	F.85	2	
C.4984	SPACER FOR H.T. LEADS (THIN)	F.86	3	
C.4982	CLIP AROUND SPACER	F.87	1	

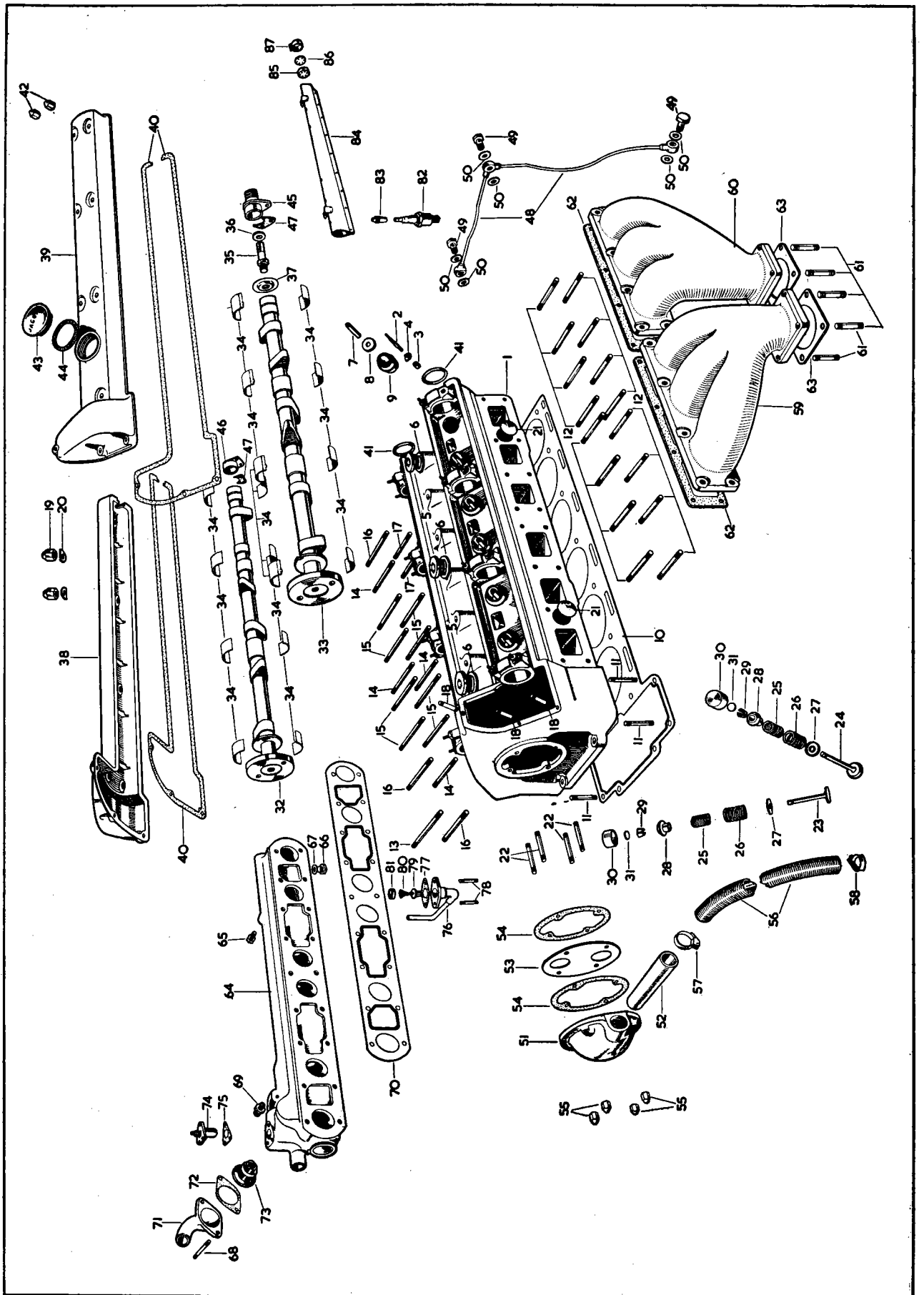

PLATE F

TIMING GEAR

Part No.	Description	Plate No.	No. per Unit	Remarks
C.2169	SPROCKET FOR CAMSHAFTS	G.1	2	
C.2329	Plate, Adjusting, inside Camshaft Sprockets	G.2	2	} SUPPLIED ONLY AS AN ASSEMBLY TO PART NO. PG.569.
C.2191	Plate, Clamping, on Adjusting Plates	G.3	2	
C.2193	Circlip, retaining Adjusting Plates in Sprockets	G.4	2	
C.2178	Guide-Pin through Adjusting Plates	G.5	2	
C.2194	Star-Washer, on Guide-Pins, behind Adjusting Plates	G.6	2	
C.2261	Circlip, retaining Guide Pins	G.7	2	
C.2310	Screw, Set, securing Adjusting Plates and Sprockets to Camshafts	G.8	4	
C.4128/1	FRONT MOUNTING BRACKET FOR TIMING GEAR	G.9	1	
C.4129	REAR MOUNTING BRACKET FOR TIMING GEAR	G.10	1	
C.2182	Stud, for fixing of Front and Rear Mounting Brackets	G.11	4	
NN.125/L	Nut, securing Brackets on Studs	G.12	4	
C.724	Washer, Shakeproof, under Nuts	G.13	4	
C.7424	Bolt (Long) securing Mounting Bracket to Cylinder Block	G.14	4	
C.2166	Bolt (Short) securing Rear Mounting Bracket to Cylinder Block	G.15	2	
C.740	Washer, Shakeproof, on Bolts	G.16	6	
C.2308	IDLER SPROCKET (21 TEETH) BETWEEN MOUNTING BRACKETS	G.17	1	
C.2319	Bush, for Idler Sprocket		1	
C.2177	ECCENTRIC SHAFT, THROUGH IDLER SPROCKET FOR ADJUSTMENT OF UPPER TIMING CHAIN	G.18	1	
C.2282	Plug, in end of Eccentric Shaft	G.19	1	

TIMING GEAR

Part No.	Description	Plate No.	No. per Unit	Remarks
C.4404	ADJUSTMENT PLATE, ON FACE OF FRONT MOUNTING BRACKET, FOR MICRO-ADJUSTMENT OF UPPER TIMING CHAIN	G.20	1	
C.3338/4	Nut, securing Adjustment Plate to Eccentric Shaft	G.21	1	
C.742	Washer, Shakeproof, under Nut	G.22	1	
C.4405	Pin, Plunger, in Front Mounting Bracket, holding Adjustment Plate in tension	G.23	1	
C.2297	Spring, behind Plunger Pin	G.24	1	
C.2309	INTERMEDIATE SPROCKET (20 TEETH) AT BOTTOM OF UPPER TIMING CHAIN	G.25	1	
C.2307	INTERMEDIATE SPROCKET (28 TEETH) AT TOP OF LOWER TIMING CHAIN	G.26	1	
C.2320	Bush for Sprocket		1	
C.926	Key, locking Intermediate Sprockets together	G.27	1	
C.2161	SHAFT, HOLDING INTERMEDIATE SPROCKETS	G.28	1	
C.2335	Circlip retaining Shaft	G.29	1	
C.2256	TOP TIMING CHAIN	G.30	1	

TIMING GEAR

Part No.	Description	Plate No.	No. per Unit	Remarks
C.6701	DAMPER FOR UPPER TIMING CHAIN	G.31	2	
C.4127	CARRIER FOR UPPER DAMPERS	G.32	2	
C.4705	Rivet, securing Dampers to Carriers	G.33	4	
C.2255	BOTTOM TIMING CHAIN	G.34	1	
C.6819	VIBRATION DAMPER FOR LOWER TIMING CHAIN	G.35	1	
C.6818	BRACKET, MOUNTING LOWER TIMING CHAIN DAMPER	G.36	1	
C.6820	Rivet, securing Vibration Damper to Bracket	G.37	3	
NS.131/5D	Screw, Set, securing Mounting Bracket to Cylinder Block	G.38	2	
C.740	Washer, Shakeproof, on Setscrews	G.39	2	
C.5143	OIL SPRAY BRACKET FOR LOWER TIMING CHAIN	G.40	1	
C.5144	Ball, for Relief Valve in Oil Spray Bracket	G.41	1	
C.5145	Seat for Ball	G.42	1	
C.5146	Spring behind Ball	G.43	1	
C.2300	Gasket, behind Oil Spray Bracket and Cylinder Block	G.44	1	
NS.125/5D	Screw, Set, securing Oil Spray Bracket to Cylinder Block	G.45	2	
C.724	Washer, Shakeproof, on Setscrews	G.46	2	

TIMING GEAR

Part No.	Description	Plate No.	No. per Unit	Remarks
C.6728	GUIDE BRACKET FOR TIMING CHAIN TENSIONER	G.47	1	
C.8245	TIMING CHAIN TENSIONER BLADE	G.48	1	
C.4101	SPRING FOR CHAIN TENSIONER BLADE	G.49	1	
C.6729	Retainer Assembly, in slot of Guide Bracket, anchoring Spring and Tensioner Blade	G.50	1	
C.6732	Pin, securing Spring and Tensioner Blade to Oil Spray Bracket	G.51	1	
C.2238/1	FRONT TIMING COVER		1	} Fitted from Eng. No. G.1001 to G.1907.
C.4466	Gasket, between Timing Cover and Cylinder Block		2 halves	
C.8614	FRONT TIMING COVER	G.52	1	} Fitted to Eng. No. G.1908 and subs.
C.8615	Gasket, between Timing Cover and Cylinder Block	G.53	2 halves	
C.2306	Seal, Oil, between Timing Cover and Crankshaft		1	} Fitted from Eng. No. G.1001 to G.1907. } Fitted to Eng. No. G.1908 and subs.
C.8593	Seal, Oil, between Timing Cover and Crankshaft	G.54	1	
NB.131/9D	Bolt, securing Timing Cover to Block	G.55	1	
NB.131/14D	Bolt, securing Timing Cover to Block	G.56	1	
NB.131/16D	Bolt, securing Dynamo Adjusting Link, and Timing Cover to Block	G.57	1	
NB.131/21D	Bolt, securing Timing Cover to Block	G.58	4	
NB.131/26D	Bolt, securing Timing Cover to Block	G.59	2	
FG.105/X	Washer, Spring, on Bolts	G.60	9	
C.2184	Stud, in Front Cover, for attachment of Water Pump	G.61	3	
C.2183	Stud, in Front Cover, for attachment to Cylinder Head	G.62	2	
C.2185	Stud, in Front Cover, for attachment to Oil Sump	G.63	4	
NN.131/L	Nut, on Studs	G.64	9	
FG.105/X	Washer, Spring, under Nuts	G.65	9	
NB.137/11D	Bolt, securing Front Cover to Block	G.66	1	
NB.137/13D	Bolt, securing Front Cover to Block	G.67	4	
FG.106/X	Washer, Spring, on Bolts	G.68	5	
C.2286	Link, for attachment and adjustment of Dynamo	G.69	1	
C.2155	Piece, Distance, behind Link	G.70	1	

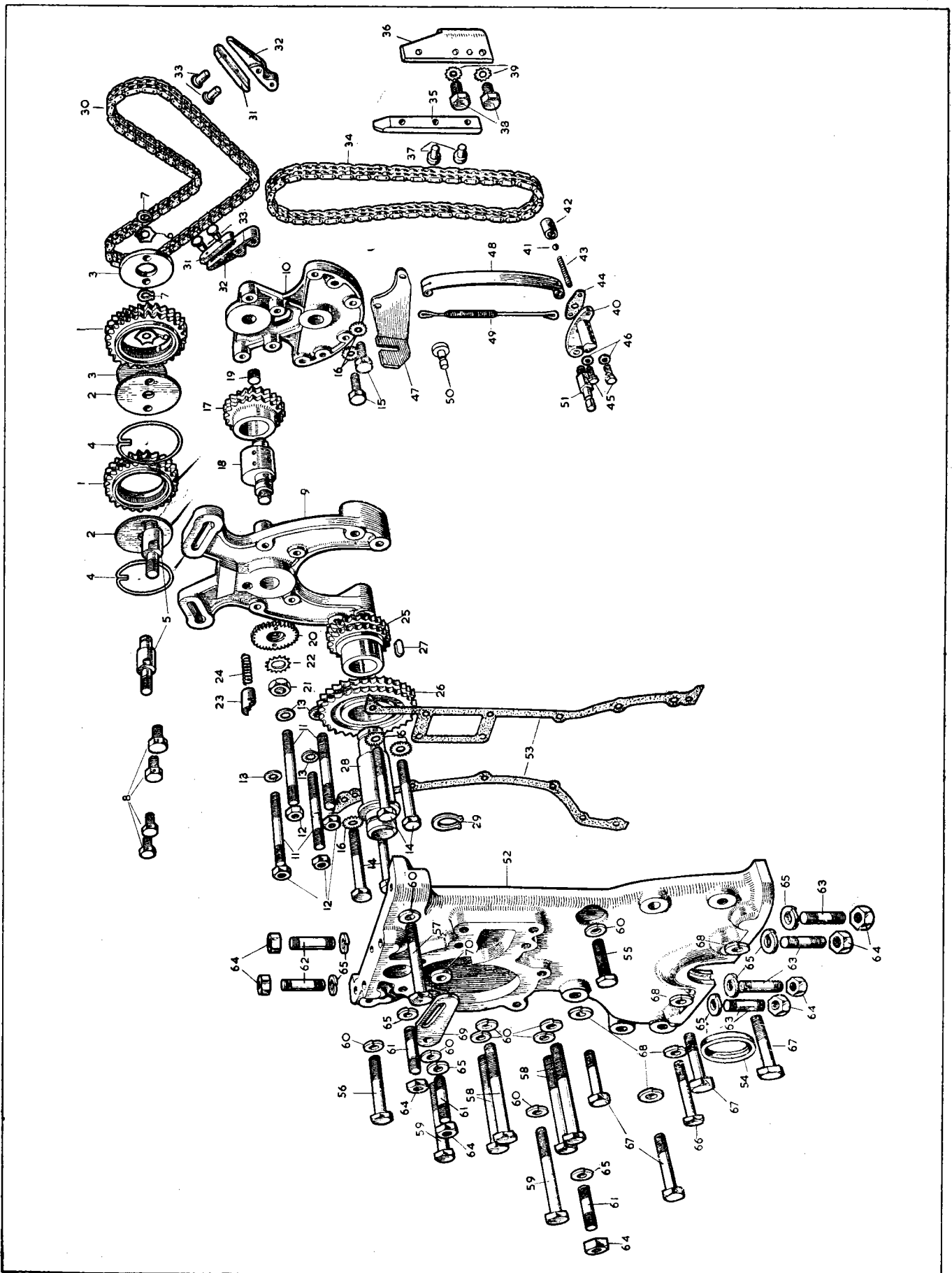

PLATE G