

CLUTCH UNIT

Part No.	Description	Plate No.	No. per Unit	Remarks
C.8456	CLUTCH UNIT COMPLETE (BB. 10/98C) (COMPRISING COVER ASSEMBLY AND DRIVEN PLATE ASSEMBLY)	M.1	1	
BB.45696/14	CLUTCH COVER ASSEMBLY		1	
BB.45616	Cover only	M.2	1	
BB.44780	Spring, Thrust (Yellow)	M.3	12	
BB.45764	Plate, Pressure	M.4	1	
BB.48992	Lever, Release	M.5	3	
BB.40968	Plate, Release Lever	M.6	1	
BB.40015	Retainer, Release Lever	M.7	3	
BB.42606	Strut, Release Lever	M.8	3	
BB.42605	Eyebolt, Release Lever	M.9	3	
BB.42604	Pin through Eyebolt	M.10	3	
BB.40020	Nut on Eyebolt	M.11	3	
BB.45577	Spring, Anti-Rattle	M.12	3	
BB.48444	RELEASE BEARING ASSEMBLY		1	
BB.48443	Release Bearing and Cup Assembly	M.13	1	
BB.41628	Retainer, securing Cup to Clutch Operating Fork	M.14	2	
C.8401	DRIVEN PLATE ASSEMBLY (BB.47627/46)		1	
BB.46663	Facings Package (consisting of Clutch Linings and Rivets)		1	FOR RENEWAL OF DRIVEN PLATE LININGS.
NB.137/6.5D	Screw, Set, securing Clutch Unit to Flywheel	M.15	6	
FG.106/X	Washer, Spring, on Setscrews	M.16	6	

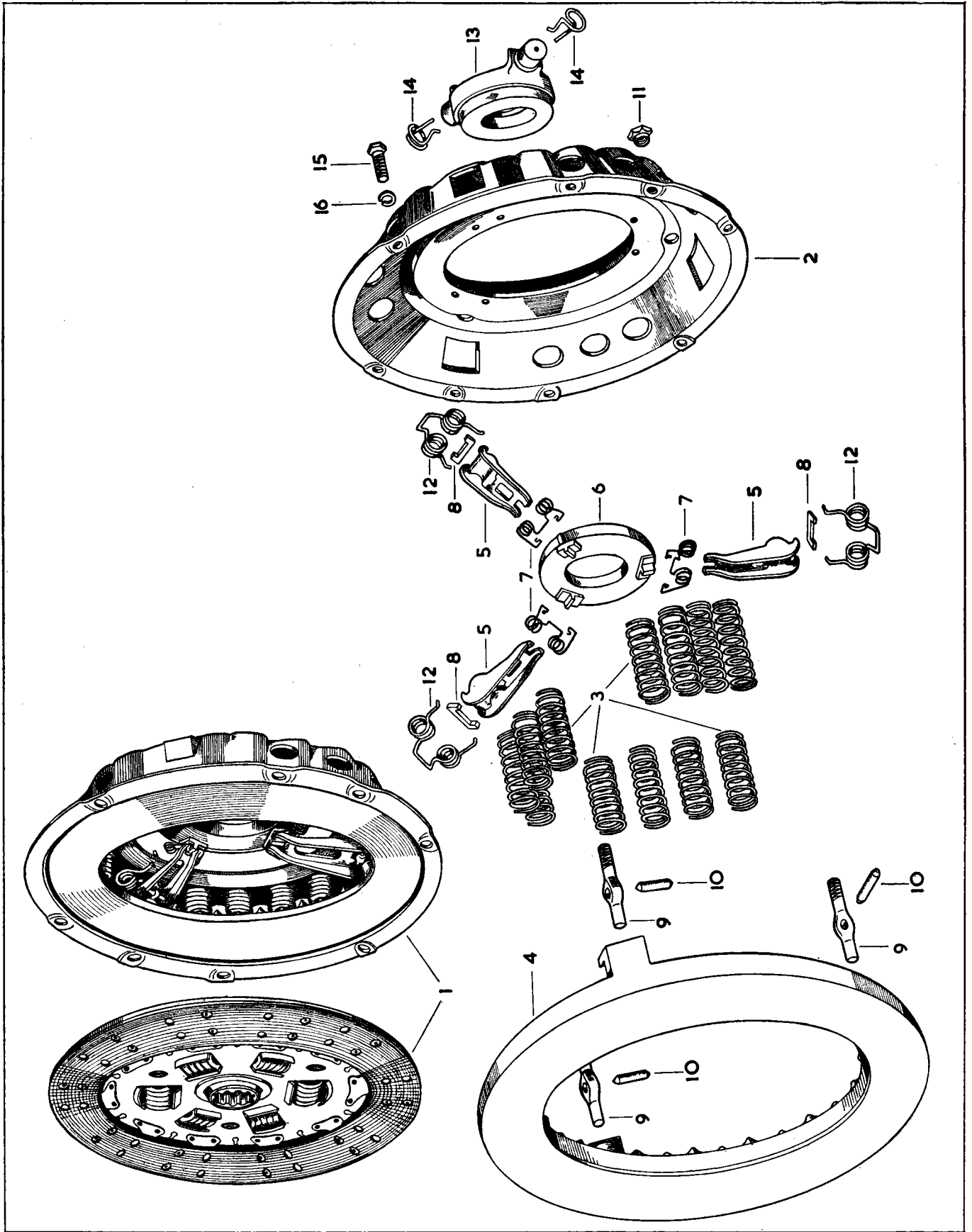

CLUTCH CONTROLS

Part No.	Description	Plate No.	No. per Unit	Remarks
C.5068	CLUTCH HOUSING	N.1	1	
FS.107/13D	Screw, Set, securing Clutch Housing to Gearbox	N.2	8	
C.587	Plate, locking Setscrews	N.3	2	
C.5073	Plate, locking Setscrews	N.4	2	
NB.137/23D	Bolt, securing Clutch Housing to Cylinder Block		7	
C.10078	Stud, for fixing of Clutch Housing to Cylinder Block		2	
NN.137/L	Nut on Studs		2	
C.726	Washer, Shakeproof, on Bolts and Studs		9	
C.584	Bush, in Clutch Housing, for Operating Shaft	N.5	2	
C.1221/I	Pin, Split, in hole at bottom of Clutch Housing		1	
C.5072	COVER PLATE AT BACK OF CLUTCH HOUSING	N.6	1	
CS.125/4D	Screw, Set, securing Cover Plate		4	
C.724	Washer, Shakeproof, on Setscrews		4	
C.4795	SUPPORT BRACKET AT R.H. SIDE OF CLUTCH HOUSING	N.7	1	
C.4796	SUPPORT BRACKET AT L.H. SIDE OF CLUTCH HOUSING		1	
NB.131/9D	Bolt, securing Support Brackets to Cylinder Block		4	
NN.131/L	Nut on Bolts		4	
FG.105/X	Washer, Spring, under Nuts		4	
NB.137/25D	Bolt, securing Support Brackets to Cylinder Block		4	
NB.137/27D	Bolt, securing Support Brackets to Cylinder Block		2	
NN.137/L	Nut on Bolts		6	
FG.106/X	Washer, Spring, under Nuts		6	
C.7508	BRACKET, BEHIND R.H. SIDE OF CLUTCH HOUSING, FOR PEDAL STOP	N.8	1	FITTED TO R.H. DRIVE CARS ONLY
NS.125/15D	Screw, Set, for adjustment of Clutch Pedal Stop	N.9	1	
NN.125/L	Nut, locking, Setscrew for adjustment	N.10	2	

CLUTCH CONTROLS

Part No.	Description	Plate No.	No. per Unit	Remarks
C.7812	BRACKET, BEHIND L.H. SIDE OF CLUTCH HOUSING, FOR PEDAL STOP		1	FITTED TO L.H. DRIVE CARS ONLY.
NS.125/15D NN.125/L	Screw, Set, for adjustment of Clutch Pedal Stop Nut, locking Setscrew after adjustment		1 2	
C.2429	CLUTCH OPERATING SHAFT	N.11	1	
CB.131/18D C.725	Bolt, locating Operating Shaft in Clutch Housing Washer, Shakeproof, on Bolt		1 1	
C.2483	LEVER ON OPERATING SHAFT	N.12	1	
C.568 C.3262	Pin (Tapered) securing Lever on Shaft Wire, locking Pin to Shaft	N.13 N.13	1 1	
C.9780	FORK, ON CLUTCH OPERATING SHAFT, OPERATING RELEASE BEARING	N.14	1	
C.568 C.3262	Pin (Tapered) securing Fork on Operating Shaft Wire, locking Pin to Shaft	N.15	1 1	
C.7584	CLUTCH PEDAL	N.16	1	FITTED TO OPEN AND DROP HEAD COUPE ONLY.
C.8877	CLUTCH PEDAL		1	FITTED TO R.H. DRIVE FIXED HEAD COUPE ONLY.
C.8878	CLUTCH PEDAL		1	FITTED TO L.H. DRIVE FIXED HEAD COUPE ONLY.
C.7588	Distance Piece, between boss of Pedal and Chassis Frame		1	FITTED TO L.H. DRIVE CARS ONLY.
NB.131/16D NN.131/L C.725	Bolt, securing Clutch Pedal to Shaft Nut on Bolt Washer, Shakeproof, under Nut	N.17 N.18 N.19	1 1 1	

CLUTCH CONTROLS

Part No.	Description	Plate No.	No. per Unit	Remarks
C.7582	SHAFT, SUPPORTING CLUTCH PEDAL	N.20	1	FITTED TO R.H. DRIVE OPEN AND DROP HEAD COUPE ONLY.
C.7583	SHAFT, SUPPORTING CLUTCH PEDAL		1	FITTED TO L.H. DRIVE OPEN AND DROP HEAD COUPE ONLY.
C.8879	SHAFT, SUPPORTING CLUTCH PEDAL		1	FITTED TO R.H. DRIVE FIXED HEAD COUPE ONLY.
C.9134	SHAFT, SUPPORTING CLUTCH PEDAL		1	FITTED TO L.H. DRIVE FIXED HEAD COUPE ONLY.
C.757	Key (Woodruff 90) locating Pedal on Shaft	N.21	1	
C.3256	Spring, (Outer), on Shaft	N.22	1	
C.3295	Washer, on Shaft, at each end of Outer Spring	N.23	2	1 only required for R.H. Drive Open and Drop Head Coupe.
C.3257	Sealing Ring (Small) adjacent to Outer Spring	N.24	1	
C.3255	Bearing (Spherical) between Sealing Rings	N.25	1	
C.3258	Sealing Ring (Large) adjacent to Spherical Bearing	N.26	1	
C.2420	Washer, Special, behind Large Sealing Ring	N.27	1	
L.104/11U	Pin, Split, at end of Pedal Shaft	N.28	1	
C.3260	LEVER ON CLUTCH PEDAL SHAFT	N.29	1	
C.757	Key (Woodruff 90) locating Lever on Shaft	N.30	1	
NB.131/11D	Bolt, Clamp, securing Lever to Shaft	N.31	1	
NN.131/L	Nut on Bolt	N.32	1	
FG.105/X	Washer, Spring, under Nut	N.33	1	
C.2423	ADJUSTING ROD, BETWEEN LEVER ON PEDAL SHAFT AND LEVER ON CLUTCH OPERATING SHAFT	N.34	1	
J.105/13S	Pin, Clevis, securing Adjusting Rod to Lever on Pedal Shaft	N.35	1	
FW.105/T	Washer, Plain, on Clevis Pin	N.36	1	
L.103/7U	Pin, Split, retaining Clevis Pin in Lever	N.37	1	
C.2482	Nut, Barrel, on Rod, for adjustment of Clutch Pedal	N.38	1	
C.5180	Trunnion, on Adjusting Rod and in fork of Clutch Operating Lever	N.39	1	
C.4165	Spring, behind Trunnion	N.40	1	
FW.105/T	Washer, Plain, behind Spring	N.41	1	
L.103/7U	Pin, Split, retaining Spring on Adjusting Rod	N.42	1	

CLUTCH CONTROLS

Part No.	Description	Plate No.	No. per Unit	Remarks
C.3255	SPHERICAL BEARING FOR CLUTCH HOUSING	N.43	1	
C.3321	Spring, Inner, behind Spherical Bearing	N.44	1	
C.3267	HOUSING, SECURING SPHERICAL BEARING TO CLUTCH HOUSING	N.45	1	
CS.131/5D C.725	Screw, Set, securing Bearing Housing to Clutch Housing Washer, Shakeproof, on Setscrews	N.46 N.47	2 2	
C.3323	GAITER, ON PEDAL SHAFT, OVER HOUSING FOR SPHERICAL BEARING	N.48	1	
C.6913	STEM AND PLATE ASSEMBLY FOR CLUTCH PEDAL	N.49	1	FITTED TO OPEN AND DROP HEAD COUPE ONLY.
C.8880	STEM AND PLATE ASSEMBLY FOR CLUTCH PEDAL		1	FIXED TO R.H. DRIVE FIXED HEAD COUPE ONLY.
C.8883	STEM AND PLATE ASSEMBLY FOR CLUTCH PEDAL		1	FITTED TO L.H. DRIVE FIXED HEAD COUPE ONLY.
NB.131/10D NN.131/L C.740	Bolt, securing Stem and Plate to Clutch Pedal Nut on Bolt Washer, Shakeproof, under Nut		1 1 1	

CLUTCH CONTROLS

Part No.	Description	Plate No.	No. per Unit	Remarks
792	RUBBER PAD ON PEDAL PLATE	N.50	1	FITTED TO OPEN AND DROP HEAD COUPE ONLY.
C.9934	RUBBER PAD ON PEDAL PLATE		1	FITTED TO FIXED HEAD COUPE ONLY.
C.3318	RETURN SPRING FOR CLUTCH PEDAL		1	FITTED TO ALL R.H. DRIVE CARS AND TO L.H. DRIVE FIXED HEAD COUPE. ALSO TO THE FOLLOWING L.H. DRIVE OPEN AND DROP HEAD COUPE : Chassis No. 810001 to 810429. 817001 to 817050.
C.4801	RETURN SPRING FOR CLUTCH PEDAL	N.51	1	FITTED TO L.H. DRIVE OPEN AND DROP HEAD COUPE. At Chassis No. 810430 and subs. 817051 and subs.
C.5179	Anchor Pin, for Return Spring		1	FITTED TO FIXED HEAD COUPE ONLY.
C.8166	RUBBER GROMMET, ON TOEBOARD, SEALING CLUTCH PEDAL STEM	N.52	1	} FITTED TO OPEN AND DROP HEAD COUPE ONLY.
C.8298	Ferrule (Plastic) Inside Rubber Grommet	N.53	1	
C.8299	FELT SEAL ON CLUTCH PEDAL STEM UNDER TOEBOARD	N.54	1	FITTED TO ALL MODELS.
C.8301	Circlip, retaining Felt Seal In position on Pedal Stem (Terry 1359)	N.55	1	FITTED TO ALL MODELS.

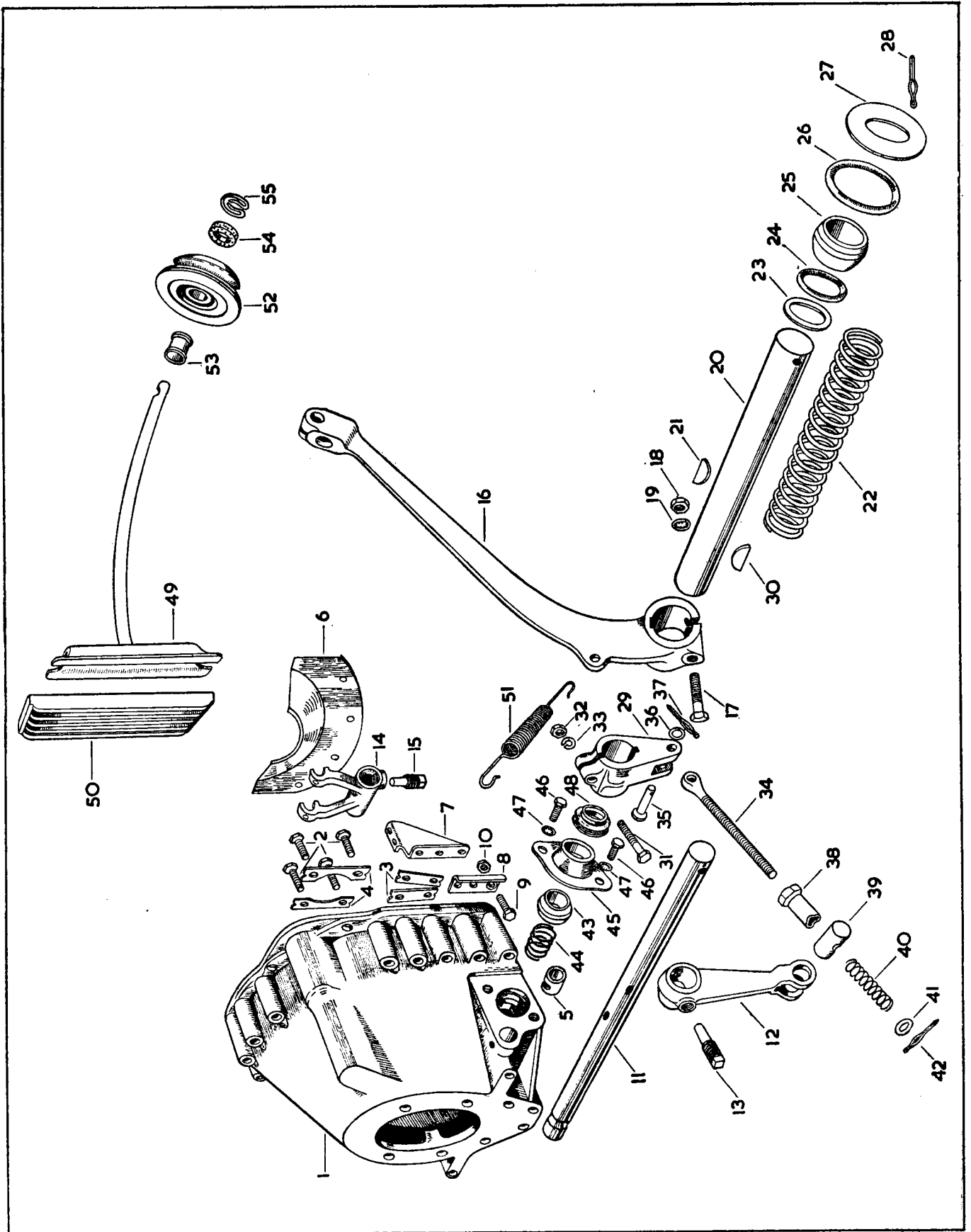

PLATE N