

# CHASSIS

Part No.	Description	Plate No.	No. per Unit	Remarks
C.8300	<b>CHASSIS FRAME ASSEMBLY</b>	AE.1	1	
C.8408	<b>Bracket Assembly</b> for mounting of Bonnet Lock		1	
C.7505	<b>Cross Member, Front</b>		1	
C.7506	<b>Insert</b> for Front Cross Member		1	
C.8443	<b>Plate, Tapped, for fixing of Sump Deflector at front</b>		1	
C.4291	<b>Plate, Tapped, for fixing of Sump Deflector to Side Members</b>		2	
C.8451	<b>Plate, Tapped, for mounting of Front Silencer</b>		2	
C.7591	<b>Plate, Tapped, for fixing of Front Bumper</b>		6	
C.7980	<b>Bracket Assembly</b> for mounting of L.H. Front Suspension Unit		1	
C.7981	<b>Bracket Assembly</b> for mounting of R.H. Front Suspension Unit		1	
C.3055	<b>Bracket</b> for mounting of Anti-Roll Bar		2	
C.7807	<b>Bracket Assembly</b> for mounting of Rack and Pinion Steering Unit		2	
C.8807	<b>Bracket</b> for mounting of Brake Master Cylinder on R.H. side		1	
C.8294	<b>Bracket</b> for mounting of Brake Master Cylinder on L.H. side		1	
C.7515	<b>Bracket Assembly</b> for mounting of Brake Pedal on L.H. side		1	
C.7767	<b>Bracket Assembly</b> for mounting of Brake Pedal on R.H. side		1	
C.6621	<b>Bracket, on R.H. Side Member, for fixing of Front Engine Mounting</b>		1	
C.6622	<b>Bracket, on L.H. Side Member, for fixing of Front Engine Mounting</b>		1	
C.7602	<b>Bracket</b> for L.H. Radiator Stay		1	
C.7659	<b>Bracket</b> for R.H. Radiator Stay		1	
C.5779	<b>Bracket No. 1, for mounting of Body to R.H. Side Member</b>		1	
C.5780	<b>Bracket No. 1, for mounting of Body to L.H. Side Member</b>		1	
C.5781	<b>Bracket No. 2, for mounting of Body to R.H. Side Member</b>		1	
C.5782	<b>Bracket No. 2, for mounting of Body to L.H. Side Member</b>		1	
C.7829	<b>Plate Assembly, on Rear Extensions of Chassis Frame, for No. 3 mounting of Body</b>		2	
C.7524	<b>Bracket Assembly, on R.H. Side Member, for fixing of Rear Engine Mounting</b>		1	
C.7528	<b>Bracket Assembly, on L.H. Side Member, for fixing of Rear Engine Mounting</b>		1	
C.7928	<b>Bracket, on Side Members, for fixing of Wing Valances</b>		2	
C.3866	<b>Bracket, outside Side Member, for fixing of Wing Valances</b>		1	
C.8378	<b>Cross Member Assembly, Centre</b>		1	
C.8319	<b>Bracket Assembly</b> at rear of Centre Cross Member, for Handbrake Support		1	
C.7734	<b>Extension Assembly, R.H., at rear of Chassis Frame</b>		1	
C.7735	<b>Extension Assembly, L.H., at rear of Chassis Frame</b>		1	
C.7740	<b>Bracket</b> for mounting of R.H. rear Shock Absorber		1	
C.7741	<b>Bracket</b> for mounting of L.H. rear Shock Absorber		1	
C.3207	<b>Bracket, Support, outside Extensions, for Rebound Stop</b>		2	
C.8336	<b>Bracket, mounting rear Silencer, R.H.</b>		1	
C.8337	<b>Bracket, mounting rear Silencer, L.H.</b>		1	
C.8328	<b>Cross Member, Rear</b>		1	
C.8329	<b>Tube, supporting Road Spring Shackles</b>		2	
C.8330	<b>Plate, for Shackle Support</b>		2	
C.8331	<b>Bracket, Support, Outer</b>		2	
C.8332	<b>Bracket Assembly</b> for mounting of Petrol Tank		2	
C.3649	<b>Bracket</b> for mounting of Petrol Pump		1	
C.8309	<b>Bracket, at rear of Extension, for mounting of Exhaust Tail Pipes</b>		2	
C.7758	<b>Tie Bar Assembly</b> across Rear Extension		1	
C.3413	<b>Bracket, R.H. Outer, for Rear Spring</b>		1	
C.3414	<b>Bracket, L.H. Outer, for Rear Spring</b>		1	
C.3415	<b>Bracket, Inner, for Rear Spring</b>		2	

# CHASSIS

Part No.	Description	Plate No.	No. per Unit	Remarks
C.10287	<b>RADIATOR BLOCK ASSEMBLY</b>		1	<b>FITTED TO FIXED HEAD COUPE ONLY.</b>
C.3455	Filler Cap on Radiator (4 lbs. pressure)		1	On Chassis No. : 804001 to 804019.
C.3521	Washer (Fibre) on Filler Cap		1	814001 to 814034.
C.7523	<b>RADIATOR BLOCK ASSEMBLY</b>		1	<b>FITTED TO FIXED HEAD COUPE ONLY.</b>
C.3455	Filler Cap on Radiator (4 lbs. pressure)		1	On Chassis No. : 804020 to 804141.
C.3521	Washer (Fibre) on Filler Cap		1	814035 to 814240. <b>ALSO FITTED TO OPEN AND DROP HEAD COUPE.</b>
				On Chassis No. : 800001 to 800036. 810001 to 811423. 807001 to 807127. 817001 to 817459.
C.9616	<b>RADIATOR BLOCK ASSEMBLY</b>	AE.2	1	<b>FITTED TO ALL MODELS.</b>
C.10289	Filler Cap on Radiator (4 lbs. pressure)	AE.3	1	At Chassis No. : 800037 and subs. 811424 and subs. 804142 and subs. 814241 and subs. 807128 and subs. 817460 and subs.
<p><b>NOTE :</b> Radiator Block C.9616 may be used to replace Radiator Block C.7523, PROVIDING Tie Bars C.9618 are all used instead of Tie Rod Assemblies C.7592 and C.7567. Radiator Block C.10287 is <b>NOT INTERCHANGEABLE</b> with either Radiator Blocks C.7523 or C.9616.</p>				
C.10288	<b>MOUNTING BRACKET AT EACH SIDE OF RADIATOR</b>		2	<b>FOR USE ONLY WHEN RADIATOR C.10287 IS USED ON FIXED HEAD COUPE.</b>
				At Chassis No. : 804001 to 804019. 814001 to 814034.

# CHASSIS

Part No.	Description	Plate No.	No. per Unit	Remarks
C.8830	<b>MOUNTING BRACKET AT EACH SIDE OF RADIATOR</b>	AE.4	2	<b>FOR USE WITH RADIATORS C.7523 OR C.9616.</b> At Chassis No. : 804020 and subs. 814035 and subs. 800001 and subs. 810001 and subs. 807001 and subs. 817001 and subs.
NN.125/L	Nut, securing Mounting Brackets to Radiator	AE.5	8	
C.724	Washer, Shakeproof, under Nuts	AE.6	8	
C.3053	Pad (Rubber) for mounting of Radiator	AE.7	4	
C.6390	Collar, through centre of Mounting Pads	AE.8	2	
BD.541/2	Washer, Special, at top of Mounting Pads	AE.9	2	
NB.137/14D	Bolt, through Mounting Pads, securing Radiator	AE.10	2	
C.3968/3	Nut, Self-Locking, on Bolts	AE.11	2	
FW.206/T	Washer, Plain, under Nuts	AE.12	2	
C.10144	<b>BRACKET, AT TOP L.H. SIDE OF RADIATOR FOR HOUSING OF BONNET PROP IN "OPEN" POSITION</b>		1	<b>FITTED TO FIXED HEAD COUPE ONLY.</b>
C.7592	<b>TIE ROD ASSEMBLY FROM RADIATOR TO L.H. SIDE OF CHASSIS FRAME</b>		1	<b>FOR USE ONLY WITH RADIATORS C.10287 AND C.7523.</b> On Chassis No. : 800001 to 800036. 810001 to 811423. 804001 to 804141. 814001 to 814240. 807001 to 807127. 817001 to 817459.
C.7567	<b>TIE ROD ASSEMBLY FROM RADIATOR TO R.H. SIDE OF CHASSIS FRAME</b>		1	
NB.131/7D	Bolt, securing Tie Rods to Radiator		2	
NN.131/L	Nut on Bolts		2	
C.725	Washer, Shakeproof, under Nuts		2	
NN.137/L	Nut, securing Tie Rods to Chassis Frame		4	
C.726	Washer, Shakeproof, under Nuts		4	
C.9618	<b>TIE BAR FROM RADIATOR TO WING VALANCES</b>	AE.13	2	<b>FOR USE WITH RADIATOR C.9616</b> At Chassis No. : 800037 and subs. 811424 and subs. 804142 and subs. 814241 and subs. 807128 and subs. 817460 and subs.
NB.131/7D	Bolt, securing Tie Bars to Radiator		2	
NS.131/5D	Screw, Set, securing Tie Bars to Chassis Frame		2	
FW.105/T	Washer, Plain, on Setscrews		2	
NN.131/L	Nut on Bolts and Setscrews		4	
C.725	Washer, Shakeproof, under Nuts		4	

# CHASSIS

Part No.	Description	Plate No.	No. per Unit	Remarks
C.7651	<b>COWL AROUND WATER PUMP FAN</b>	AE.14	1	
NS.125/4D C.724 FW.104/T	<b>Screw, Set, securing Cowl to Radiator</b> <b>Washer, Shakeproof, on Setscrews</b> <b>Washer, Plain, on Setscrews</b>		4 4 4	
C.7544	<b>HOSE FROM TOP OF RADIATOR TO WATER OUTLET PIPE ON ENGINE</b>		1	<b>FOR USE WITH RADIATORS C.10287 AND C.7523.</b> On Chassis No. : 800001 to 800036. 810001 to 811423. 804001 to 804141. 814001 to 814240. 807001 to 807127. 817001 to 817459.
C.9617	<b>HOSE FROM TOP OF RADIATOR TO WATER OUTLET PIPE ON ENGINE</b>	AE.15	1	<b>FOR USE WITH RADIATOR C.9616.</b> On Chassis No. : 800037 and subs. 811424 and subs. 804142 and subs. 814241 and subs. 807128 and subs. 817460 and subs.
C.2905/4	<b>Clip (Cheney 2A) securing Hose to Radiator and Outlet Pipe</b>	AE.16	2	
C.7545	<b>HOSE FROM BOTTOM OF RADIATOR TO BOTTOM WATER PIPE</b>	AE.17	1	
C.2905/4	<b>Clip, securing Hose to Radiator and Bottom Water Pipe</b>	AE.18	2	
C.7547	<b>WATER PIPE BETWEEN BOTTOM HOSES</b>	AE.19	1	
C.8025 C.8026 C.8027 NS.125/5D NN.125/L C.724	<b>Clip, securing Water Pipe to Chassis Frame</b> <b>Clip, securing Water Pipe to Chassis Frame</b> <b>Packing (Rubber) between Clips and Water Pipe</b> <b>Screw, Set, securing Clips to Chassis Frame</b> <b>Nut on Setscrews</b> <b>Washer, Shakeproof, under Nuts</b>	AE.20 AE.21 AE.22	1 1 2 4 4 4	

# CHASSIS

Part No.	Description	Plate No.	No. per Unit	Remarks
C.980	<b>DRAIN TAP FROM RADIATOR IN BOTTOM WATER PIPE</b>	AE.23	1	
C.981	Washer (Fibre) on Drain Tap	AE.24	2	
C.7546	<b>HOSE BETWEEN BOTTOM WATER PIPE AND WATER PUMP</b>	AE.25	1	
C.2905/4	Clip, securing Hose to Bottom Water Pipe and Pump	AE.26	2	
C.8618	<b>SHIELD, PROTECTING BOTTOM HOSES AND WATER PIPE</b>	AE.27	1	
NS.125/4D	Screw, Set, securing Shield		5	
FW.104/T	Washer, Plain, on Setscrews		5	
C.724	Washer, Shakeproof, on Setscrews		5	
C.8007	<b>FRONT SHOCK ABSORBER (GIRLING CDR.5/20NF)</b>	AE.28	2	
C.3273	Bush, Conical (Rubber) in eyes of Front Shock Absorbers	AE.29	8	
FW.110/T	Washer, Plain, at each side of Conical Bushes, for bottom fixing of Front Shock Absorbers		4	
L.104/10U	Pin, Split, retaining Front Shock Absorbers to Lower Rear Wishbone Pin		2	
C.4891	Bolt, securing Front Shock Absorbers to Suspension Bracket		2	
NN.443/L	Nut on Bolts		2	
L.103/7U	Pin, Split, securing Nut		2	
C.3036	<b>BUMP STOP AT BOTTOM OF FRONT SUSPENSION BRACKET</b>	AE.30	2	
NB.125/5D	Bolt, securing Bump Stop		4	
NN.125/L	Nut on Bolts		4	
FG.104/X	Washer, Spring, under Nuts		4	

# CHASSIS

Part No.	Description	Plate No.	No. per Unit	Remarks
C.8286	<b>BRACKET ASSEMBLY, ON LOWER WISHBONE LEVER, FOR FRONT BUMP STOP</b>	AE.31	2	
NB.131/14D	<b>Bolt</b> , securing Brackets		2	
C.8287	<b>Spacer</b> on Bolts		2	
NN.131/L	<b>Nut</b> on Bolts		2	
C.725	<b>Washer</b> . Shakeproof, under Nuts		2	
C.8008	<b>REAR SHOCK ABSORBER (GIRLING CDR.7/10NF)</b>	AE.32	2	
C.10647	<b>Buffer</b> (Rubber) at top of Shock Absorber	AE.33	4	
C.3273	<b>Bush</b> , Conical (Rubber) in eyes of Rear Shock Absorbers	AE.34	4	
L.104/10U	<b>Pin</b> , Split, retaining Rear Shock Absorbers to Shaft on Road Spring Plate		2	
FW.110/T	<b>Washer</b> , Plain, behind Split Pins		2	
C.3208	<b>REAR BUMP STOP ON BRACKET ON CHASSIS FRAME EXTENSION</b>	AE.35	2	
NB.131/5D	<b>Bolt</b> , securing Rear Bump Stops		4	
NN.131/L	<b>Nut</b> on Bolts		4	
FG.105/X	<b>Washer</b> , Spring, under Nuts		4	
1048/A	<b>RUBBER PLUG IN JACK SOCKETS ON CHASSIS FRAME</b>	AE.36	2	
C.640	<b>SHACKLE, SUSPENDING ROAD SPRINGS AT REAR</b>	AE.37	2	
C.1219	<b>Bush</b> (Metalastic) in Shackles	AE.38	2	
C.611	<b>Washer</b> (Fibre) at each side of Shackles	AE.39	4	
NB.143/23F	<b>Bolt</b> , securing Shackles to Frame	AE.40	2	
C.3651	<b>Tab Washer</b> , locking Bolts	AE.41	2	

# CHASSIS

Part No.	Description	Plate No.	No. per Unit	Remarks
C.5721	<b>REAR ROAD SPRING</b>	AE.42	2	
C.1219	<b>Bush</b> (Metalastic) in each " eye " of Road Springs	AE.43	4	
NB.143/28F	<b>Bolt</b> , securing Road Springs to Shackles and Frame	AE.44	4	
869	<b>Washer</b> (Steel) on Bolts, at each side of Road Spring " eyes "	AE.45	8	
C.1639	<b>Washer</b> (Ferobestos) adjacent to Steel Washers	AE.46	8	
C.3670	<b>Distance Piece</b> between front " eye " of Road Springs and Chassis Frame	AE.47	2	
C.3968/4	<b>Nut</b> , Self-Locking, on Bolts	AE.48	4	
FW.107/T	<b>Washer</b> , Plain, under Nuts	AE.49	4	
C.6676	<b>"U" BOLT (SHORT) SECURING ROAD SPRINGS TO REAR AXLE</b>	AE.50	2	
C.7752	<b>"U" BOLT (LONG) SECURING ROAD SPRINGS TO REAR AXLE</b>	AE.51	2	
NN.150/L	<b>Nut</b> , securing " U " Bolts		8	
NN.250/L	<b>Locknut</b> on " U " Bolts		8	
C.3186	<b>TAPER WEDGE (FIBRE) BETWEEN TOP OF ROAD SPRINGS AND SPRING PADS ON REAR AXLE</b>	AE.52	2	
C.7753	<b>SPRING PLATE ASSEMBLY UNDER R.H. ROAD SPRING</b>		1	
C.7754	<b>SPRING PLATE ASSEMBLY UNDER L.H. ROAD SPRING</b>	AE.53	1	

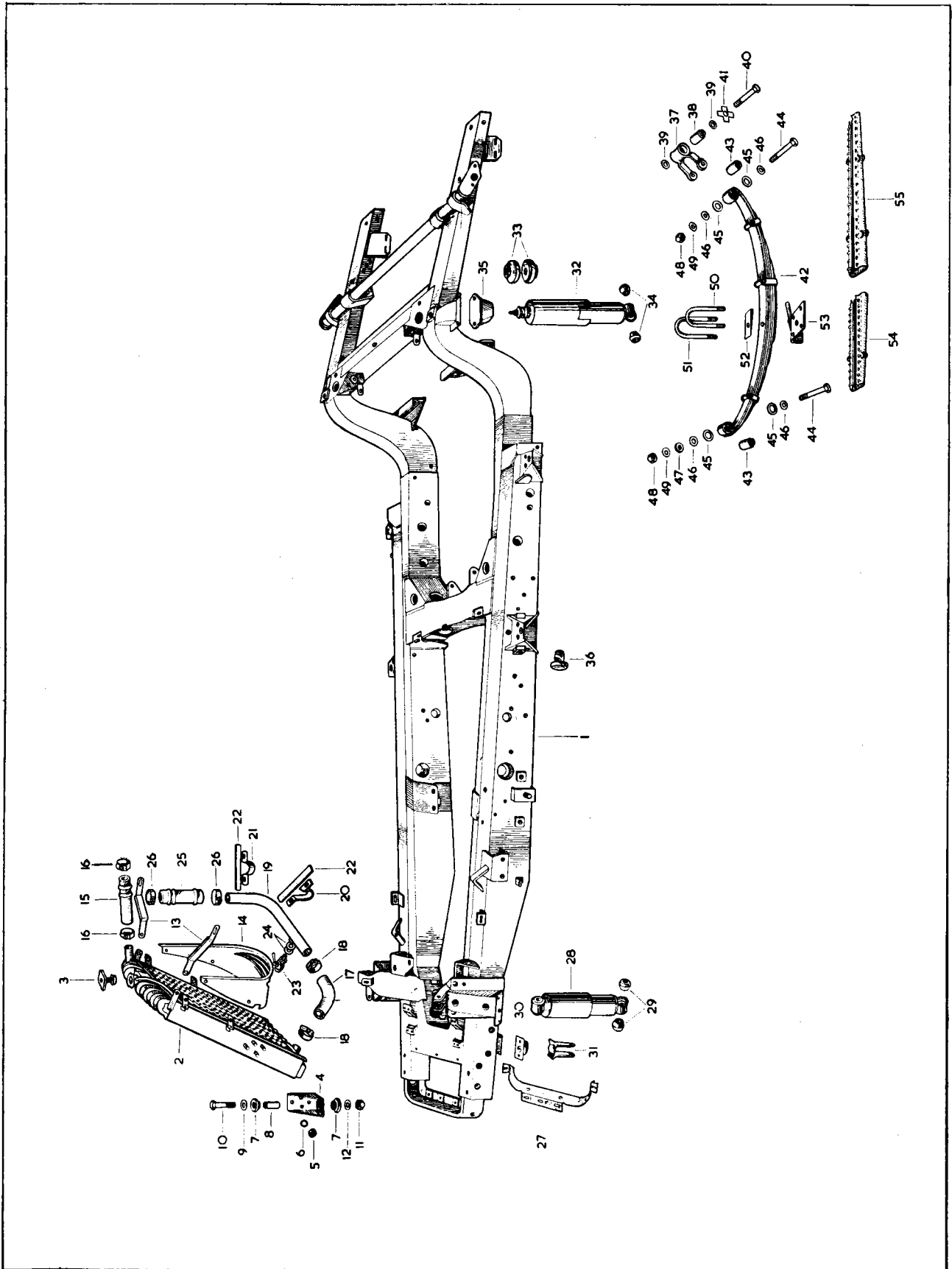

PLATE AE