

# CLUTCH UNIT

## FOR XK 150 FITTED WITH 3.4 LITRE ENGINE

Part No.	Description	Plate No.	No. per Unit	Remarks
C.15819	<b>CLUTCH UNIT, COMPLETE (BB.10/153)</b> <b>(COMPRISING COVER ASSEMBLY AND DRIVEN PLATE ASSEMBLY)</b>	23- 1	1	
C.15820	<b>CLUTCH COVER ASSEMBLY (BB.45696/101)</b>		1	
2546	Cover only (45616)	23- 2	1	
2544	Thrust Spring (Yellow and Light Green) (44780)	23- 3	12	
8097	Pressure Plate (50401)	23- 4	1	
6839	Release Lever (48992)	23- 5	3	
2472	Plate, Release Lever (40968)	23- 6	1	
2395	Retainer, Release Lever (40015)	23- 7	3	
2527	Strut, Release Lever (42606)	23- 8	3	
2588	Eyebolt, Release Lever (48243)	23- 9	3	
2523	Pin, through Eyebolt (42604)	23-10	3	
5086	Nut, on Eyebolt (48132)	23-11	3	
2545	Anti-Rattle Spring (45577)	23-12	3	
6840	<b>RELEASE BEARING ASSEMBLY (BB.48444)</b>		1	
2590	Release Bearing and Cup Assembly (BB.48443)	23-13	1	
4163	Retainer, securing Cup to Clutch Operating Fork (BB.41628)	23-14	2	
C.8401	<b>DRIVEN PLATE ASSEMBLY (BB.47627/46)</b>		1	
2561	Facings Package (consisting of Clutch Linings and Rivets) (BB.46663)		1	<b>FOR RENEWAL OF DRIVEN PLATE LININGS.</b>
C.1782	Dowel, for location of Clutch Unit to Flywheel		2	
NB.137/6.5D FG.106/X	Screw, Set, securing Clutch Unit to Flywheel	23-15	6	
	Washer, Spring, on Setscrews	23-16	6	

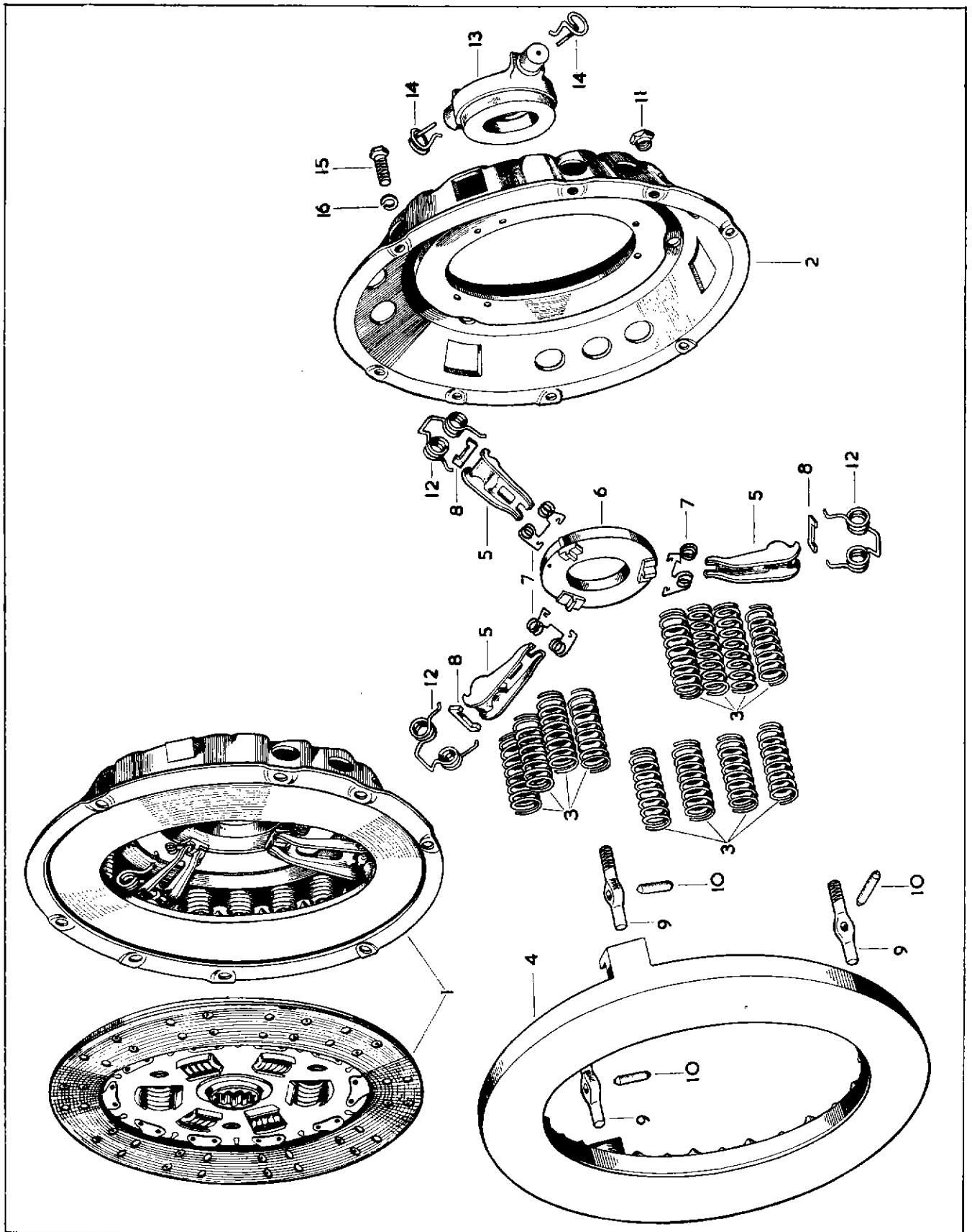

PLATE 23

# CLUTCH UNIT

FOR XK 150 'S' MODELS AND XK 150 FITTED WITH 3.8 LITRE ENGINE

Part No.	Description	Plate No.	No. per Unit	Remarks
C.15821	<b>CLUTCH UNIT, COMPLETE</b> (BB.10/152/A)	24- 1	1	
C.15822	<b>CLUTCH COVER ASSEMBLY</b> (BB.45696/100)		1	
2546	Cover only (45616)	24- 2	1	
4325	Thrust Spring (Black) (44633)	24- 3	12	
8097	Pressure Plate (50401)	24- 4	1	
6839	Release Lever (48992)	24- 5	3	
2472	Plate, Release Lever (40968)	24- 6	1	
2395	Retainer, Release Lever (40015)	24- 7	3	
2527	Strut, Release Lever (42606)	24- 8	3	
2588	Eyebolt, Release Lever (48243)	24- 9	3	
2523	Pin, through Eyebolt (42604)	24-10	3	
5086	Nut, on Eyebolt (48132)	24-11	3	
2545	Anti-Rattle Spring (45577)	24-12	3	
6840	<b>RELEASE BEARING ASSEMBLY (48444)</b>		1	
2590	Release Bearing and Cup (48443)	24-13	1	
4163	Retainer securing Cup to Clutch Operating Fork (41628)	24-14	2	
7643	<b>DRIVEN PLATE ASSEMBLY (47627/90)</b>		1	
2561	Facings Package (consisting of Clutch Linings and Rivets) (46663)		1	<b>FOR RENEWAL OF DRIVEN PLATE LININGS.</b>
C.1782	Dowel for location of Clutch Unit to Flywheel		2	
NB.137/6.5D	Screw, Ser. securing Clutch Unit to Flywheel	24-15	6	
FG.106/X	Washer, Spring, on Setscrews	24-16	6	

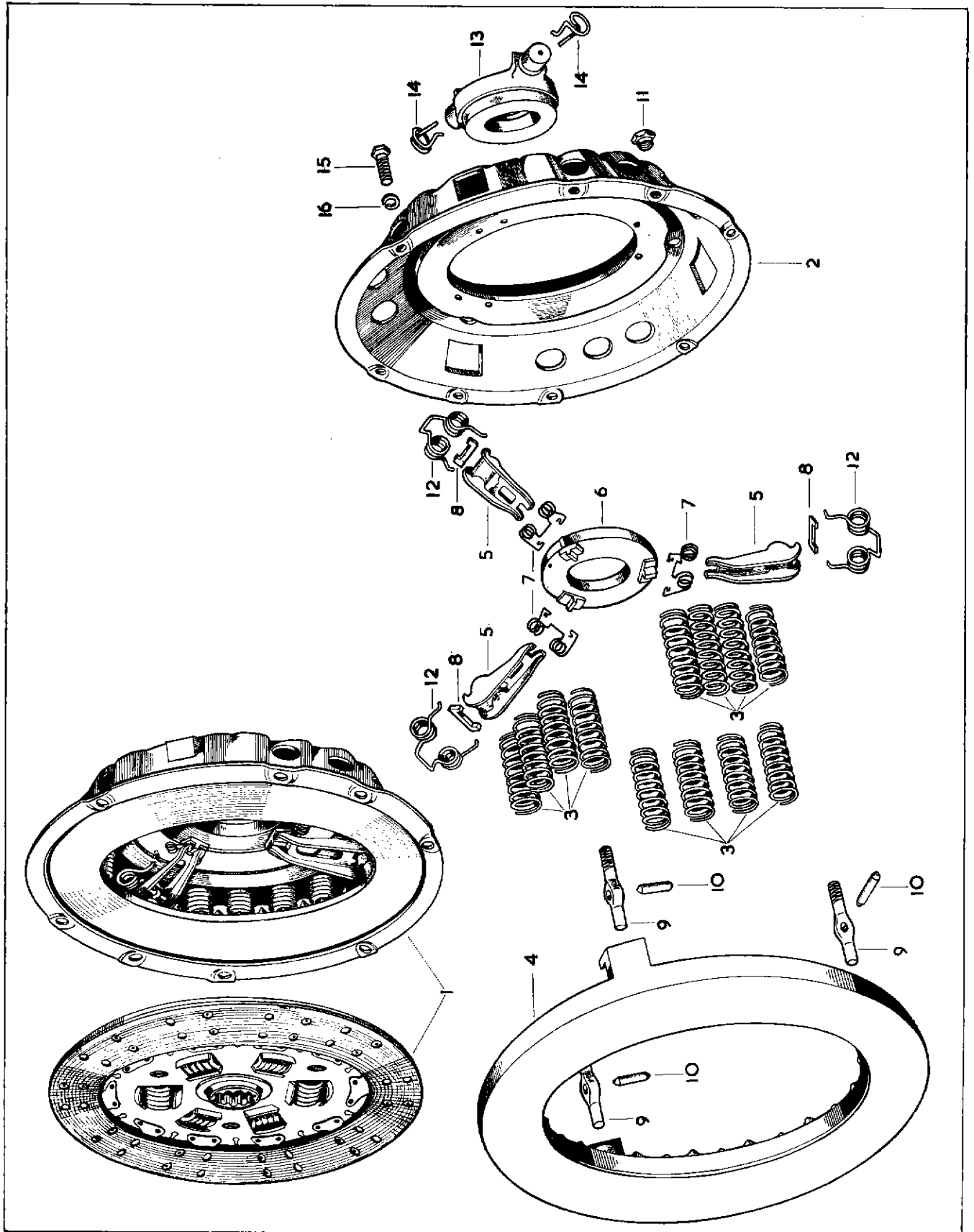

PLATE 24

# CLUTCH CONTROLS

Part No.	Description	Plate No.	No. per Unit	Remarks
C.5068	<b>CLUTCH HOUSING</b>	25- 1	1	
C.584	<b>Bush, in Clutch Housing, for Operating Shaft</b>	25- 2	2	
FS.107/13D	<b>Screw, Set, securing Clutch Housing to Gearbox</b>		8	
C.5073	<b>Plate, locking Setscrews inside Clutch Housing</b>	25- 3	2	
C.587	<b>Plate, locking Setscrews inside Clutch Housing</b>	25- 4	2	
NB.137/23D	<b>Bolt, securing Clutch Housing to Cylinder Block</b>		9	
C.726	<b>Washer, Shakeproof, on Bolts</b>		9	
C.1221/1	<b>Split Pin, in Drain Hole at bottom of Clutch Housing</b>		1	
C.5072	<b>COVER PLATE FOR CLUTCH HOUSING</b>	25- 5	1	
CS.125/4D	<b>Screw, Set, securing Cover Plate</b>		4	
C.724	<b>Washer, Shakeproof, on Setscrews</b>		4	
C.4795	<b>SUPPORT BRACKET, L.H.</b>	25- 6	1	
C.4796	<b>SUPPORT BRACKET, R.H.</b>	25- 7	1	
NB.131/10D	<b>Bolt, securing Support Brackets to Cylinder Block</b>		4	
NN.131/L	<b>Nut, on Bolts</b>		4	
FG.105/X	<b>Washer, Spring, under Nuts</b>		4	
UFB.137/26D	<b>Bolt, securing Support Brackets to Cylinder Block</b>		6	
UFN.131/L	<b>Nut, on Bolts</b>		6	
FG.106/X	<b>Washer, Spring, under Nuts</b>		6	
C.12897	<b>CLUTCH OPERATING SHAFT</b>	25- 8	1	
CB.131/8D	<b>Bolt, for Clutch Shaft location</b>		1	
C.725	<b>Washer, Shakeproof, on Bolt</b>		1	
C.12942	<b>LEVER, ON CLUTCH SHAFT</b>	25- 9	1	
C.1968	<b>Washer, Spring, behind Lever</b>		1	

# CLUTCH CONTROLS

Part No.	Description	Plate No.	No. per Unit	Remarks
C.9780	<b>CLUTCH OPERATING FORK</b>	25-10	1	
C.13055 FG.107/X	<b>Tapered Pin</b> , locating Lever and Fork on Clutch Shaft <b>Washer</b> , Spring, on Pins	25-11 25-12	2 2	
C.13966	<b>CLUTCH PEDAL</b>		1	<b>R.H. DRIVE CARS ONLY</b> Fitted from Chassis No. 827001 to 827212 824001 to 824609
C.13967	<b>CLUTCH PEDAL</b>		1	<b>L.H. DRIVE CARS ONLY</b> Fitted from Chassis No. 830001 to 831142 837001 to 837628 834001 to 835717
C.14173	<b>CLUTCH PEDAL ASSEMBLY</b>	25-13	1	<b>R.H. DRIVE CARS ONLY</b> Fitted to Chassis No. 820001 and subs. 827213 and subs. 824610 and subs. and all "S" type Cars
C.14172	<b>CLUTCH PEDAL ASSEMBLY</b>		1	<b>L.H. DRIVE CARS ONLY</b> Fitted to Chassis No. 831143 and subs. 837629 and subs. 835718 and subs. and all "S" type Cars
C.3223	<b>Roller Bearing</b> inside Clutch Pedal Boss	25-14	1	
C.3224	<b>Sleeve</b> for Roller Bearing	25-15	1	
C.13877	<b>Grease Nipple</b> , for Pedal Boss (Tec NA.6626)	25-16	1	
C.3317	<b>Return Spring</b> , for Clutch Pedal	25-17	1	
C.8865	<b>STEM AND PLATE ASSEMBLY FOR CLUTCH PEDAL</b>	25-18	1	
UFB.131/10R	<b>Bolt</b> , securing Stem to Pedal		1	
UFN.131/L	<b>Nut</b> , on Bolt		1	
C.740	<b>Washer</b> , Shakeproof, under Nut		1	

# CLUTCH CONTROLS

Part No.	Description	Plate No.	No. per Unit	Remarks
C.9934	<b>RUBBER PAD ON CLUTCH PEDAL</b>	25-19	1	
C.12967	<b>SHAFT FOR CLUTCH PEDAL</b>	25-20	1	
C.12969	Spacer, between Brake and Clutch Pedals	25-21	1	
C.13061	Lockwasher, securing Pedal Shaft to Tie Plate	25-22	1	
UFS.131/12R	Stopscrew, for Clutch Pedal	25-23	1	
UFN.231/L	Nut, locking Stopscrew	25-24	1	
C.8299	<b>FELT SEAL ON CLUTCH PEDAL STEM</b>	25-25	1	
C.8301	Circlip, retaining Felt Seal	25-26	1	
C.12968	<b>FORK END, CONNECTING CLUTCH PEDAL TO MASTER CYLINDER PUSH ROD</b>	25-27	1	
UFN.131/L	Nut, locking Fork End in adjustment	25-28	1	
J.106/17S	Clevis Pin, securing Fork End to Clutch Pedal	25-29	1	
L.103/7U	Split Pin, retaining Clevis Pin		1	
FW.106/T	Washer, Plain, under Split Pin		1	
C.14177	<b>BELL CRANK LEVER ASSEMBLY FOR QUICK RETURN OF CLUTCH PEDAL</b>	25-30	1	
C.14196	<b>SPRING, TENSIONING BELL CRANK LEVER</b>	25-31	2	
J.106/13S	Clevis Pin, securing Bell Crank Lever to Clutch Pedal Extension	25-32	1	
L.103/7U	Split Pin, retaining Clevis Pin		1	
FW.106/T	Washer, Plain, under Split Pin		1	
C.14180	Anchor Bolt Assembly, for adjustment of Spring Tension	25-33	1	
NN.131/L	Nut, securing Anchor Bolt		1	
C.740	Washer, Shakeproof, under Nut		1	
FW.105/T	Washer, Plain, under Shakeproof Washer		1	

Fitted to Chassis No.  
 820001 and subs.  
 831143 and subs.  
 827213 and subs.  
 837629 and subs.  
 824610 and subs.  
 835718 and subs.  
 and all "S" type cars

# CLUTCH CONTROLS

Part No.	Description	Plate No.	No. per Unit	Remarks
C.12943	<b>CLUTCH MASTER CYLINDER ASSEMBLY (3110241/W)</b>	25-34	1	
7342	Body only (310361/W)	25-35	1	
7350	Valve Stem (378641)	25-36	1	
7345	Valve Seal (362801)	25-37	1	
7748	Spring Washer on Valve Stem (378960)	25-38	1	
7349	Valve Spacer (318001)	25-39	1	
7010	Spring (378847)	25-40	1	
7351	Spring Abutment (378111)	25-41	1	
7346	Taper Seal (362433)	25-42	1	
7343	Plunger (371511)	25-43	1	
7344	Seal on Plunger (362432)	25-44	1	
7011	Push Rod (350541/W)	25-45	1	
7352	Retaining Washer (378230)	25-46	1	
1619	Circlip (378920)	25-47	1	
7347	Dust Cover (363509)	25-48	1	
7348	Retaining Band (363000)	25-49	1	
8384	Clip securing Dust Cover to Push Rod (378312)	25-50	1	
UFB.131/8R	Bolt, securing Master Cylinder to Bracket on Chassis Frame		2	
UFN.131/L	Nut, on Bolts		2	
C.740	Washer, Shakeproof, under Nuts		2	
7012	<b>REPAIR KIT FOR CLUTCH MASTER CYLINDER (SP 1971)</b>		1	
C.5167	<b>CLUTCH FLUID SUPPLY TANK (LESS CLIP) (3000527)</b>	25-51	1	
1578	Cap, for Supply Tank (378430)	25-52	1	
1193	Washer, Inside Cap (H.1570)	25-53	1	
C.5173	Clip, for mounting of Supply Tank	25-54	1	
UFS.319/8H	Screw, Set, securing Clip to Supply Tank		1	
UFN.119/L	Nut, on Setscrew		1	
C.13664	<b>MOUNTING BRACKET ASSEMBLY FOR CLUTCH (AND BRAKE) FLUID SUPPLY TANKS</b>	25-55	1	
UFS.125/SR	Screw, Set, securing Mounting Bracket to Wing Valance		4	} FOR R.H. DRIVE CARS EQUIPPED WITH TWIN CARBURETTERS.
UFN.125/L	Nut, on Setscrews		4	
C.724	Washer, Shakeproof, under Nuts		4	
UFS.125/SR	Screw, Set, securing Supply Tank Clip to Bracket		1	
C.724	Washer, Shakeproof, on Setscrews		1	



# CLUTCH CONTROLS

Part No.	Description	Plate No.	No. per Unit	Remarks
C.14837	<b>MOUNTING BRACKET ASSEMBLY FOR CLUTCH (AND BRAKE) FLUID SUPPLY TANKS</b>	25-56	1	} <b>FOR R.H. DRIVE "S" TYPE CARS.</b>
UFS.125/5R	<b>Screw, Set, securing Mounting Bracket to Wing Valance and Supply Tank Clip to Bracket</b>		3	
C.724	<b>Washer, Shakeproof, on Setscrews</b>		3	
C.5181	<b>DISTANCE PIECE AT MOUNTING OF CLUTCH FLUID SUPPLY TANKS</b>		1	} <b>L.H. DRIVE CARS ONLY.</b>
UFS.125/9R	<b>Screw, Set, securing Supply Tank Clip to L.H. Wing Valance</b>		1	
UFN.125/L	<b>Nut, on Setscrew</b>		1	
C.724	<b>Washer, Shakeproof, under Nut</b>		1	
C.13239	<b>PIPE FROM SUPPLY TANK TO LOW PRESSURE HOSE</b>	25-57	1	} <b>NOT REQUIRED FOR R.H. DRIVE "S" TYPE CARS.</b>
C.13240	<b>PIPE FROM LOW PRESSURE HOSE TO MASTER CYLINDER</b>	25-58	1	
C.6854	<b>HOSE CONNECTING PIPES</b>	25-59	1	
C.8416	<b>Clip, securing Hose</b>	25-60	2	
C.14862	<b>PIPE FROM SUPPLY TANK TO MASTER CYLINDER</b>		1	} <b>FOR R.H. DRIVE "S" TYPE CARS ONLY.</b>
C.13671	<b>PIPE FROM MASTER CYLINDER TO HIGH PRESSURE HOSE</b>	25-61	1	<b>FOR R.H. DRIVE CARS ONLY.</b>

# CLUTCH CONTROLS

Part No.	Description	Plate No.	No. per Unit	Remarks
C.13968	<b>HIGH PRESSURE HOSE (3700819/W)</b>	25-62	1	} <b>R.H. DRIVE CARS ONLY.</b>
C.13684	<b>Bracket, on R.H. Rear Engine Mounting bolt receiving inboard end of Hose</b>	25-63	1	
UFN.237/L	<b>Nut, securing Hose to Bracket on Chassis Frame and on Engine Mounting bolt</b>		2	
C.726	<b>Washer, Shakeproof, under Nuts</b>		2	
C.13683	<b>PIPE, FROM HIGH PRESSURE HOSE TO CLUTCH SLAVE CYLINDER (3401930/W)</b>	25-64	1	
C.13241	<b>PIPE FROM MASTER CYLINDER TO HIGH PRESSURE HOSE</b>	25-65	1	<b>FOR L.H. DRIVE CARS ONLY.</b>
C.13259	<b>HIGH PRESSURE HOSE (3700816/W)</b>	25-66	1	} <b>L.H. DRIVE CARS ONLY.</b>
C.13223	<b>Bracket, receiving inboard end of High Pressure Hose</b>	25-67	1	
UFB.125/4R	<b>Bolt, securing Bracket to L.H. rear Engine Mounting Bracket</b>		2	
UFN.125/L	<b>Nut, on Bolts</b>		2	
FG.104/X	<b>Washer, Spring, under Nuts</b>		2	
UFN.237/L	<b>Nut, securing Hose to Brackets on Chassis Frame and L.H. rear Engine Mounting</b>		2	
C.726	<b>Washer, Shakeproof, under Nuts</b>		2	
C.13243	<b>PIPE FROM HOSE TO CLUTCH SLAVE CYLINDER</b>	25-68	1	
C.1040/29	<b>Clip, securing Pipe at top of Clutch Housing</b>	25-69	1	
UCS.119/4R	<b>Screw, Set, securing Clip</b>		1	
C.723/A	<b>Washer, Shakeproof, on Setscrew</b>		1	
C.11674	<b>Clip, on Starter Motor lower Mounting Bolt, securing Pipe</b>	25-70	1	

# CLUTCH CONTROLS

Part No.	Description	Plate No.	No. per Unit	Remarks
C.5165	<b>CLUTCH SLAVE CYLINDER ASSEMBLY (3010223/W)</b>	25-71	1	
1790	Body only (313301/W)	25-72	1	
6175	Bleed Screw (377685/W)	25-73	1	
1891	Ball, under Bleed Screw (27240)	25-74	1	
1675	Dust Cover, on Bleed Screw (363400)	25-75	1	
1100	Seal (64673020)	25-76	1	
1609	Piston (370820)	25-77	1	
1743	Boot (363603)	25-78	1	
5856	Push Rod (351311/W)	25-79	1	
268	Nut, on Push Rod (30-BS-76)	25-80	1	
C.7765	Retainer, under Rubber Boot, for Slave Cylinder Piston	25-81	1	
C.5180	Trunnion, on Push Rod	25-82	1	
C.2424	Spring, tensioning Adjusting Nut	25-83	1	
FW.204/T	Washer, behind Spring	25-84	1	
L.103/7U	Split Pin, retaining Washer	25-85	1	
C.5179	Pin, in Trunnion, anchoring Return Spring	25-86	1	
C.3266	Barrel Nut, on Slave Cylinder Push Rod, for Clutch Pedal adjustment	25-87	1	
C.5120	Return Spring, between Trunnion and Mounting Bracket	25-88	1	
C.13234	Anchor Plate, for Return Spring	25-89	1	
NB.131/7D	Bolt, securing Slave Cylinder to Mounting Bracket		2	
NN.131/L	Nut, on Bolts		2	
C.725	Washer, Shakeproof, under Nuts		2	
NB.125/6D	Bolt, securing Slave Cylinder to Mounting Bracket		1	
NN.125/L	Nut, on Bolt		1	
C.724	Washer, Shakeproof, under Nut		1	
C.15709	<b>BRACKET ASSEMBLY FOR MOUNTING OF CLUTCH SLAVE CYLINDER</b>	25-90	1	
CS.131/6D	Screw, Set, securing Bracket to Clutch Housing		2	
C.725	Washer, Shakeproof, on Setscrews		2	
1304	<b>REPAIR KIT FOR CLUTCH SLAVE CYLINDER (SP 2005)</b>		1	

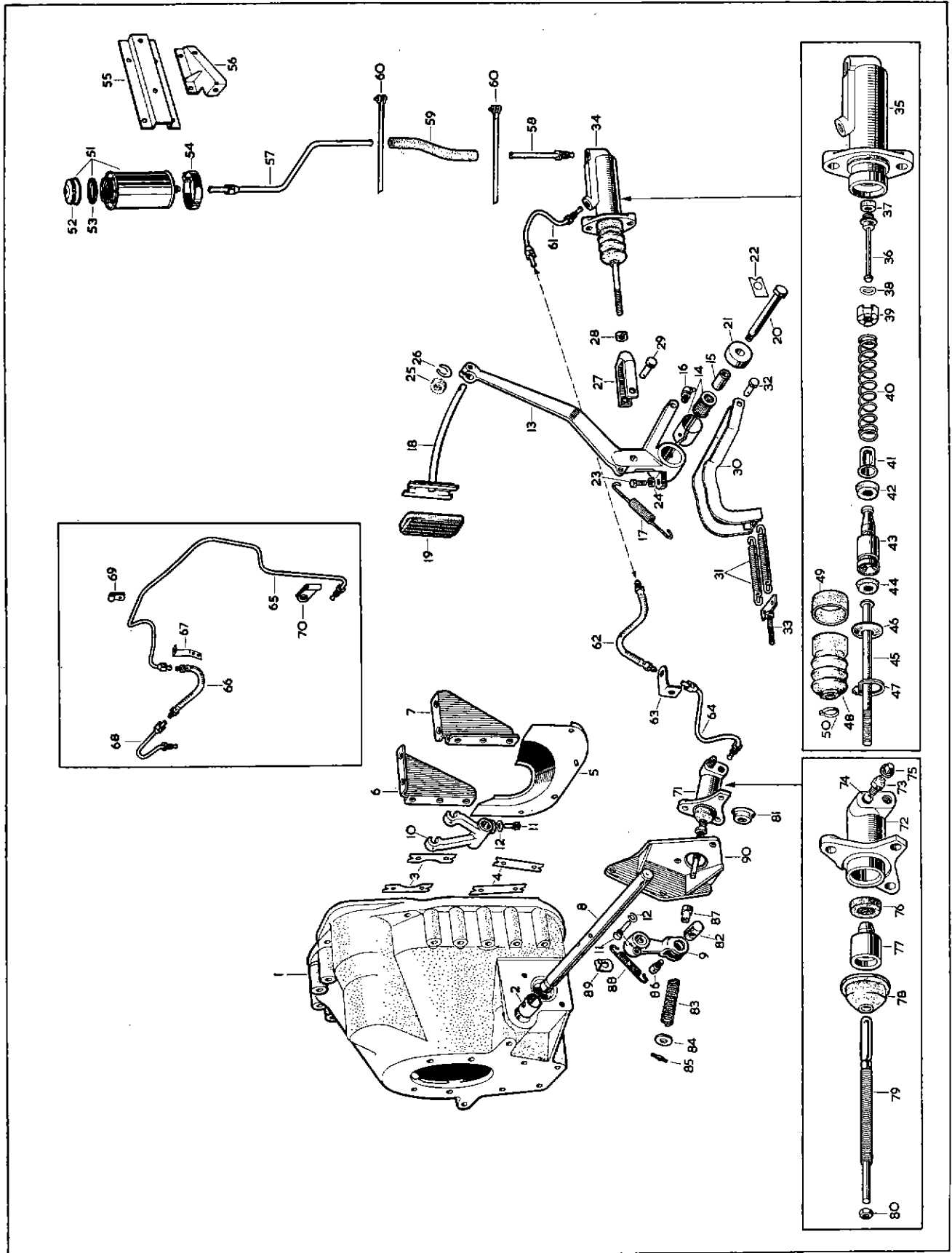

PLATE 25